

DUBAI CREEK  
HARBOUR

BREEZE AT  
CREEK BEACH

BUILDING 2

GROUND LEVEL

UNIT G01

1 BEDROOM

APARTMENT AREA	56.24 SQ.M.	605.36 SQ.FT.
BALCONY AREA	57.28 SQ.M.	616.56 SQ.FT.
TOTAL AREA	113.52 SQ.M.	1221.92 SQ.FT.

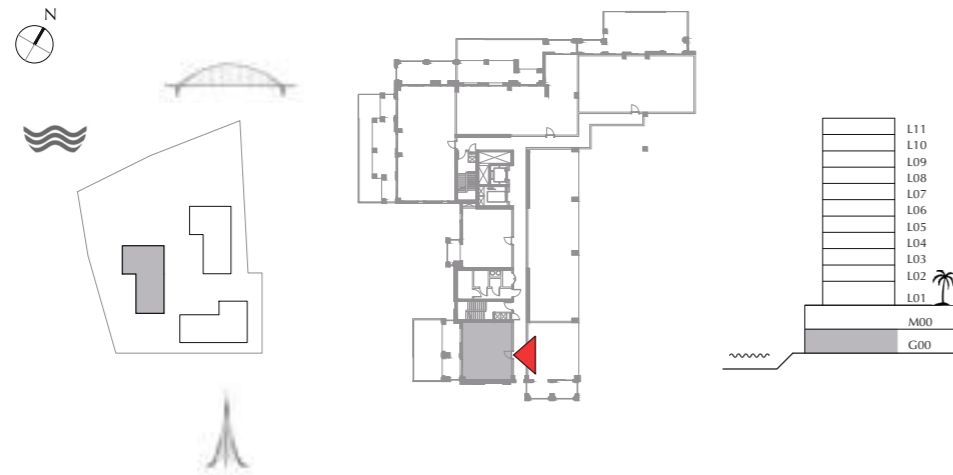

FLOOR PLAN 1. All dimensions are in imperial and metric, and measured from finish to finish excluding construction tolerances. 2. All materials, dimensions, and drawings are approximate only. 3. Information is subject to change without notice, at developer's absolute discretion. 4. Actual area may vary from the stated area. 5. Drawings not to scale. 6. All images used are for illustrative purpose only and do not represent the actual size, features, specifications, fittings, and furnishings. 7. The developer reserves the right to make revisions / alterations, at its absolute discretion, without any liability whatsoever.

DUBAI CREEK  
HARBOUR

BREEZE AT  
CREEK BEACH

BUILDING 2

GROUND LEVEL

UNIT G02

1 BEDROOM

APARTMENT AREA	55.04 SQ.M.	592.45 SQ.FT.
BALCONY AREA	18.17 SQ.M.	195.58 SQ.FT.
TOTAL AREA	73.21 SQ.M.	788.03 SQ.FT.

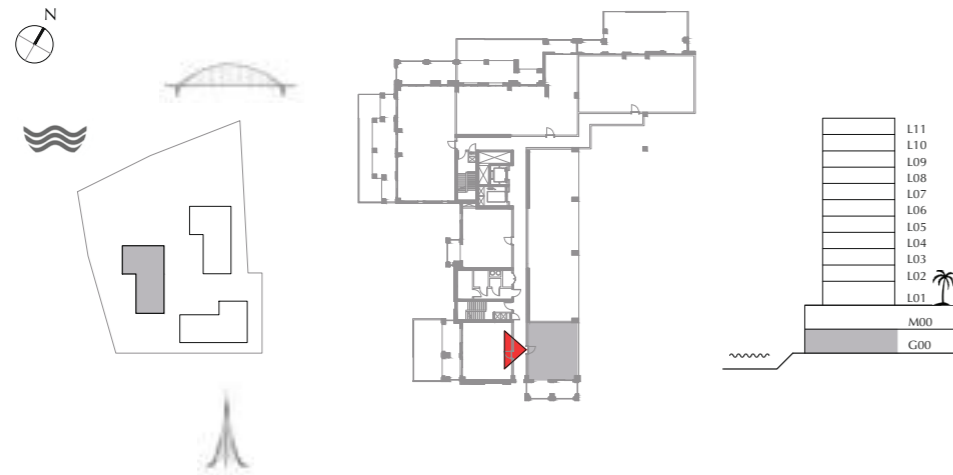

FLOOR PLAN 1. All dimensions are in imperial and metric, and measured from finish to finish excluding construction tolerances. 2. All materials, dimensions, and drawings are approximate only. 3. Information is subject to change without notice, at developer's absolute discretion. 4. Actual area may vary from the stated area. 5. Drawings not to scale. 6. All images used are for illustrative purpose only and do not represent the actual size, features, specifications, fittings, and finishings. 7. The developer reserves the right to make revisions / alterations, at its absolute discretion, without any liability whatsoever.



DUBAI CREEK  
HARBOUR

BREEZE AT  
CREEK BEACH

BUILDING 2

GROUND LEVEL

UNIT G03

3 BEDROOM

APARTMENT AREA	129.79 SQ.M.	1397.05 SQ.FT.
BALCONY AREA	108.74 SQ.M.	1170.47 SQ.FT.
TOTAL AREA	238.53 SQ.M.	2567.52 SQ.FT.

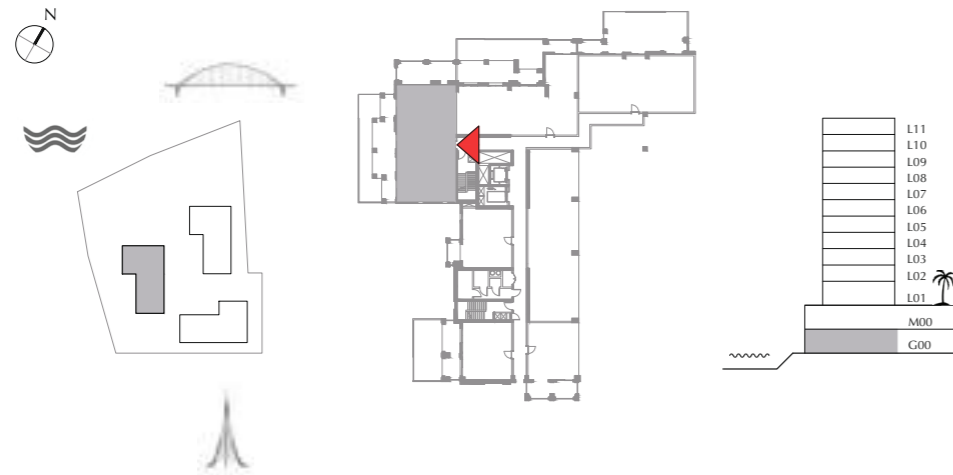

FLOOR PLAN 1. All dimensions are in imperial and metric, and measured from finish to finish excluding construction tolerances. 2. All materials, dimensions, and drawings are approximate only. 3. Information is subject to change without notice, at developer's absolute discretion. 4. Actual area may vary from the stated area. 5. Drawings not to scale. 6. All images used are for illustrative purpose only and do not represent the actual size, features, specifications, fittings, and finishings. 7. The developer reserves the right to make revisions / alterations, at its absolute discretion, without any liability whatsoever.



DUBAI CREEK  
HARBOUR

BREEZE AT  
CREEK BEACH

BUILDING 2

GROUND LEVEL

UNIT G04

3 BEDROOM

APARTMENT AREA	132.4 SQ.M.	1425.14 SQ.FT.
BALCONY AREA	87.77 SQ.M.	944.75 SQ.FT.
TOTAL AREA	220.17 SQ.M.	2369.89 SQ.FT.

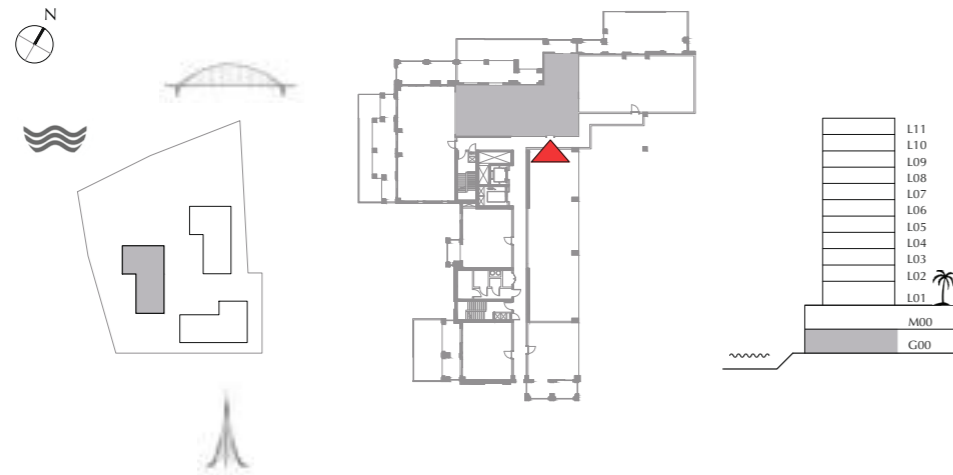

FLOOR PLAN 1. All dimensions are in imperial and metric, and measured from finish to finish excluding construction tolerances. 2. All materials, dimensions, and drawings are approximate only. 3. Information is subject to change without notice, at developer's absolute discretion. 4. Actual area may vary from the stated area. 5. Drawings not to scale. 6. All images used are for illustrative purpose only and do not represent the actual size, features, specifications, fittings, and finishings. 7. The developer reserves the right to make revisions / alterations, at its absolute discretion, without any liability whatsoever.



DUBAI CREEK  
HARBOUR

BREEZE AT  
CREEK BEACH

BUILDING 2

GROUND LEVEL

UNIT G05

3 BEDROOM

APARTMENT AREA	133.47 SQ.M.	1436.66 SQ.FT.
BALCONY AREA	75.13 SQ.M.	808.69 SQ.FT.
TOTAL AREA	208.6 SQ.M.	2245.35 SQ.FT.

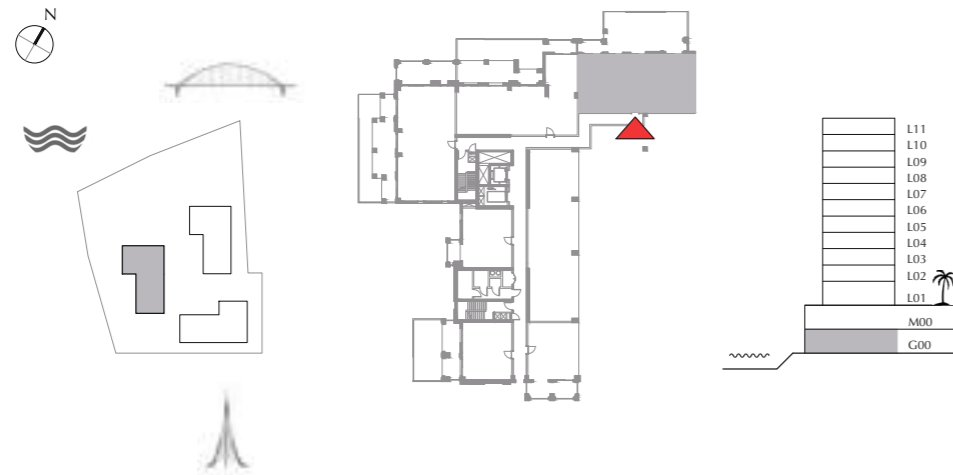

FLOOR PLAN 1. All dimensions are in imperial and metric, and measured from finish to finish excluding construction tolerances. 2. All materials, dimensions, and drawings are approximate only. 3. Information is subject to change without notice, at developer's absolute discretion. 4. Actual area may vary from the stated area. 5. Drawings not to scale. 6. All images used are for illustrative purpose only and do not represent the actual size, features, specifications, fittings, and finishings. 7. The developer reserves the right to make revisions / alterations, at its absolute discretion, without any liability whatsoever.

DUBAI CREEK  
HARBOUR

BREEZE AT  
CREEK BEACH

BUILDING 2  
MEZZANINE LEVEL  
UNIT M01

1 BEDROOM

APARTMENT AREA	56.24 SQ.M.	605.36 SQ.FT.
BALCONY AREA	21.12 SQ.M.	227.33 SQ.FT.
TOTAL AREA	77.36 SQ.M.	832.69 SQ.FT.

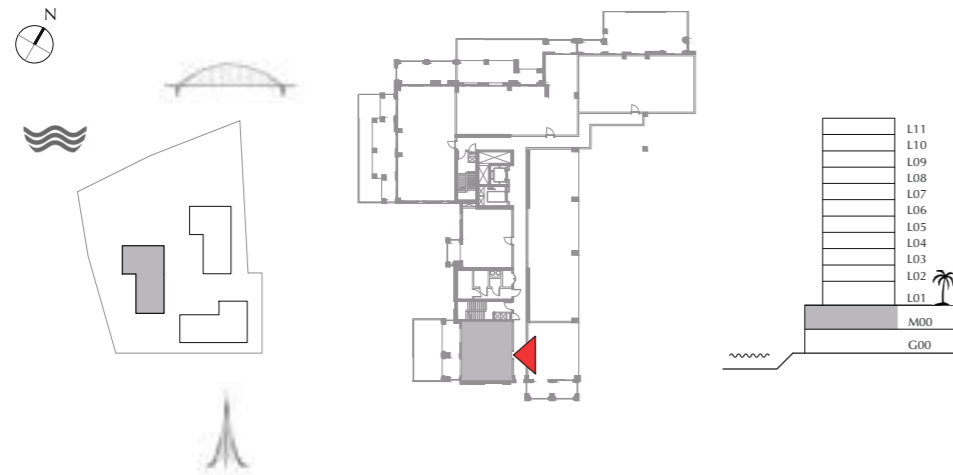

FLOOR PLAN 1. All dimensions are in imperial and metric, and measured from finish to finish excluding construction tolerances. 2. All materials, dimensions, and drawings are approximate only. 3. Information is subject to change without notice, at developer's absolute discretion. 4. Actual area may vary from the stated area. 5. Drawings not to scale. 6. All images used are for illustrative purpose only and do not represent the actual size, features, specifications, fittings, and furnishings. 7. The developer reserves the right to make revisions / alterations, at its absolute discretion, without any liability whatsoever.

DUBAI CREEK  
HARBOUR

BREEZE AT  
CREEK BEACH

BUILDING 2  
MEZZANINE LEVEL  
UNIT M02

1 BEDROOM

APARTMENT AREA	55.04 SQ.M.	592.45 SQ.FT.
BALCONY AREA	18.17 SQ.M.	195.58 SQ.FT.
TOTAL AREA	73.21 SQ.M.	788.03 SQ.FT.

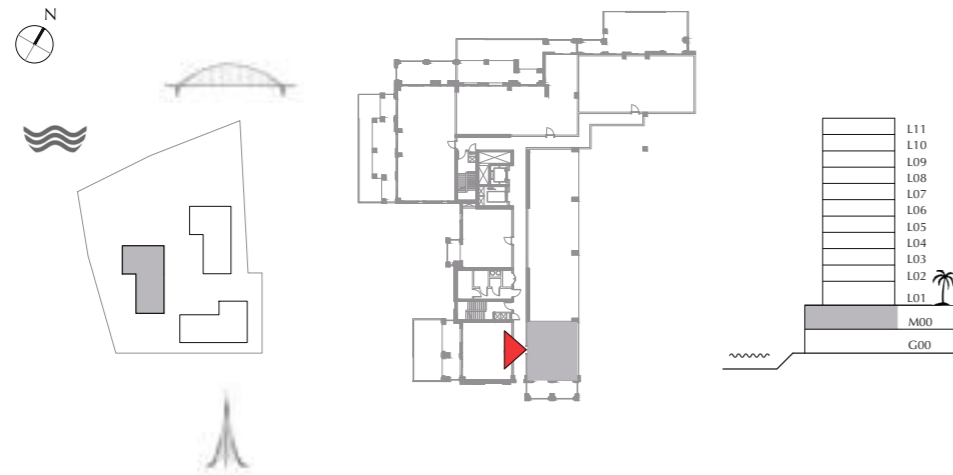

FLOOR PLAN 1. All dimensions are in imperial and metric, and measured from finish to finish excluding construction tolerances. 2. All materials, dimensions, and drawings are approximate only. 3. Information is subject to change without notice, at developer's absolute discretion. 4. Actual area may vary from the stated area. 5. Drawings not to scale. 6. All images used are for illustrative purpose only and do not represent the actual size, features, specifications, fittings, and finishings. 7. The developer reserves the right to make revisions / alterations, at its absolute discretion, without any liability whatsoever.



DUBAI CREEK  
HARBOUR

BREEZE AT  
CREEK BEACH

BUILDING 2  
MEZZANINE LEVEL  
UNIT M03

3 BEDROOM

APARTMENT AREA	129.79 SQ.M.	1397.05 SQ.FT.
BALCONY AREA	66.92 SQ.M.	720.32 SQ.FT.
TOTAL AREA	196.71 SQ.M.	2117.37 SQ.FT.

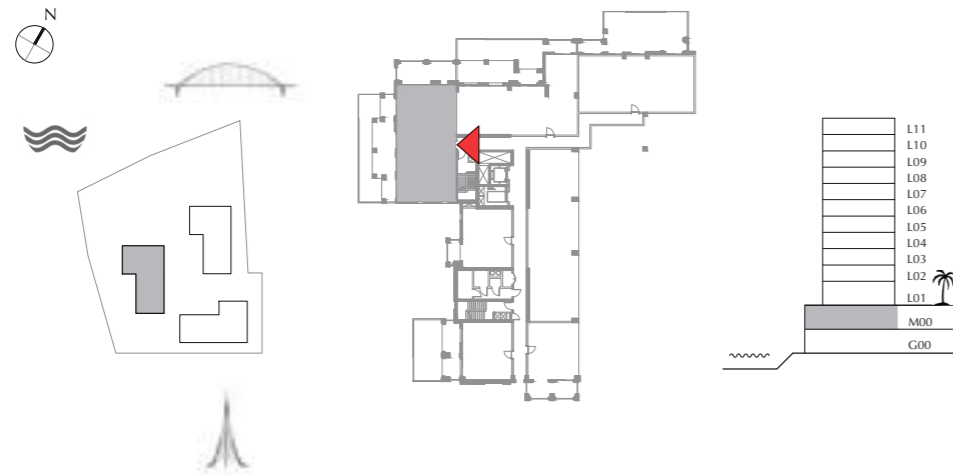

FLOOR PLAN 1. All dimensions are in imperial and metric, and measured from finish to finish excluding construction tolerances. 2. All materials, dimensions, and drawings are approximate only. 3. Information is subject to change without notice, at developer's absolute discretion. 4. Actual area may vary from the stated area. 5. Drawings not to scale. 6. All images used are for illustrative purpose only and do not represent the actual size, features, specifications, fittings, and finishings. 7. The developer reserves the right to make revisions / alterations, at its absolute discretion, without any liability whatsoever.



DUBAI CREEK  
HARBOUR

BREEZE AT  
CREEK BEACH

BUILDING 2  
MEZZANINE LEVEL  
UNIT M04

3 BEDROOM

APARTMENT AREA	132.40 SQ.M.	1425.14 SQ.FT.
BALCONY AREA	45.13 SQ.M.	485.78 SQ.FT.
TOTAL AREA	177.53 SQ.M.	1910.92 SQ.FT.

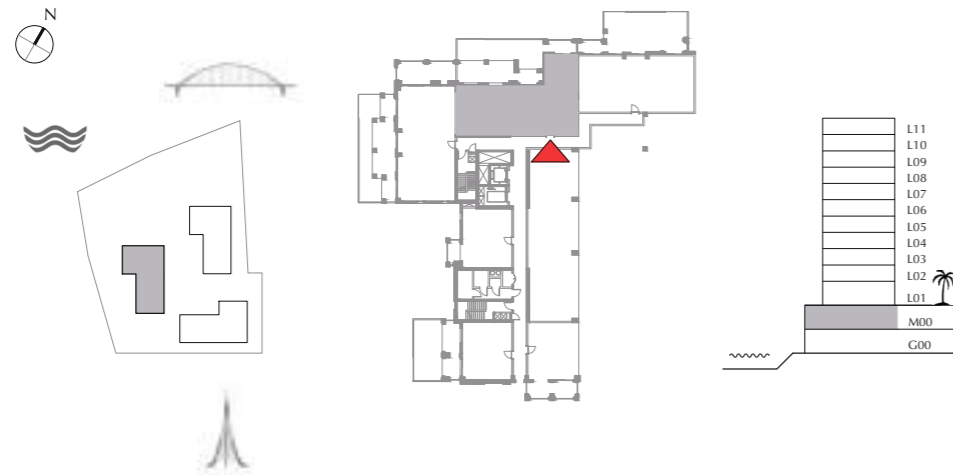

FLOOR PLAN 1. All dimensions are in imperial and metric, and measured from finish to finish excluding construction tolerances. 2. All materials, dimensions, and drawings are approximate only. 3. Information is subject to change without notice, at developer's absolute discretion. 4. Actual area may vary from the stated area. 5. Drawings not to scale. 6. All images used are for illustrative purpose only and do not represent the actual size, features, specifications, fittings, and finishings. 7. The developer reserves the right to make revisions / alterations, at its absolute discretion, without any liability whatsoever.

DUBAI CREEK  
HARBOUR

BREEZE AT  
CREEK BEACH

BUILDING 2  
MEZZANINE LEVEL  
UNIT M05

3 BEDROOM

APARTMENT AREA	133.53 SQ.M.	1437.30 SQ.FT.
BALCONY AREA	39.78 SQ.M.	428.19 SQ.FT.
TOTAL AREA	173.31 SQ.M.	1865.49 SQ.FT.

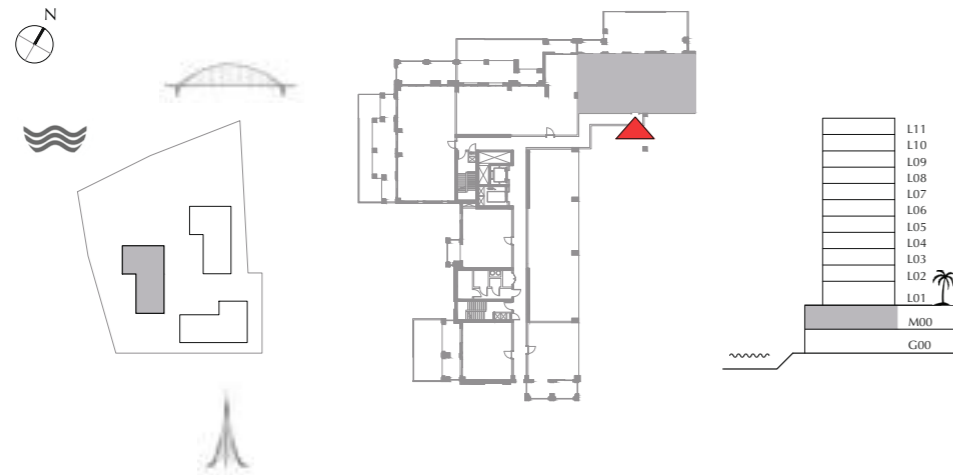

FLOOR PLAN 1. All dimensions are in imperial and metric, and measured from finish to finish excluding construction tolerances. 2.All materials, dimensions, and drawings are approximate only. 3. Information is subject to change without notice, at developer's absolute discretion. 4. Actual area may vary from the stated area. 5. Drawings not to scale. 6. All images used are for illustrative purpose only and do not represent the actual size, features, specifications, fittings, and finishings. 7. The developer reserves the right to make revisions / alterations, at its absolute discretion, without any liability whatsoever.



DUBAI CREEK  
HARBOUR

BREEZE AT  
CREEK BEACH

BUILDING 2  
MEZZANINE LEVEL  
UNIT M06

1 BEDROOM

APARTMENT AREA	58.16 SQ.M.	626.03 SQ.FT.
BALCONY AREA	6.65 SQ.M.	71.58 SQ.FT.
TOTAL AREA	64.81 SQ.M.	697.61SQ.FT.

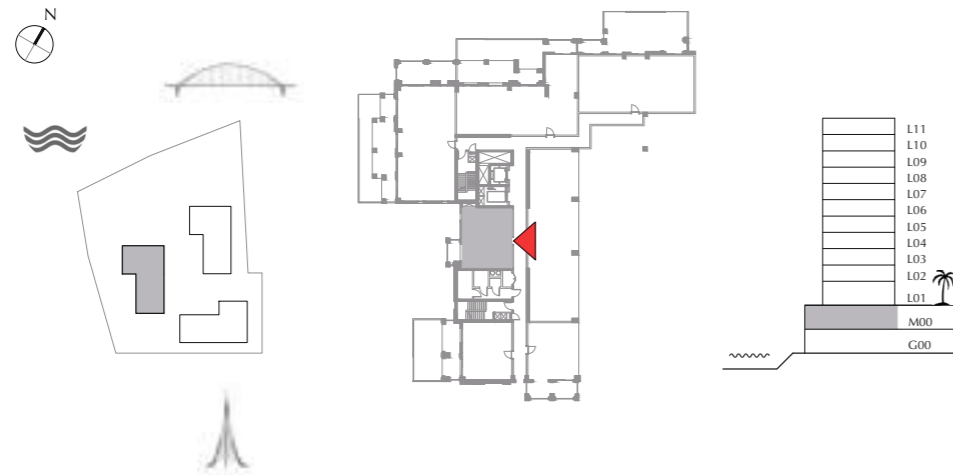

FLOOR PLAN 1. All dimensions are in imperial and metric, and measured from finish to finish excluding construction tolerances. 2.All materials, dimensions, and drawings are approximate only. 3. Information is subject to change without notice, at developer's absolute discretion. 4. Actual area may vary from the stated area. 5. Drawings not to scale. 6. All images used are for illustrative purpose only and do not represent the actual size, features, specifications, fittings, and finishings. 7. The developer reserves the right to make revisions / alterations, at it's a absolute discretion, without any liability whatsoever.



DUBAI CREEK  
HARBOUR

BREEZE AT  
CREEK BEACH

BUILDING 2

LEVEL 1

UNIT 101

1 BEDROOM

APARTMENT AREA	58.56 SQ.M.	630.33 SQ.FT.
BALCONY AREA	6.4 SQ.M.	68.89 SQ.FT.
TOTAL AREA	64.96 SQ.M.	699.22 SQ.FT.

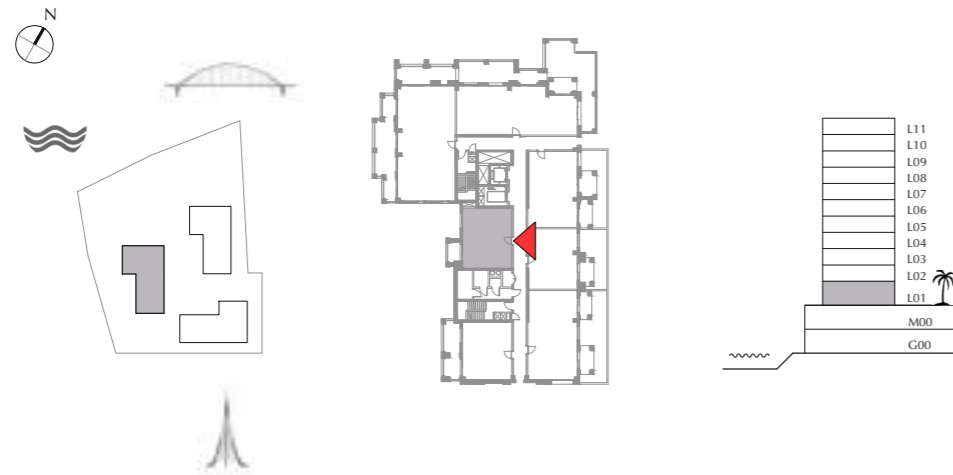

FLOOR PLAN 1. All dimensions are in imperial and metric, and measured from finish to finish excluding construction tolerances. 2. All materials, dimensions, and drawings are approximate only. 3. Information is subject to change without notice, at developer's absolute discretion. 4. Actual area may vary from the stated area. 5. Drawings not to scale. 6. All images used are for illustrative purpose only and do not represent the actual size, features, specifications, fittings, and finishings. 7. The developer reserves the right to make revisions / alterations, at its absolute discretion, without any liability whatsoever.





DUBAI CREEK  
HARBOUR

BREEZE AT  
CREEK BEACH

BUILDING 2

LEVEL 1

UNIT 102

1 BEDROOM

APARTMENT AREA	56.23 SQ.M.	605.25 SQ.FT.
BALCONY AREA	18.96 SQ.M.	204.08 SQ.FT.
TOTAL AREA	75.19 SQ.M.	809.33 SQ.FT.

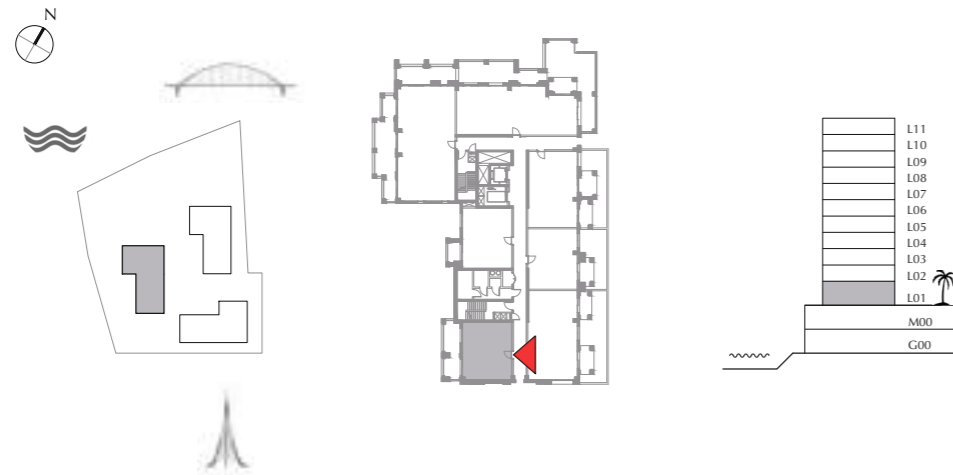

FLOOR PLAN 1. All dimensions are in imperial and metric, and measured from finish to finish excluding construction tolerances. 2. All materials, dimensions, and drawings are approximate only. 3. Information is subject to change without notice, at developer's absolute discretion. 4. Actual area may vary from the stated area. 5. Drawings not to scale. 6. All images used are for illustrative purpose only and do not represent the actual size, features, specifications, fittings, and finishings. 7. The developer reserves the right to make revisions / alterations, at its absolute discretion, without any liability whatsoever.

DUBAI CREEK  
HARBOUR

BREEZE AT  
CREEK BEACH

BUILDING 2

LEVEL 1

UNIT 103

2 BEDROOM

APARTMENT AREA	86.02 SQ.M.	925.91 SQ.FT.
BALCONY AREA	53.45 SQ.M.	575.33 SQ.FT.
TOTAL AREA	139.47 SQ.M.	1501.24 SQ.FT.

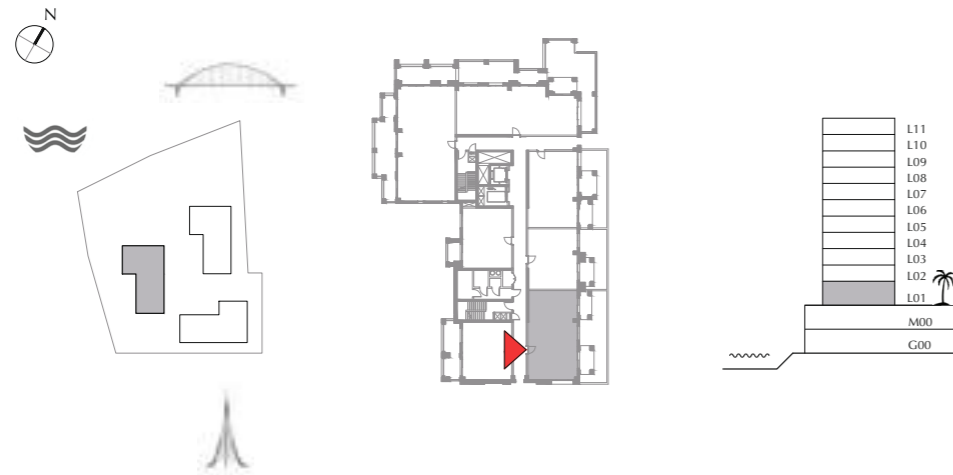

FLOOR PLAN 1. All dimensions are in imperial and metric, and measured from finish to finish excluding construction tolerances. 2. All materials, dimensions, and drawings are approximate only. 3. Information is subject to change without notice, at developer's absolute discretion. 4. Actual area may vary from the stated area. 5. Drawings not to scale. 6. All images used are for illustrative purpose only and do not represent the actual size, features, specifications, fittings, and finishings. 7. The developer reserves the right to make revisions / alterations, at its absolute discretion, without any liability whatsoever.

**DUBAI CREEK**  
HARBOUR

**BREEZE AT**  
CREEK BEACH

BUILDING 2

LEVEL 1

UNIT 104

**1 BEDROOM**

APARTMENT AREA	58.56 SQ.M.	630.33 SQ.FT.
BALCONY AREA	35.27 SQ.M.	379.64 SQ.FT.
TOTAL AREA	93.83 SQ.M.	1009.97 SQ.FT.

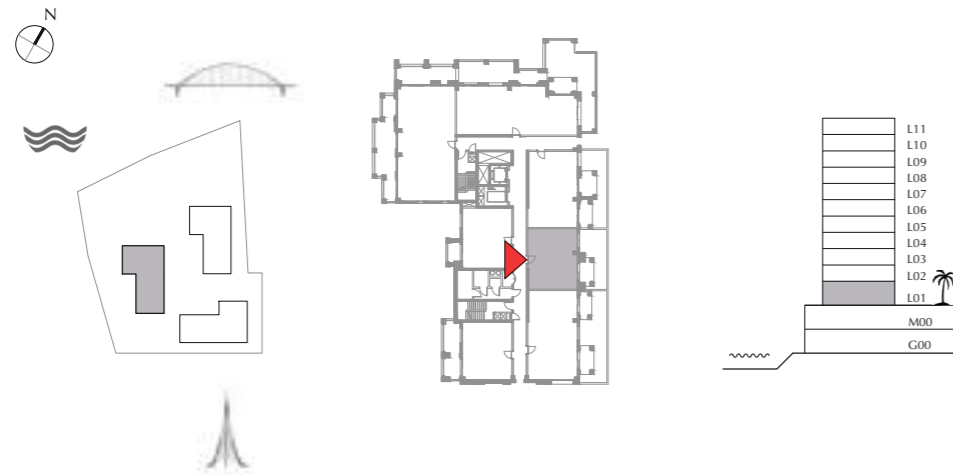

FLOOR PLAN 1. All dimensions are in imperial and metric, and measured from finish to finish excluding construction tolerances. 2. All materials, dimensions, and drawings are approximate only. 3. Information is subject to change without notice, at developer's absolute discretion. 4. Actual area may vary from the stated area. 5. Drawings not to scale. 6. All images used are for illustrative purpose only and do not represent the actual size, features, specifications, fittings, and finishings. 7. The developer reserves the right to make revisions / alterations, at its absolute discretion, without any liability whatsoever.

DUBAI CREEK  
HARBOUR

BREEZE AT  
CREEK BEACH

BUILDING 2

LEVEL 1

UNIT 105

1 BEDROOM

APARTMENT AREA	64.38 SQ.M.	692.98 SQ.FT.
BALCONY AREA	45.26 SQ.M.	487.17 SQ.FT.
TOTAL AREA	109.64 SQ.M.	1180.15 SQ.FT.

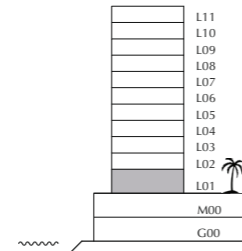
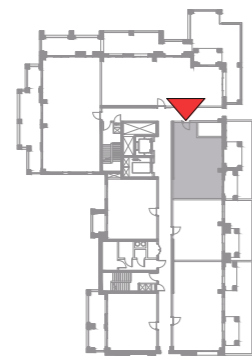
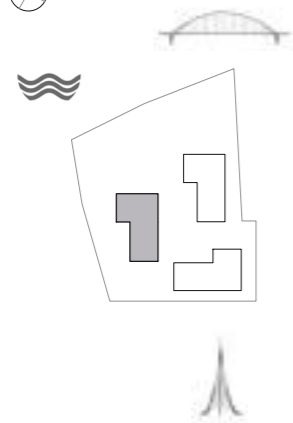

FLOOR PLAN 1. All dimensions are in imperial and metric, and measured from finish to finish excluding construction tolerances. 2. All materials, dimensions, and drawings are approximate only. 3. Information is subject to change without notice, at developer's absolute discretion. 4. Actual area may vary from the stated area. 5. Drawings not to scale. 6. All images used are for illustrative purpose only and do not represent the actual size, features, specifications, fittings, and furnishings. 7. The developer reserves the right to make revisions / alterations, at its absolute discretion, without any liability whatsoever.



DUBAI CREEK  
HARBOUR

BREEZE AT  
CREEK BEACH

BUILDING 2

LEVEL 1

UNIT 106

2 BEDROOM

APARTMENT AREA	111.24 SQ.M.	1197.38 SQ.FT.
BALCONY AREA	93.05 SQ.M.	1001.58 SQ.FT.
TOTAL AREA	204.29 SQ.M.	2198.96 SQ.FT.

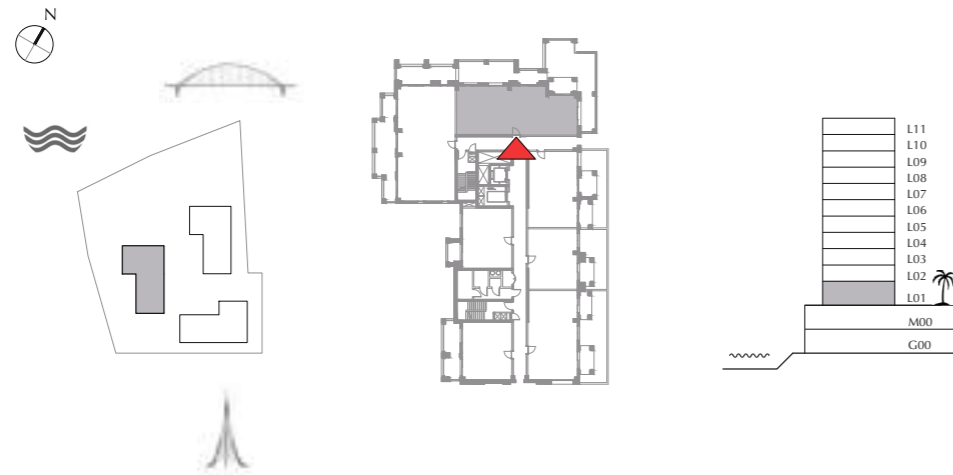

FLOOR PLAN 1. All dimensions are in imperial and metric, and measured from finish to finish excluding construction tolerances. 2. All materials, dimensions, and drawings are approximate only. 3. Information is subject to change without notice, at developer's absolute discretion. 4. Actual area may vary from the stated area. 5. Drawings not to scale. 6. All images used are for illustrative purpose only and do not represent the actual size, features, specifications, fittings, and finishings. 7. The developer reserves the right to make revisions / alterations, at its absolute discretion, without any liability whatsoever.

DUBAI CREEK  
HARBOUR

BREEZE AT  
CREEK BEACH

BUILDING 2

LEVEL 1

UNIT 107

3 BEDROOM

APARTMENT AREA	129.79 SQ.M.	1397.05 SQ.FT.
BALCONY AREA	60.48 SQ.M.	651.00 SQ.FT.
TOTAL AREA	190.27 SQ.M.	2048.05 SQ.FT.

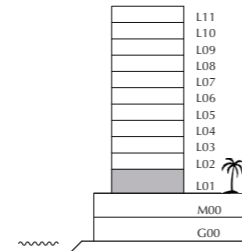
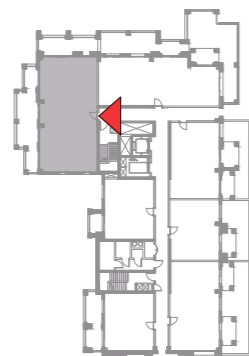
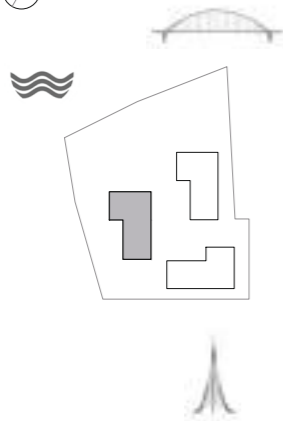

FLOOR PLAN 1. All dimensions are in imperial and metric, and measured from finish to finish excluding construction tolerances. 2. All materials, dimensions, and drawings are approximate only. 3. Information is subject to change without notice, at developer's absolute discretion. 4. Actual area may vary from the stated area. 5. Drawings not to scale. 6. All images used are for illustrative purpose only and do not represent the actual size, features, specifications, fittings, and finishings. 7. The developer reserves the right to make revisions / alterations, at its absolute discretion, without any liability whatsoever.



DUBAI CREEK  
HARBOUR

BREEZE AT  
CREEK BEACH

BUILDING 2

LEVEL 2,3

UNIT 01

1 BEDROOM

APARTMENT AREA	58.69 SQ.M.	631.73 SQ.FT.
BALCONY AREA	6.58 SQ.M.	70.83 SQ.FT.
TOTAL AREA	65.27 SQ.M.	702.56 SQ.FT.

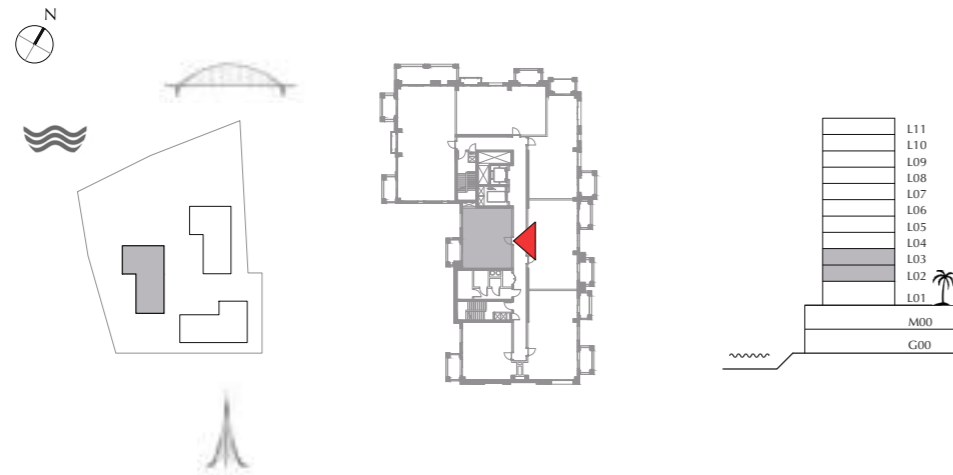

FLOOR PLAN 1. All dimensions are in imperial and metric, and measured from finish to finish excluding construction tolerances. 2. All materials, dimensions, and drawings are approximate only. 3. Information is subject to change without notice, at developer's absolute discretion. 4. Actual area may vary from the stated area. 5. Drawings not to scale. 6. All images used are for illustrative purpose only and do not represent the actual size, features, specifications, fittings, and finishings. 7. The developer reserves the right to make revisions / alterations, at its absolute discretion, without any liability whatsoever.



DUBAI CREEK  
HARBOUR

BREEZE AT  
CREEK BEACH

BUILDING 2

LEVEL 2,3

UNIT 02

1 BEDROOM

APARTMENT AREA	58.27 SQ.M.	627.21 SQ.FT.
BALCONY AREA	6.96 SQ.M.	74.92 SQ.FT.
TOTAL AREA	65.23 SQ.M.	702.13 SQ.FT.

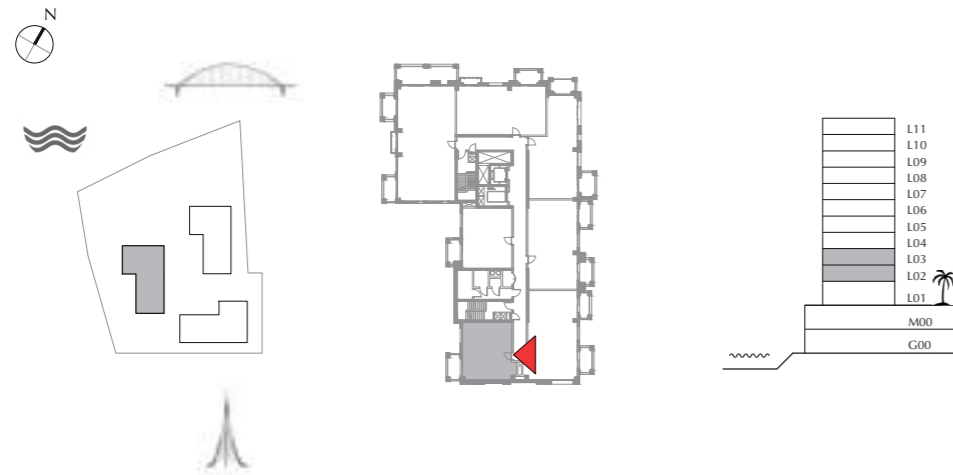

FLOOR PLAN 1. All dimensions are in imperial and metric, and measured from finish to finish excluding construction tolerances. 2. All materials, dimensions, and drawings are approximate only. 3. Information is subject to change without notice, at developer's absolute discretion. 4. Actual area may vary from the stated area. 5. Drawings not to scale. 6. All images used are for illustrative purpose only and do not represent the actual size, features, specifications, fittings, and furnishings. 7. The developer reserves the right to make revisions / alterations, at its absolute discretion, without any liability whatsoever.





DUBAI CREEK  
HARBOUR

BREEZE AT  
CREEK BEACH

BUILDING 2

LEVEL 2,3

UNIT 03

2 BEDROOM

APARTMENT AREA	88.30 SQ.M.	950.45 SQ.FT.
BALCONY AREA	12.66 SQ.M.	136.27 SQ.FT.
TOTAL AREA	100.96 SQ.M.	1086.72 SQ.FT.

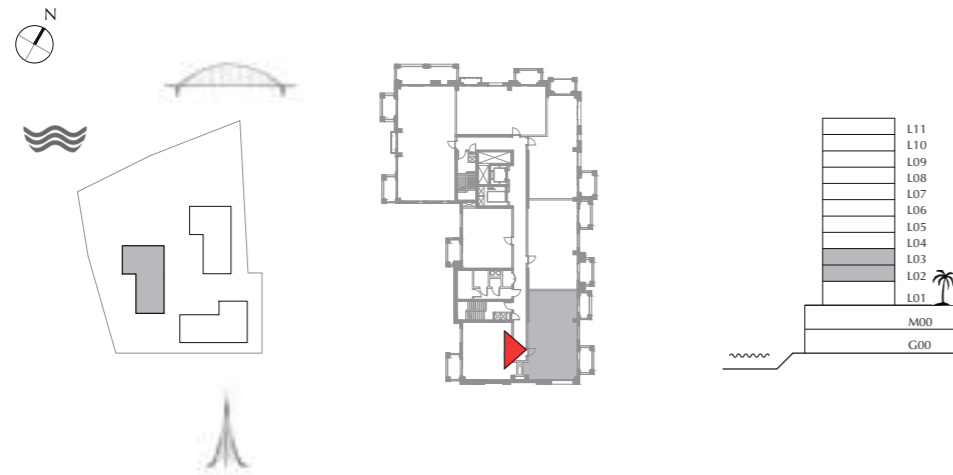

FLOOR PLAN 1. All dimensions are in imperial and metric, and measured from finish to finish excluding construction tolerances. 2. All materials, dimensions, and drawings are approximate only. 3. Information is subject to change without notice, at developer's absolute discretion. 4. Actual area may vary from the stated area. 5. Drawings not to scale. 6. All images used are for illustrative purpose only and do not represent the actual size, features, specifications, fittings, and furnishings. 7. The developer reserves the right to make revisions / alterations, at its absolute discretion, without any liability whatsoever.

DUBAI CREEK  
HARBOUR

BREEZE AT  
CREEK BEACH

BUILDING 2

LEVEL 2,3

UNIT 04

2 BEDROOM

APARTMENT AREA	85.96 SQ.M.	925.27 SQ.FT.
BALCONY AREA	13.50 SQ.M.	145.31 SQ.FT.
TOTAL AREA	99.46 SQ.M.	1070.58 SQ.FT.

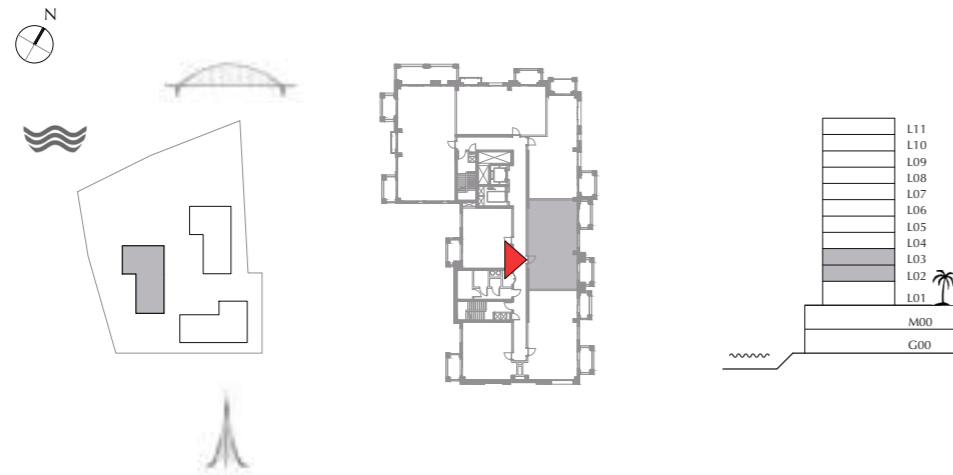

FLOOR PLAN 1. All dimensions are in imperial and metric, and measured from finish to finish excluding construction tolerances. 2. All materials, dimensions, and drawings are approximate only. 3. Information is subject to change without notice, at developer's absolute discretion. 4. Actual area may vary from the stated area. 5. Drawings not to scale. 6. All images used are for illustrative purpose only and do not represent the actual size, features, specifications, fittings, and finishings. 7. The developer reserves the right to make revisions / alterations, at its absolute discretion, without any liability whatsoever.



DUBAI CREEK  
HARBOUR

BREEZE AT  
CREEK BEACH

BUILDING 2

LEVEL 2,3

UNIT 05

2 BEDROOM

APARTMENT AREA	84.46 SQ.M.	909.12 SQ.FT.
BALCONY AREA	15.95 SQ.M.	171.68 SQ.FT.
TOTAL AREA	100.41 SQ.M.	1080.80 SQ.FT.

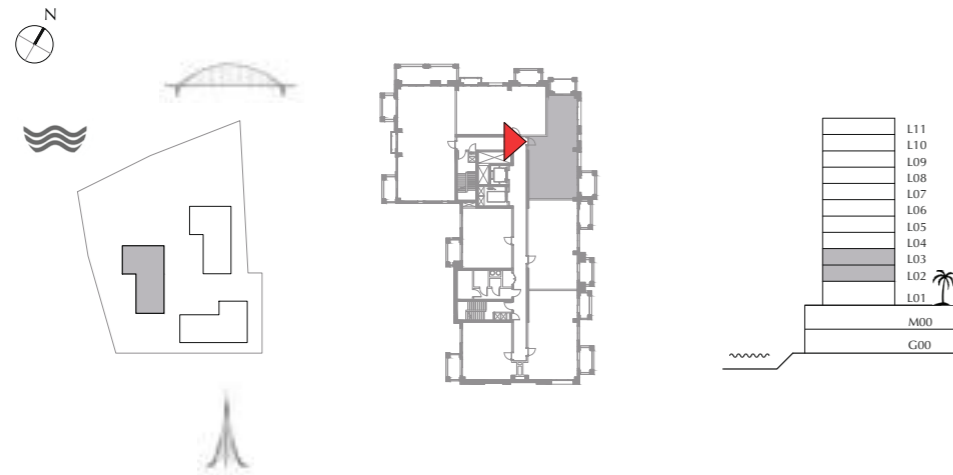

FLOOR PLAN 1. All dimensions are in imperial and metric, and measured from finish to finish excluding construction tolerances. 2. All materials, dimensions, and drawings are approximate only. 3. Information is subject to change without notice, at developer's absolute discretion. 4. Actual area may vary from the stated area. 5. Drawings not to scale. 6. All images used are for illustrative purpose only and do not represent the actual size, features, specifications, fittings, and furnishings. 7. The developer reserves the right to make revisions / alterations, at its absolute discretion, without any liability whatsoever.



DUBAI CREEK  
HARBOUR

BREEZE AT  
CREEK BEACH

BUILDING 2

LEVEL 2,3

UNIT 06

2 BEDROOM

APARTMENT AREA	86.13 SQ.M.	927.10 SQ.FT.
BALCONY AREA	10.58 SQ.M.	113.88 SQ.FT.
TOTAL AREA	96.71 SQ.M.	1040.98 SQ.FT.

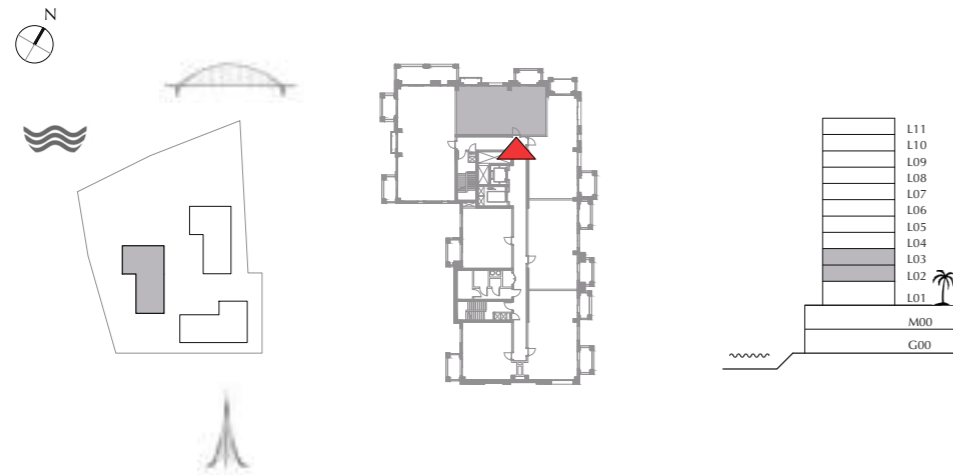

FLOOR PLAN 1. All dimensions are in imperial and metric, and measured from finish to finish excluding construction tolerances. 2. All materials, dimensions, and drawings are approximate only. 3. Information is subject to change without notice, at developer's absolute discretion. 4. Actual area may vary from the stated area. 5. Drawings not to scale. 6. All images used are for illustrative purpose only and do not represent the actual size, features, specifications, fittings, and finishings. 7. The developer reserves the right to make revisions / alterations, at its absolute discretion, without any liability whatsoever.



DUBAI CREEK  
HARBOUR

BREEZE AT  
CREEK BEACH

BUILDING 2

LEVEL 2,3

UNIT 07

3 BEDROOM

APARTMENT AREA	129.79 SQ.M.	1397.05 SQ.FT.
BALCONY AREA	37.85 SQ.M.	407.41 SQ.FT.
TOTAL AREA	167.64 SQ.M.	1804.46 SQ.FT.

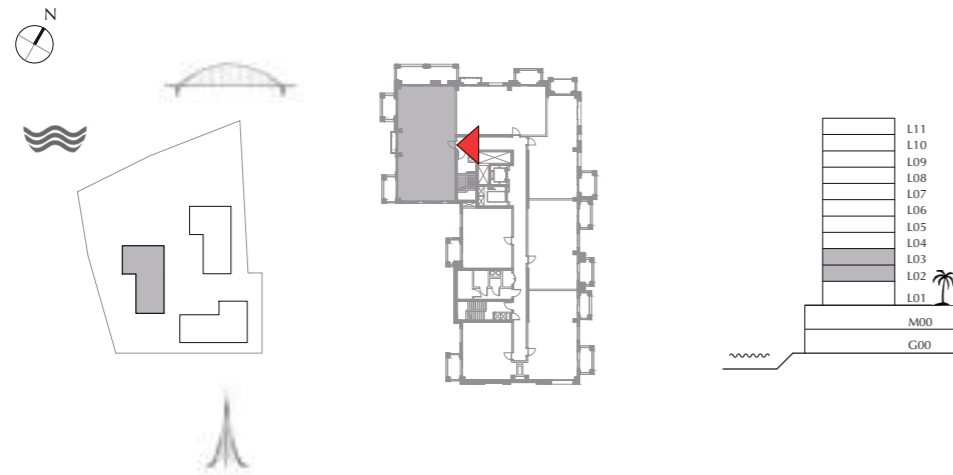

FLOOR PLAN 1. All dimensions are in imperial and metric, and measured from finish to finish excluding construction tolerances. 2. All materials, dimensions, and drawings are approximate only. 3. Information is subject to change without notice, at developer's absolute discretion. 4. Actual area may vary from the stated area. 5. Drawings not to scale. 6. All images used are for illustrative purpose only and do not represent the actual size, features, specifications, fittings, and finishings. 7. The developer reserves the right to make revisions / alterations, at its absolute discretion, without any liability whatsoever.



DUBAI CREEK  
HARBOUR

BREEZE AT  
CREEK BEACH

BUILDING 2

LEVEL 4

UNIT 01

1 BEDROOM

APARTMENT AREA	58.69 SQ.M.	631.73 SQ.FT.
BALCONY AREA	6.58 SQ.M.	70.83 SQ.FT.
TOTAL AREA	65.27 SQ.M.	702.56 SQ.FT.

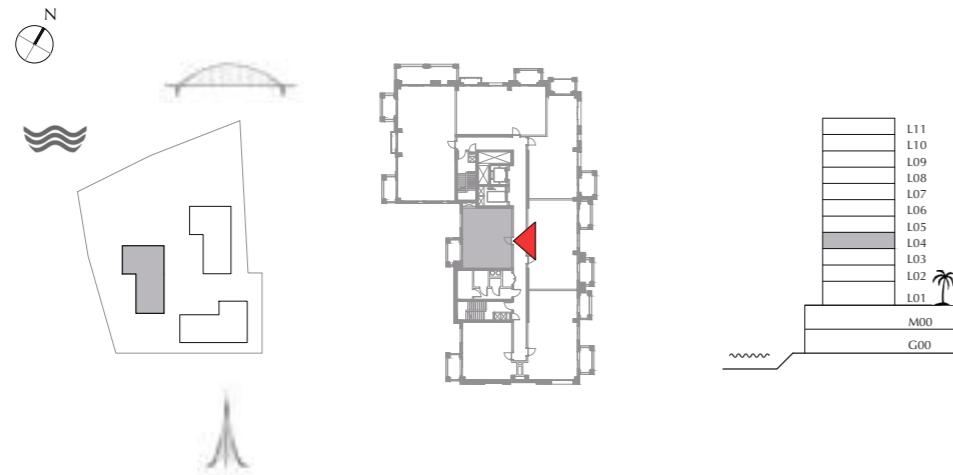

FLOOR PLAN 1. All dimensions are in imperial and metric, and measured from finish to finish excluding construction tolerances. 2. All materials, dimensions, and drawings are approximate only. 3. Information is subject to change without notice, at developer's absolute discretion. 4. Actual area may vary from the stated area. 5. Drawings not to scale. 6. All images used are for illustrative purpose only and do not represent the actual size, features, specifications, fittings, and finishings. 7. The developer reserves the right to make revisions / alterations, at its absolute discretion, without any liability whatsoever.

DUBAI CREEK  
HARBOUR

BREEZE AT  
CREEK BEACH

BUILDING 2

LEVEL 4

UNIT 02

1 BEDROOM

APARTMENT AREA	58.27 SQ.M.	627.21 SQ.FT.
BALCONY AREA	6.96 SQ.M.	74.92 SQ.FT.
TOTAL AREA	65.23 SQ.M.	702.13 SQ.FT.

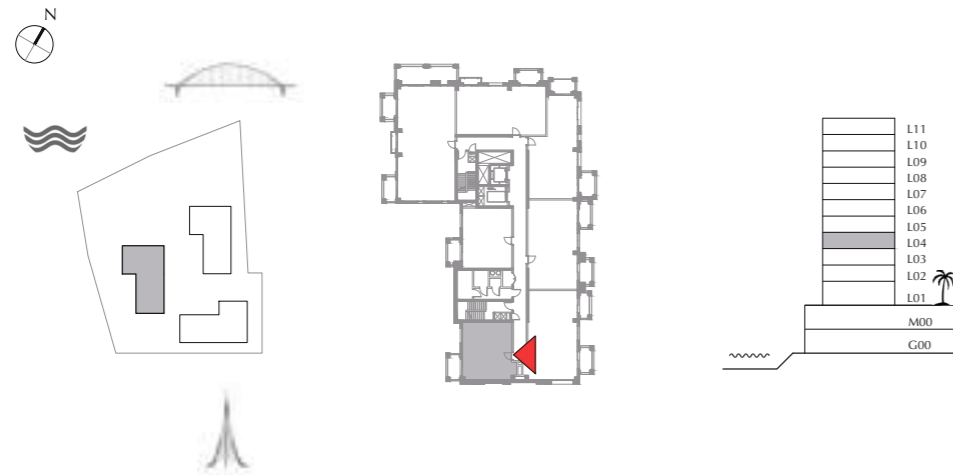

FLOOR PLAN 1. All dimensions are in imperial and metric, and measured from finish to finish excluding construction tolerances. 2. All materials, dimensions, and drawings are approximate only. 3. Information is subject to change without notice, at developer's absolute discretion. 4. Actual area may vary from the stated area. 5. Drawings not to scale. 6. All images used are for illustrative purpose only and do not represent the actual size, features, specifications, fittings, and furnishings. 7. The developer reserves the right to make revisions / alterations, at its absolute discretion, without any liability whatsoever.



DUBAI CREEK  
HARBOUR

BREEZE AT  
CREEK BEACH

BUILDING 2

LEVEL 4

UNIT 03

2 BEDROOM

APARTMENT AREA	88.30 SQ.M.	950.45 SQ.FT.
BALCONY AREA	9.54 SQ.M.	102.69 SQ.FT.
TOTAL AREA	97.84 SQ.M.	1053.14 SQ.FT.

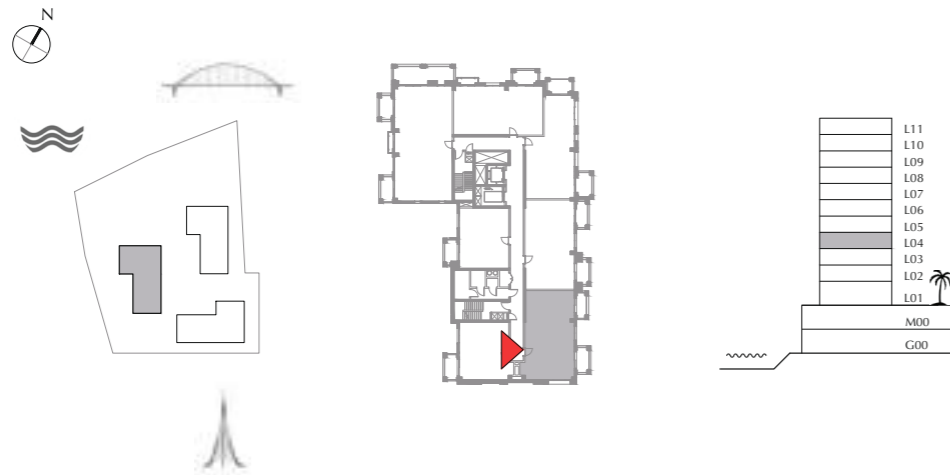

FLOOR PLAN 1. All dimensions are in imperial and metric, and measured from finish to finish excluding construction tolerances. 2. All materials, dimensions, and drawings are approximate only. 3. Information is subject to change without notice, at developer's absolute discretion. 4. Actual area may vary from the stated area. 5. Drawings not to scale. 6. All images used are for illustrative purpose only and do not represent the actual size, features, specifications, fittings, and finishings. 7. The developer reserves the right to make revisions / alterations, at its absolute discretion, without any liability whatsoever.





DUBAI CREEK  
HARBOUR

BREEZE AT  
CREEK BEACH

BUILDING 2

LEVEL 4

UNIT 04

2 BEDROOM

APARTMENT AREA	85.96 SQ.M.	925.27 SQ.FT.
BALCONY AREA	9.85 SQ.M.	106.02 SQ.FT.
TOTAL AREA	95.81 SQ.M.	1031.29 SQ.FT.

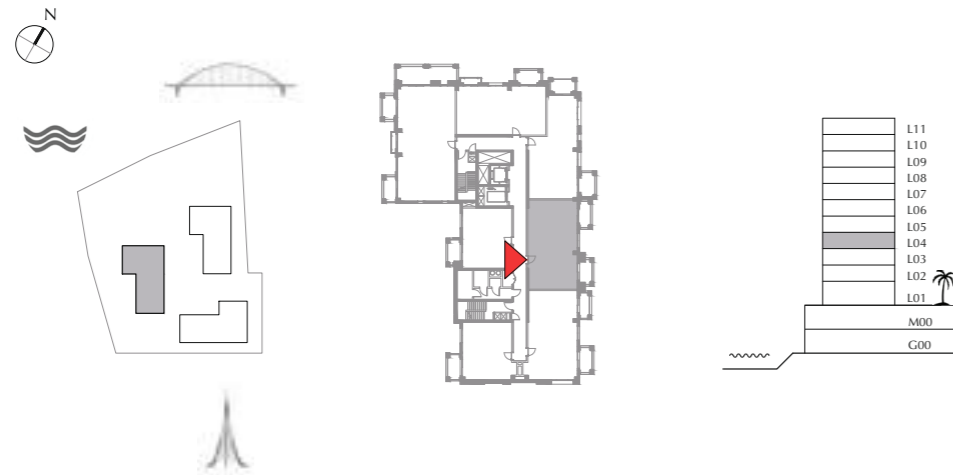

FLOOR PLAN 1. All dimensions are in imperial and metric, and measured from finish to finish excluding construction tolerances. 2. All materials, dimensions, and drawings are approximate only. 3. Information is subject to change without notice, at developer's absolute discretion. 4. Actual area may vary from the stated area. 5. Drawings not to scale. 6. All images used are for illustrative purpose only and do not represent the actual size, features, specifications, fittings, and finishings. 7. The developer reserves the right to make revisions / alterations, at its absolute discretion, without any liability whatsoever.



DUBAI CREEK  
HARBOUR

BREEZE AT  
CREEK BEACH

BUILDING 2

LEVEL 4

UNIT 05

2 BEDROOM

APARTMENT AREA	84.46 SQ.M.	909.12 SQ.FT.
BALCONY AREA	16.43 SQ.M.	176.85 SQ.FT.
TOTAL AREA	100.89 SQ.M.	1085.97 SQ.FT.

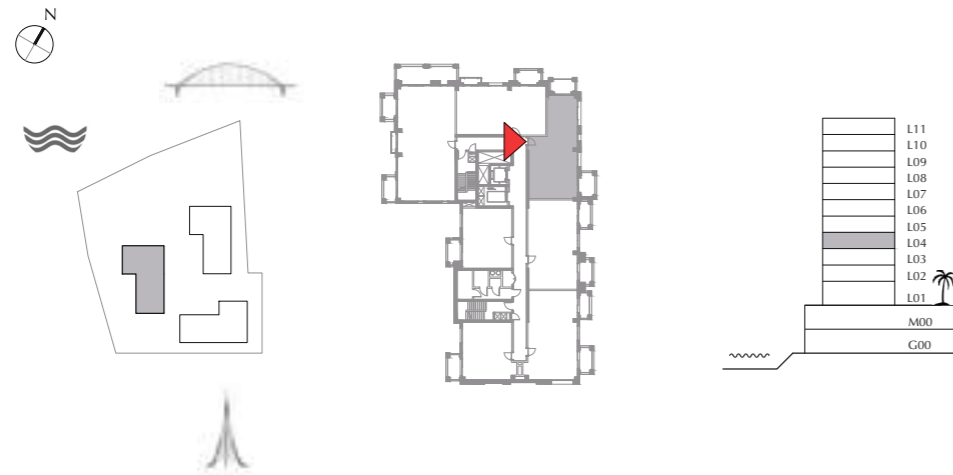

FLOOR PLAN 1. All dimensions are in imperial and metric, and measured from finish to finish excluding construction tolerances. 2. All materials, dimensions, and drawings are approximate only. 3. Information is subject to change without notice, at developer's absolute discretion. 4. Actual area may vary from the stated area. 5. Drawings not to scale. 6. All images used are for illustrative purpose only and do not represent the actual size, features, specifications, fittings, and furnishings. 7. The developer reserves the right to make revisions / alterations, at its absolute discretion, without any liability whatsoever.



DUBAI CREEK  
HARBOUR

BREEZE AT  
CREEK BEACH

BUILDING 2

LEVEL 4

UNIT 06

2 BEDROOM

APARTMENT AREA	86.13 SQ.M.	927.10 SQ.FT.
BALCONY AREA	10.58 SQ.M.	113.88 SQ.FT.
TOTAL AREA	96.71 SQ.M.	1040.98 SQ.FT.

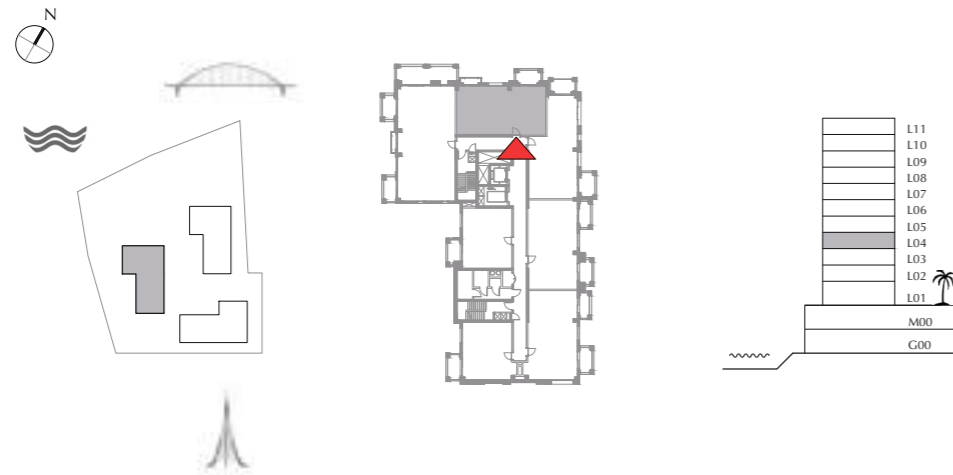

FLOOR PLAN 1. All dimensions are in imperial and metric, and measured from finish to finish excluding construction tolerances. 2. All materials, dimensions, and drawings are approximate only. 3. Information is subject to change without notice, at developer's absolute discretion. 4. Actual area may vary from the stated area. 5. Drawings not to scale. 6. All images used are for illustrative purpose only and do not represent the actual size, features, specifications, fittings, and finishings. 7. The developer reserves the right to make revisions / alterations, at its absolute discretion, without any liability whatsoever.

DUBAI CREEK  
HARBOUR

BREEZE AT  
CREEK BEACH

BUILDING 2

LEVEL 4

UNIT 07

3 BEDROOM

APARTMENT AREA	129.79 SQ.M.	1397.05 SQ.FT.
BALCONY AREA	15.86 SQ.M.	170.72 SQ.FT.
TOTAL AREA	145.65 SQ.M.	1567.77 SQ.FT.

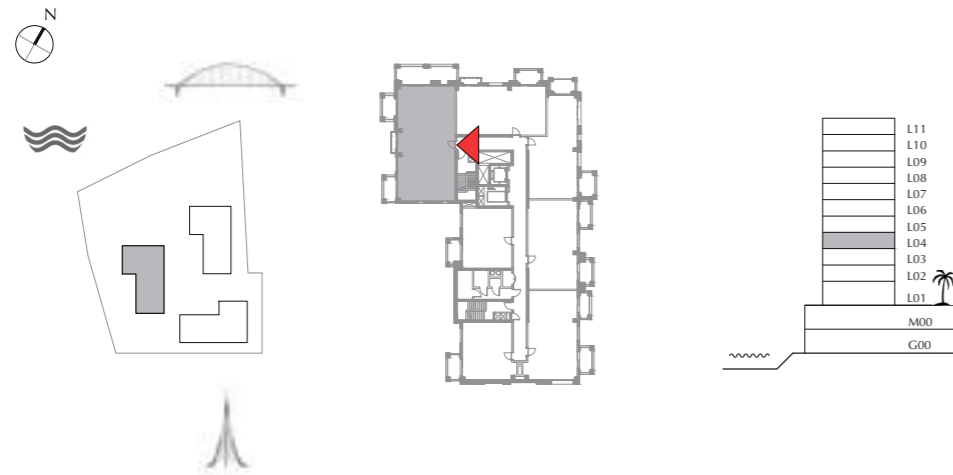

FLOOR PLAN 1. All dimensions are in imperial and metric, and measured from finish to finish excluding construction tolerances. 2. All materials, dimensions, and drawings are approximate only. 3. Information is subject to change without notice, at developer's absolute discretion. 4. Actual area may vary from the stated area. 5. Drawings not to scale. 6. All images used are for illustrative purpose only and do not represent the actual size, features, specifications, fittings, and finishings. 7. The developer reserves the right to make revisions / alterations, at its absolute discretion, without any liability whatsoever.





DUBAI CREEK  
HARBOUR

BREEZE AT  
CREEK BEACH

BUILDING 2

LEVEL 5,6,7

UNIT 01

1 BEDROOM

APARTMENT AREA	58.69 SQ.M.	631.73 SQ.FT.
BALCONY AREA	6.58 SQ.M.	70.83 SQ.FT.
TOTAL AREA	65.27 SQ.M.	702.56 SQ.FT.

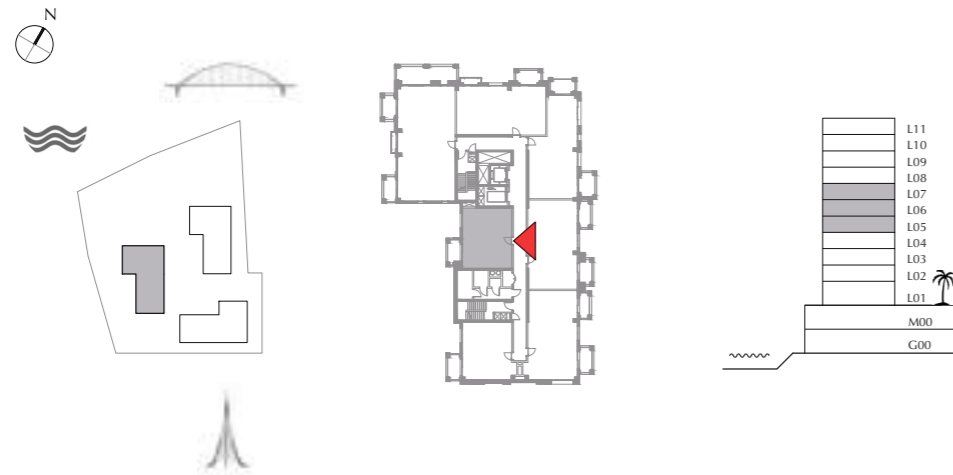

FLOOR PLAN 1. All dimensions are in imperial and metric, and measured from finish to finish excluding construction tolerances. 2. All materials, dimensions, and drawings are approximate only. 3. Information is subject to change without notice, at developer's absolute discretion. 4. Actual area may vary from the stated area. 5. Drawings not to scale. 6. All images used are for illustrative purpose only and do not represent the actual size, features, specifications, fittings, and finishings. 7. The developer reserves the right to make revisions / alterations, at its absolute discretion, without any liability whatsoever.



DUBAI CREEK  
HARBOUR

BREEZE AT  
CREEK BEACH

BUILDING 2

LEVEL 5,6,7

UNIT 02

1 BEDROOM

APARTMENT AREA	58.27 SQ.M.	627.21 SQ.FT.
BALCONY AREA	6.96 SQ.M.	74.92 SQ.FT.
TOTAL AREA	65.23 SQ.M.	702.13 SQ.FT.

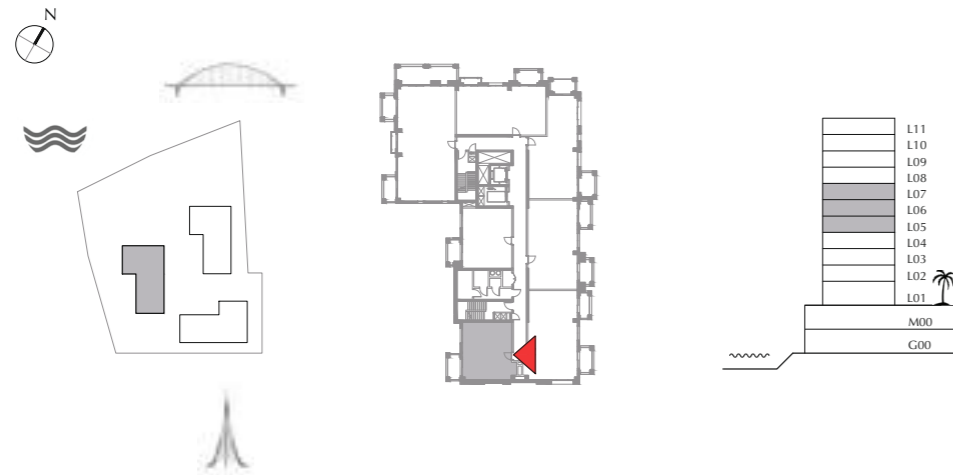

FLOOR PLAN 1. All dimensions are in imperial and metric, and measured from finish to finish excluding construction tolerances. 2. All materials, dimensions, and drawings are approximate only. 3. Information is subject to change without notice, at developer's absolute discretion. 4. Actual area may vary from the stated area. 5. Drawings not to scale. 6. All images used are for illustrative purpose only and do not represent the actual size, features, specifications, fittings, and finishings. 7. The developer reserves the right to make revisions / alterations, at its absolute discretion, without any liability whatsoever.



DUBAI CREEK  
HARBOUR

BREEZE AT  
CREEK BEACH

BUILDING 2

LEVEL 5,6,7

UNIT 03

2 BEDROOM

APARTMENT AREA	88.30 SQ.M.	950.45 SQ.FT.
BALCONY AREA	9.54 SQ.M.	102.69 SQ.FT.
TOTAL AREA	97.84 SQ.M.	1053.14 SQ.FT.

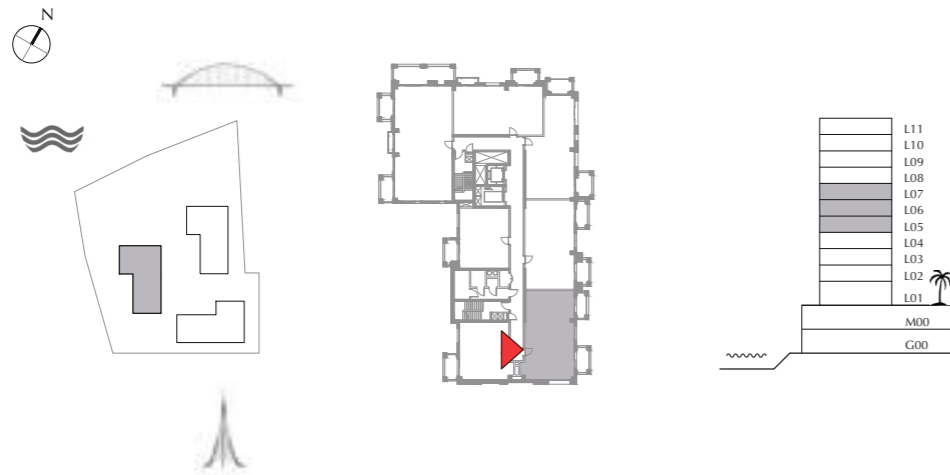

FLOOR PLAN 1. All dimensions are in imperial and metric, and measured from finish to finish excluding construction tolerances. 2. All materials, dimensions, and drawings are approximate only. 3. Information is subject to change without notice, at developer's absolute discretion. 4. Actual area may vary from the stated area. 5. Drawings not to scale. 6. All images used are for illustrative purpose only and do not represent the actual size, features, specifications, fittings, and finishings. 7. The developer reserves the right to make revisions / alterations, at its absolute discretion, without any liability whatsoever.



DUBAI CREEK  
HARBOUR

BREEZE AT  
CREEK BEACH

BUILDING 2

LEVEL 5,6,7

UNIT 04

2 BEDROOM

APARTMENT AREA	85.96 SQ.M.	925.27 SQ.FT.
BALCONY AREA	9.85 SQ.M.	106.02 SQ.FT.
TOTAL AREA	95.81 SQ.M.	1031.29 SQ.FT.

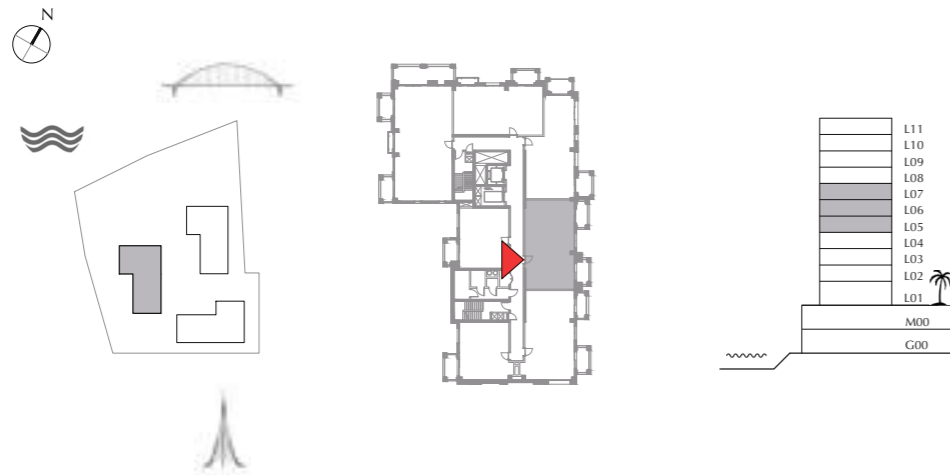

FLOOR PLAN 1. All dimensions are in imperial and metric, and measured from finish to finish excluding construction tolerances. 2. All materials, dimensions, and drawings are approximate only. 3. Information is subject to change without notice, at developer's absolute discretion. 4. Actual area may vary from the stated area. 5. Drawings not to scale. 6. All images used are for illustrative purpose only and do not represent the actual size, features, specifications, fittings, and finishings. 7. The developer reserves the right to make revisions / alterations, at its absolute discretion, without any liability whatsoever.





DUBAI CREEK  
HARBOUR

BREEZE AT  
CREEK BEACH

BUILDING 2

LEVEL 5,6,7

UNIT 05

2 BEDROOM

APARTMENT AREA	84.46 SQ.M.	909.12 SQ.FT.
BALCONY AREA	11.13 SQ.M.	119.80 SQ.FT.
TOTAL AREA	95.59 SQ.M.	1028.92 SQ.FT.

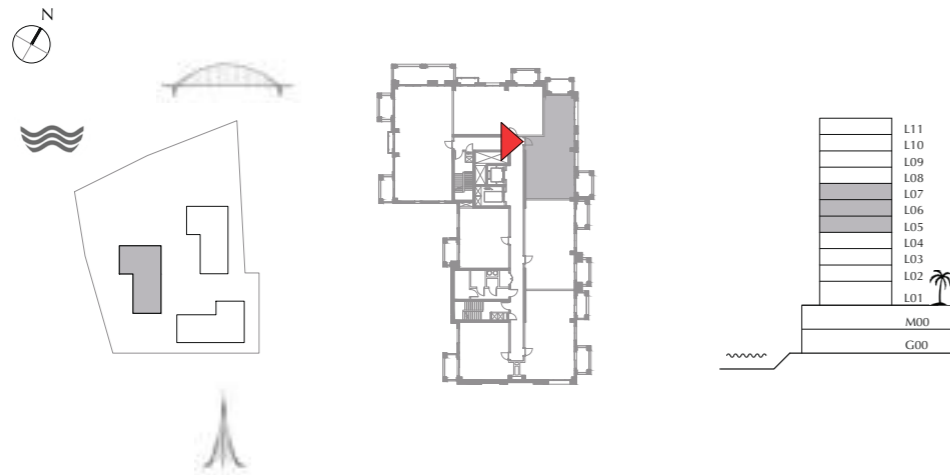

FLOOR PLAN 1. All dimensions are in imperial and metric, and measured from finish to finish excluding construction tolerances. 2. All materials, dimensions, and drawings are approximate only. 3. Information is subject to change without notice, at developer's absolute discretion. 4. Actual area may vary from the stated area. 5. Drawings not to scale. 6. All images used are for illustrative purpose only and do not represent the actual size, features, specifications, fittings, and furnishings. 7. The developer reserves the right to make revisions / alterations, at its absolute discretion, without any liability whatsoever.



DUBAI CREEK  
HARBOUR

BREEZE AT  
CREEK BEACH

BUILDING 2

LEVEL 5,6,7

UNIT 06

2 BEDROOM

APARTMENT AREA	86.13 SQ.M.	927.10 SQ.FT.
BALCONY AREA	10.58 SQ.M.	113.88 SQ.FT.
TOTAL AREA	96.71 SQ.M.	1040.98 SQ.FT.

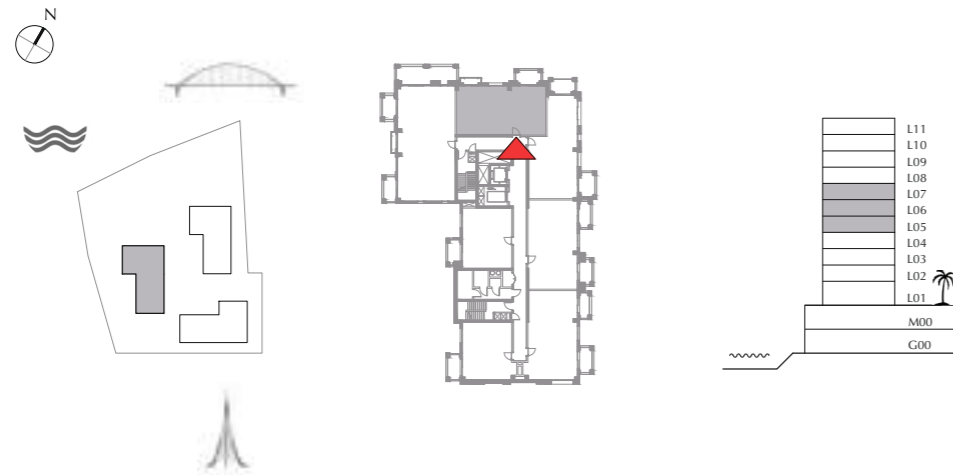

FLOOR PLAN 1. All dimensions are in imperial and metric, and measured from finish to finish excluding construction tolerances. 2. All materials, dimensions, and drawings are approximate only. 3. Information is subject to change without notice, at developer's absolute discretion. 4. Actual area may vary from the stated area. 5. Drawings not to scale. 6. All images used are for illustrative purpose only and do not represent the actual size, features, specifications, fittings, and finishings. 7. The developer reserves the right to make revisions / alterations, at its absolute discretion, without any liability whatsoever.

DUBAI CREEK  
HARBOUR

BREEZE AT  
CREEK BEACH

BUILDING 2

LEVEL 5,6,7

UNIT 07

3 BEDROOM

APARTMENT AREA	129.79 SQ.M.	1397.05 SQ.FT.
BALCONY AREA	15.86 SQ.M.	170.72 SQ.FT.
TOTAL AREA	145.65 SQ.M.	1567.77 SQ.FT.

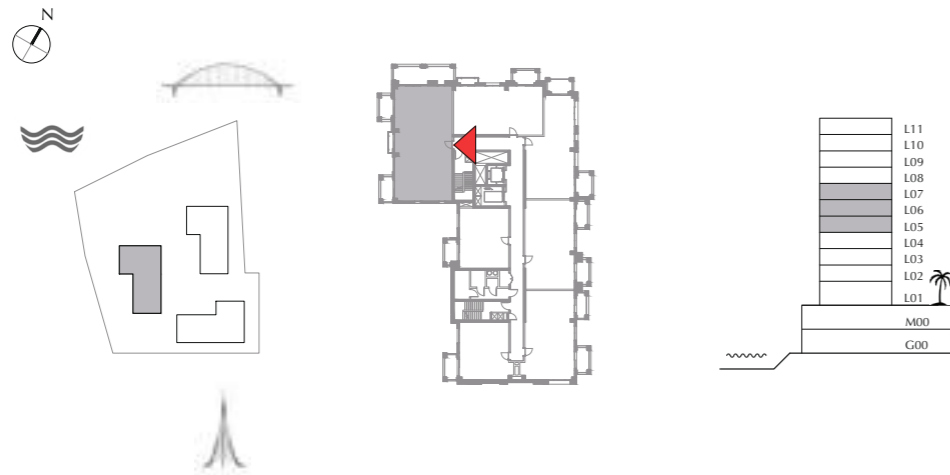

FLOOR PLAN 1. All dimensions are in imperial and metric, and measured from finish to finish excluding construction tolerances. 2. All materials, dimensions, and drawings are approximate only. 3. Information is subject to change without notice, at developer's absolute discretion. 4. Actual area may vary from the stated area. 5. Drawings not to scale. 6. All images used are for illustrative purpose only and do not represent the actual size, features, specifications, fittings, and finishings. 7. The developer reserves the right to make revisions / alterations, at its absolute discretion, without any liability whatsoever.



DUBAI CREEK  
HARBOUR

BREEZE AT  
CREEK BEACH

BUILDING 2

LEVEL 8

UNIT 801

1 BEDROOM

APARTMENT AREA	58.58 SQ.M.	630.55 SQ.FT.
BALCONY AREA	7.31 SQ.M.	78.68 SQ.FT.
TOTAL AREA	65.89 SQ.M.	709.23 SQ.FT.

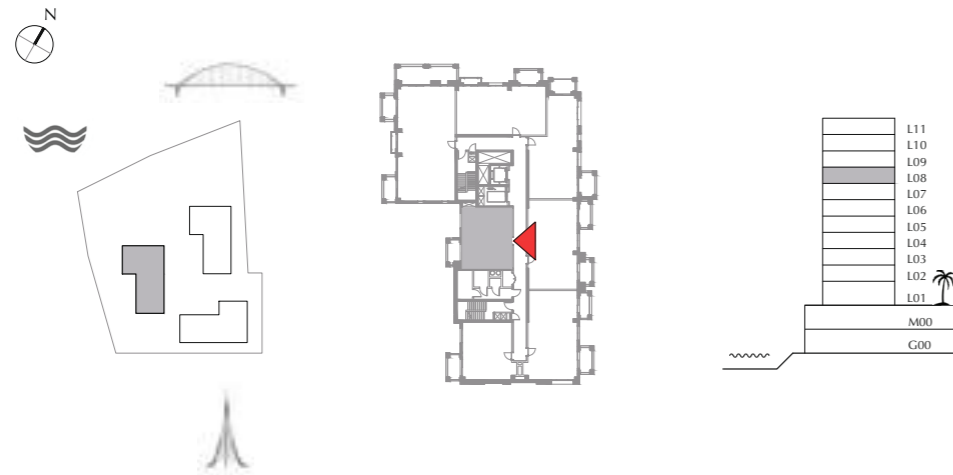

FLOOR PLAN 1. All dimensions are in imperial and metric, and measured from finish to finish excluding construction tolerances. 2. All materials, dimensions, and drawings are approximate only. 3. Information is subject to change without notice, at developer's absolute discretion. 4. Actual area may vary from the stated area. 5. Drawings not to scale. 6. All images used are for illustrative purpose only and do not represent the actual size, features, specifications, fittings, and finishings. 7. The developer reserves the right to make revisions / alterations, at its absolute discretion, without any liability whatsoever.





DUBAI CREEK  
HARBOUR

BREEZE AT  
CREEK BEACH

BUILDING 2

LEVEL 8

UNIT 802

1 BEDROOM

APARTMENT AREA	58.27 SQ.M.	627.21 SQ.FT.
BALCONY AREA	7.31 SQ.M.	78.68 SQ.FT.
TOTAL AREA	65.58 SQ.M.	705.89 SQ.FT.

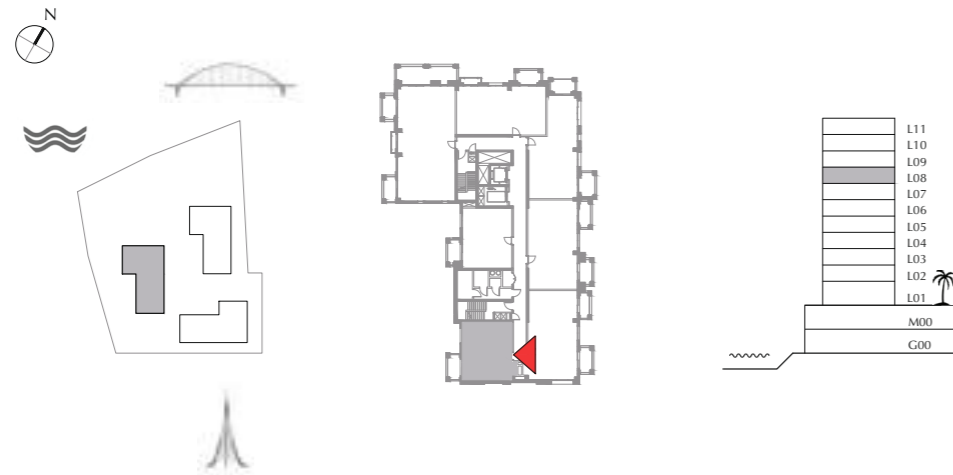

FLOOR PLAN 1. All dimensions are in imperial and metric, and measured from finish to finish excluding construction tolerances. 2. All materials, dimensions, and drawings are approximate only. 3. Information is subject to change without notice, at developer's absolute discretion. 4. Actual area may vary from the stated area. 5. Drawings not to scale. 6. All images used are for illustrative purpose only and do not represent the actual size, features, specifications, fittings, and finishings. 7. The developer reserves the right to make revisions / alterations, at its absolute discretion, without any liability whatsoever.



DUBAI CREEK  
HARBOUR

BREEZE AT  
CREEK BEACH

BUILDING 2

LEVEL 8

UNIT 803

2 BEDROOM

APARTMENT AREA	88.30 SQ.M.	950.45 SQ.FT.
BALCONY AREA	9.95 SQ.M.	107.10 SQ.FT.
TOTAL AREA	98.25 SQ.M.	1057.55 SQ.FT.

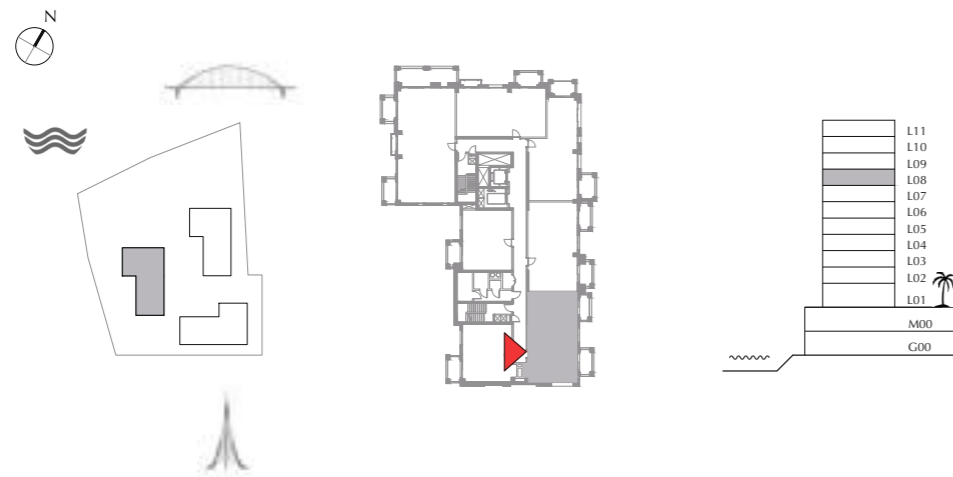

FLOOR PLAN 1. All dimensions are in imperial and metric, and measured from finish to finish excluding construction tolerances. 2. All materials, dimensions, and drawings are approximate only. 3. Information is subject to change without notice, at developer's absolute discretion. 4. Actual area may vary from the stated area. 5. Drawings not to scale. 6. All images used are for illustrative purpose only and do not represent the actual size, features, specifications, fittings, and finishings. 7. The developer reserves the right to make revisions / alterations, at its absolute discretion, without any liability whatsoever.



DUBAI CREEK  
HARBOUR

BREEZE AT  
CREEK BEACH

BUILDING 2

LEVEL 8

UNIT 804

2 BEDROOM

APARTMENT AREA	85.96 SQ.M.	925.27 SQ.FT.
BALCONY AREA	9.85 SQ.M.	106.02 SQ.FT.
TOTAL AREA	95.81 SQ.M.	1031.29 SQ.FT.

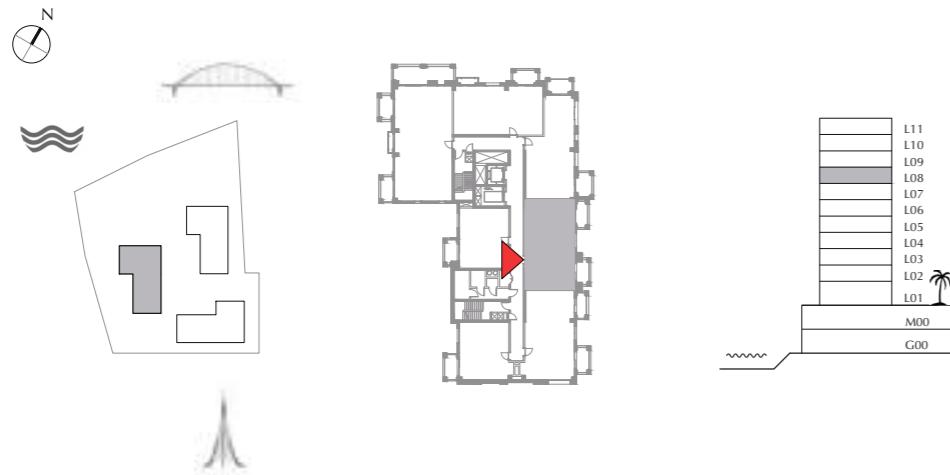

FLOOR PLAN 1. All dimensions are in imperial and metric, and measured from finish to finish excluding construction tolerances. 2. All materials, dimensions, and drawings are approximate only. 3. Information is subject to change without notice, at developer's absolute discretion. 4. Actual area may vary from the stated area. 5. Drawings not to scale. 6. All images used are for illustrative purpose only and do not represent the actual size, features, specifications, fittings, and furnishings. 7. The developer reserves the right to make revisions / alterations, at its absolute discretion, without any liability whatsoever.



DUBAI CREEK  
HARBOUR

BREEZE AT  
CREEK BEACH

BUILDING 2

LEVEL 8

UNIT 805

2 BEDROOM

APARTMENT AREA	84.46 SQ.M.	909.12 SQ.FT.
BALCONY AREA	11.60 SQ.M.	124.86 SQ.FT.
TOTAL AREA	96.06 SQ.M.	1033.98 SQ.FT.

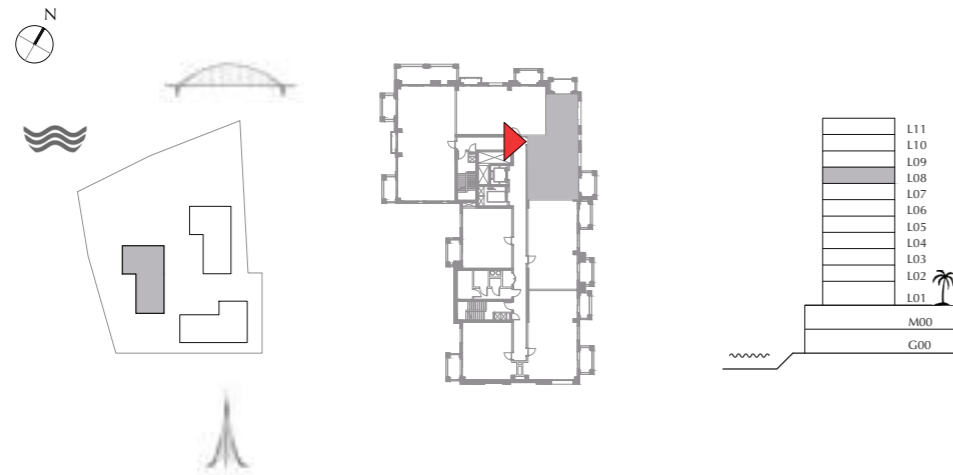

FLOOR PLAN 1. All dimensions are in imperial and metric, and measured from finish to finish excluding construction tolerances. 2. All materials, dimensions, and drawings are approximate only. 3. Information is subject to change without notice, at developer's absolute discretion. 4. Actual area may vary from the stated area. 5. Drawings not to scale. 6. All images used are for illustrative purpose only and do not represent the actual size, features, specifications, fittings, and finishings. 7. The developer reserves the right to make revisions / alterations, at its absolute discretion, without any liability whatsoever.





DUBAI CREEK  
HARBOUR

BREEZE AT  
CREEK BEACH

BUILDING 2

LEVEL 8

UNIT 806

2 BEDROOM

APARTMENT AREA	86.13 SQ.M.	927.10 SQ.FT.
BALCONY AREA	10.58 SQ.M.	113.88 SQ.FT.
TOTAL AREA	96.71 SQ.M.	1040.98 SQ.FT.

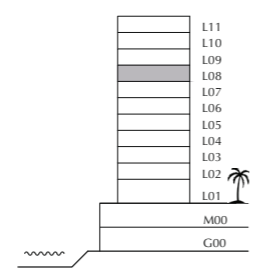
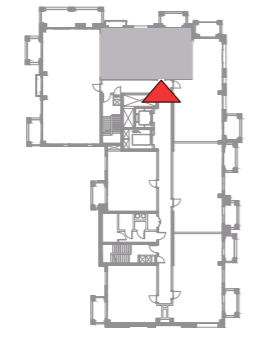
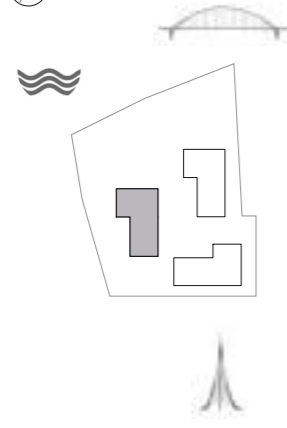

FLOOR PLAN 1. All dimensions are in imperial and metric, and measured from finish to finish excluding construction tolerances. 2. All materials, dimensions, and drawings are approximate only. 3. Information is subject to change without notice, at developer's absolute discretion. 4. Actual area may vary from the stated area. 5. Drawings not to scale. 6. All images used are for illustrative purpose only and do not represent the actual size, features, specifications, fittings, and finishings. 7. The developer reserves the right to make revisions / alterations, at its absolute discretion, without any liability whatsoever.

DUBAI CREEK  
HARBOUR

BREEZE AT  
CREEK BEACH

BUILDING 2

LEVEL 8

UNIT 807

3 BEDROOM

APARTMENT AREA	129.79 SQ.M.	1397.05 SQ.FT.
BALCONY AREA	16.58 SQ.M.	178.47 SQ.FT.
TOTAL AREA	146.37 SQ.M.	1575.52 SQ.FT.

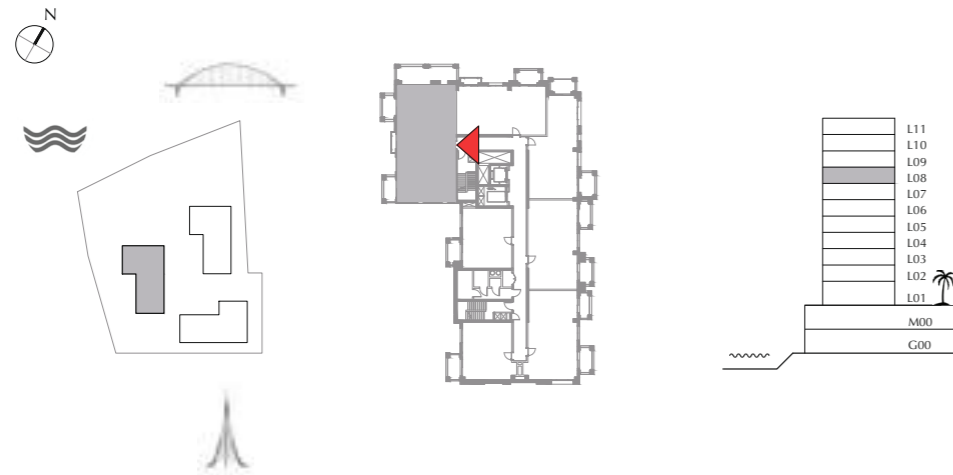

FLOOR PLAN 1. All dimensions are in imperial and metric, and measured from finish to finish excluding construction tolerances. 2. All materials, dimensions, and drawings are approximate only. 3. Information is subject to change without notice, at developer's absolute discretion. 4. Actual area may vary from the stated area. 5. Drawings not to scale. 6. All images used are for illustrative purpose only and do not represent the actual size, features, specifications, fittings, and finishings. 7. The developer reserves the right to make revisions / alterations, at its absolute discretion, without any liability whatsoever.

DUBAI CREEK  
HARBOUR

BREEZE AT  
CREEK BEACH

BUILDING 2

LEVEL 9

UNIT 01

1 BEDROOM

APARTMENT AREA	58.58 SQ.M.	630.55 SQ.FT.
BALCONY AREA	7.31 SQ.M.	78.68 SQ.FT.
TOTAL AREA	65.89 SQ.M.	709.23 SQ.FT.

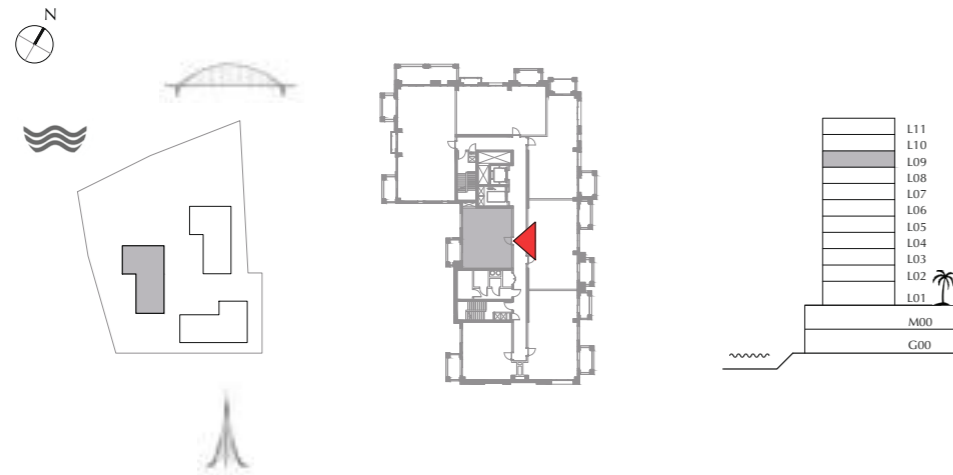

FLOOR PLAN 1. All dimensions are in imperial and metric, and measured from finish to finish excluding construction tolerances. 2. All materials, dimensions, and drawings are approximate only. 3. Information is subject to change without notice, at developer's absolute discretion. 4. Actual area may vary from the stated area. 5. Drawings not to scale. 6. All images used are for illustrative purpose only and do not represent the actual size, features, specifications, fittings, and furnishings. 7. The developer reserves the right to make revisions / alterations, at its absolute discretion, without any liability whatsoever.



DUBAI CREEK  
HARBOUR

BREEZE AT  
CREEK BEACH

BUILDING 2

LEVEL 9

UNIT 02

1 BEDROOM

APARTMENT AREA	58.27 SQ.M.	627.21 SQ.FT.
BALCONY AREA	7.31 SQ.M.	78.68 SQ.FT.
TOTAL AREA	65.58 SQ.M.	705.89 SQ.FT.

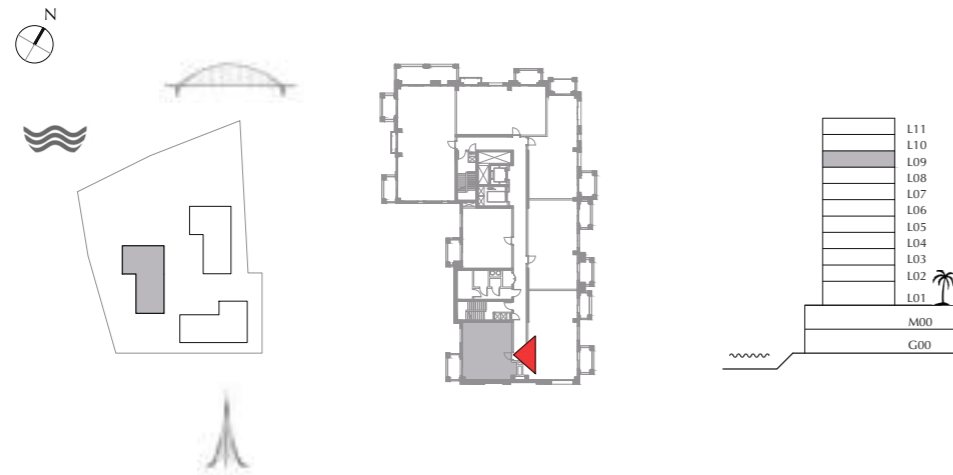

FLOOR PLAN 1. All dimensions are in imperial and metric, and measured from finish to finish excluding construction tolerances. 2. All materials, dimensions, and drawings are approximate only. 3. Information is subject to change without notice, at developer's absolute discretion. 4. Actual area may vary from the stated area. 5. Drawings not to scale. 6. All images used are for illustrative purpose only and do not represent the actual size, features, specifications, fittings, and finishings. 7. The developer reserves the right to make revisions / alterations, at its absolute discretion, without any liability whatsoever.





DUBAI CREEK  
HARBOUR

BREEZE AT  
CREEK BEACH

BUILDING 2

LEVEL 9

UNIT 03

2 BEDROOM

APARTMENT AREA	88.3 SQ.M.	950.45 SQ.FT.
BALCONY AREA	9.95 SQ.M.	107.10 SQ.FT.
TOTAL AREA	98.25 SQ.M.	1057.55 SQ.FT.

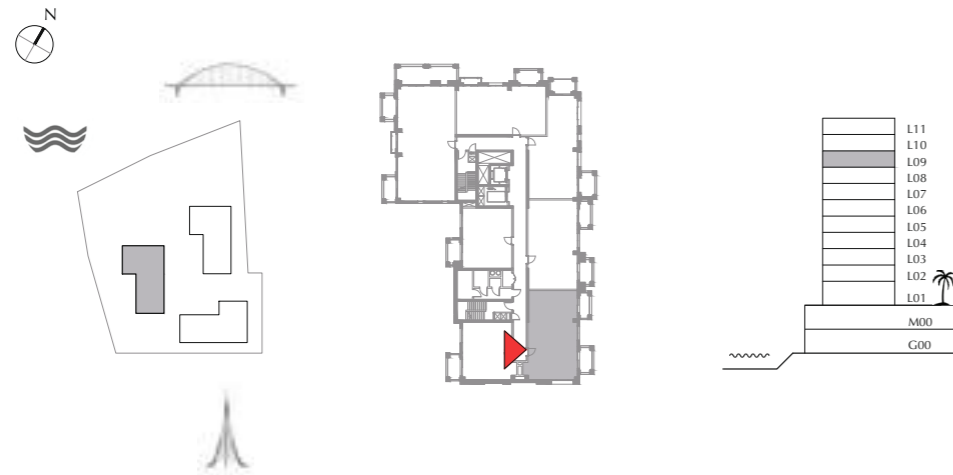

FLOOR PLAN 1. All dimensions are in imperial and metric, and measured from finish to finish excluding construction tolerances. 2. All materials, dimensions, and drawings are approximate only. 3. Information is subject to change without notice, at developer's absolute discretion. 4. Actual area may vary from the stated area. 5. Drawings not to scale. 6. All images used are for illustrative purpose only and do not represent the actual size, features, specifications, fittings, and finishings. 7. The developer reserves the right to make revisions / alterations, at its absolute discretion, without any liability whatsoever.

DUBAI CREEK  
HARBOUR

BREEZE AT  
CREEK BEACH

BUILDING 2

LEVEL 9

UNIT 04

2 BEDROOM

APARTMENT AREA	85.96 SQ.M.	925.27 SQ.FT.
BALCONY AREA	10.21 SQ.M.	109.90 SQ.FT.
TOTAL AREA	96.17 SQ.M.	1035.17 SQ.FT.

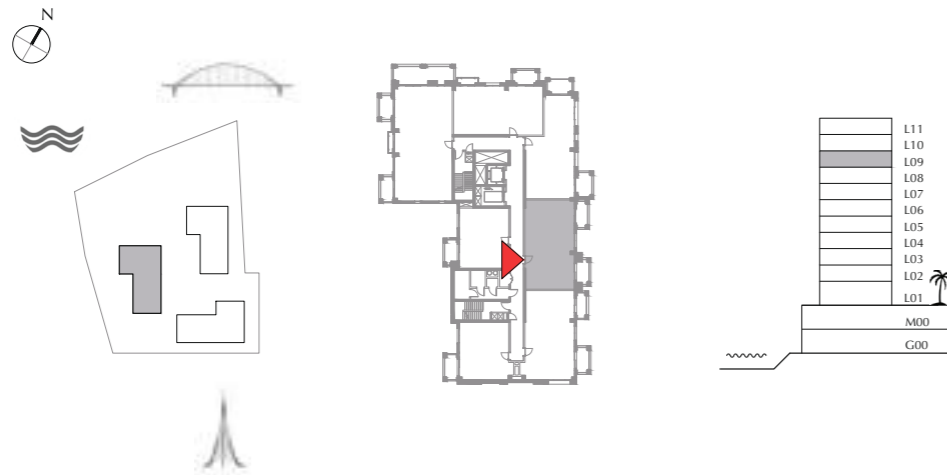

FLOOR PLAN 1. All dimensions are in imperial and metric, and measured from finish to finish excluding construction tolerances. 2. All materials, dimensions, and drawings are approximate only. 3. Information is subject to change without notice, at developer's absolute discretion. 4. Actual area may vary from the stated area. 5. Drawings not to scale. 6. All images used are for illustrative purpose only and do not represent the actual size, features, specifications, fittings, and finishings. 7. The developer reserves the right to make revisions / alterations, at its absolute discretion, without any liability whatsoever.



DUBAI CREEK  
HARBOUR

BREEZE AT  
CREEK BEACH

BUILDING 2

LEVEL 9

UNIT 05

2 BEDROOM

APARTMENT AREA	84.46 SQ.M.	909.12 SQ.FT.
BALCONY AREA	11.6 SQ.M.	124.86 SQ.FT.
TOTAL AREA	96.06 SQ.M.	1033.98 SQ.FT.

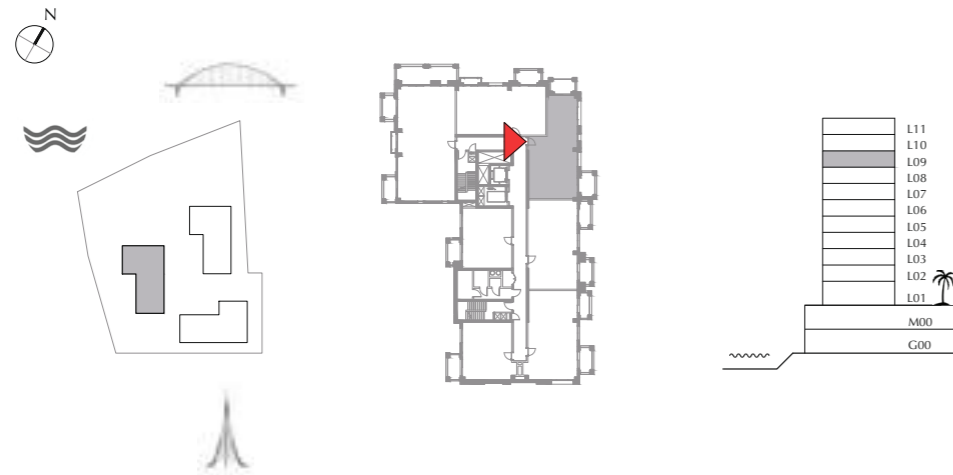

FLOOR PLAN 1. All dimensions are in imperial and metric, and measured from finish to finish excluding construction tolerances. 2. All materials, dimensions, and drawings are approximate only. 3. Information is subject to change without notice, at developer's absolute discretion. 4. Actual area may vary from the stated area. 5. Drawings not to scale. 6. All images used are for illustrative purpose only and do not represent the actual size, features, specifications, fittings, and finishings. 7. The developer reserves the right to make revisions / alterations, at its absolute discretion, without any liability whatsoever.



DUBAI CREEK  
HARBOUR

BREEZE AT  
CREEK BEACH

BUILDING 2

LEVEL 9

UNIT 06

2 BEDROOM

APARTMENT AREA	86.13 SQ.M.	927.10 SQ.FT.
BALCONY AREA	10.94 SQ.M.	117.76 SQ.FT.
TOTAL AREA	97.07 SQ.M.	1044.86 SQ.FT.

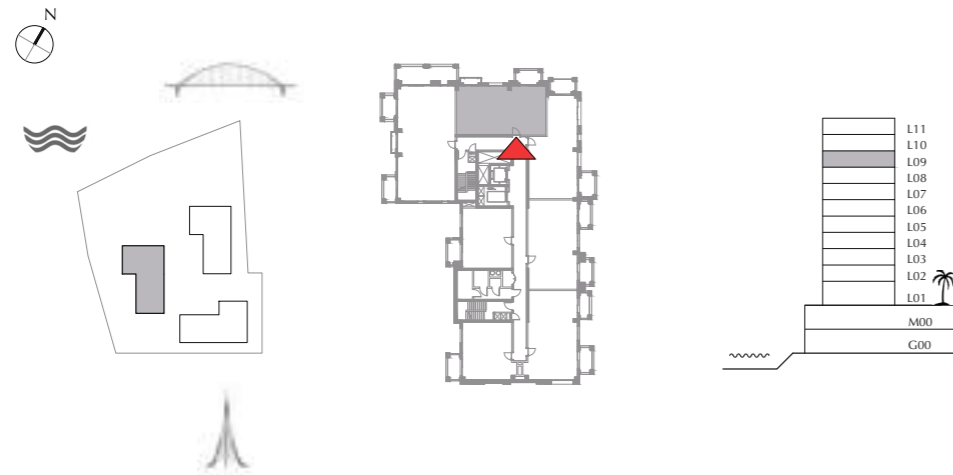

FLOOR PLAN 1. All dimensions are in imperial and metric, and measured from finish to finish excluding construction tolerances. 2. All materials, dimensions, and drawings are approximate only. 3. Information is subject to change without notice, at developer's absolute discretion. 4. Actual area may vary from the stated area. 5. Drawings not to scale. 6. All images used are for illustrative purpose only and do not represent the actual size, features, specifications, fittings, and finishings. 7. The developer reserves the right to make revisions / alterations, at its absolute discretion, without any liability whatsoever.





DUBAI CREEK  
HARBOUR

BREEZE AT  
CREEK BEACH

BUILDING 2

LEVEL 9

UNIT 07

3 BEDROOM

APARTMENT AREA	129.79 SQ.M.	1397.05 SQ.FT.
BALCONY AREA	16.73 SQ.M.	180.08 SQ.FT.
TOTAL AREA	146.52 SQ.M.	1577.13 SQ.FT.

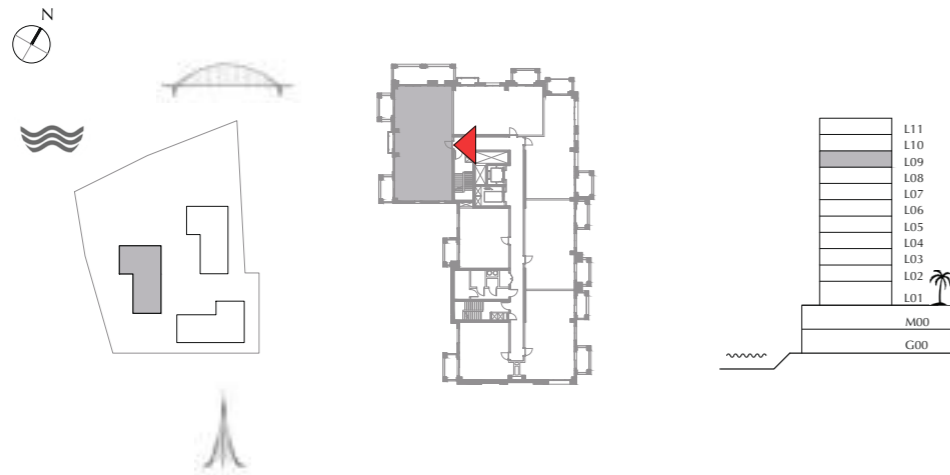

FLOOR PLAN 1. All dimensions are in imperial and metric, and measured from finish to finish excluding construction tolerances. 2. All materials, dimensions, and drawings are approximate only. 3. Information is subject to change without notice, at developer's absolute discretion. 4. Actual area may vary from the stated area. 5. Drawings not to scale. 6. All images used are for illustrative purpose only and do not represent the actual size, features, specifications, fittings, and finishings. 7. The developer reserves the right to make revisions / alterations, at its absolute discretion, without any liability whatsoever.



DUBAI CREEK  
HARBOUR

BREEZE AT  
CREEK BEACH

BUILDING 2

LEVEL 10

UNIT 01

1 BEDROOM

APARTMENT AREA	58.58 SQ.M.	630.55 SQ.FT.
BALCONY AREA	7.31 SQ.M.	78.68 SQ.FT.
TOTAL AREA	65.89 SQ.M.	709.23 SQ.FT.

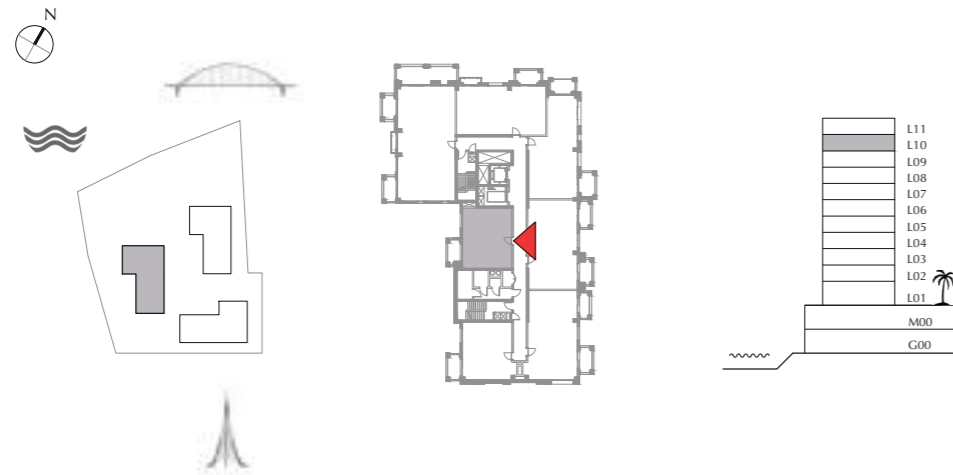

FLOOR PLAN 1. All dimensions are in imperial and metric, and measured from finish to finish excluding construction tolerances. 2. All materials, dimensions, and drawings are approximate only. 3. Information is subject to change without notice, at developer's absolute discretion. 4. Actual area may vary from the stated area. 5. Drawings not to scale. 6. All images used are for illustrative purpose only and do not represent the actual size, features, specifications, fittings, and furnishings. 7. The developer reserves the right to make revisions / alterations, at its absolute discretion, without any liability whatsoever.



DUBAI CREEK  
HARBOUR

BREEZE AT  
CREEK BEACH

BUILDING 2

LEVEL 10

UNIT 02

1 BEDROOM

APARTMENT AREA	58.27 SQ.M.	627.21 SQ.FT.
BALCONY AREA	7.31 SQ.M.	78.68 SQ.FT.
TOTAL AREA	65.58 SQ.M.	705.89 SQ.FT.

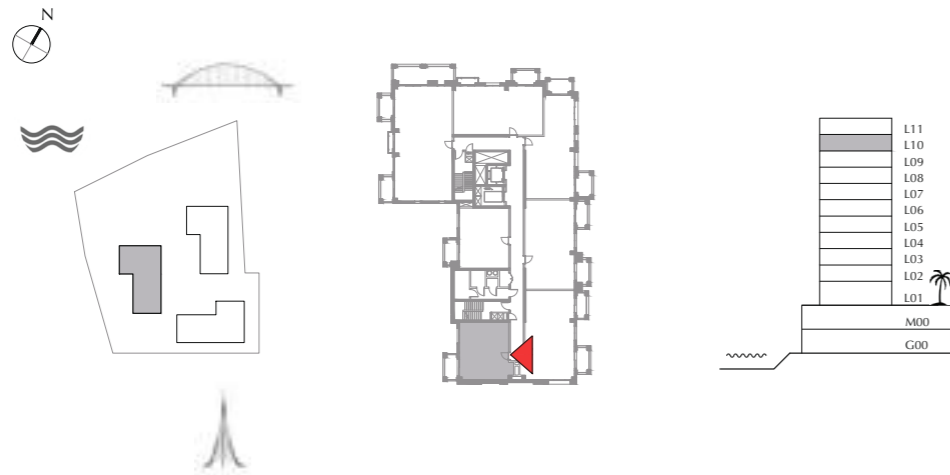

FLOOR PLAN 1. All dimensions are in imperial and metric, and measured from finish to finish excluding construction tolerances. 2. All materials, dimensions, and drawings are approximate only. 3. Information is subject to change without notice, at developer's absolute discretion. 4. Actual area may vary from the stated area. 5. Drawings not to scale. 6. All images used are for illustrative purpose only and do not represent the actual size, features, specifications, fittings, and finishings. 7. The developer reserves the right to make revisions / alterations, at its absolute discretion, without any liability whatsoever.



DUBAI CREEK  
HARBOUR

BREEZE AT  
CREEK BEACH

BUILDING 2

LEVEL 10

UNIT 03

2 BEDROOM

APARTMENT AREA	88.3 SQ.M.	950.45 SQ.FT.
BALCONY AREA	9.95 SQ.M.	107.10 SQ.FT.
TOTAL AREA	98.25 SQ.M.	1057.55 SQ.FT.

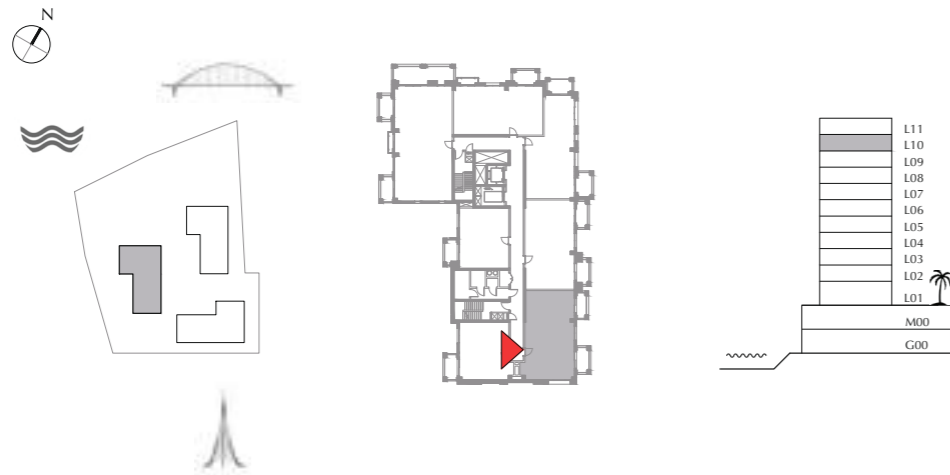

FLOOR PLAN 1. All dimensions are in imperial and metric, and measured from finish to finish excluding construction tolerances. 2. All materials, dimensions, and drawings are approximate only. 3. Information is subject to change without notice, at developer's absolute discretion. 4. Actual area may vary from the stated area. 5. Drawings not to scale. 6. All images used are for illustrative purpose only and do not represent the actual size, features, specifications, fittings, and finishings. 7. The developer reserves the right to make revisions / alterations, at its absolute discretion, without any liability whatsoever.





DUBAI CREEK  
HARBOUR

BREEZE AT  
CREEK BEACH

BUILDING 2

LEVEL 10

UNIT 04

2 BEDROOM

APARTMENT AREA	85.96 SQ.M.	925.27 SQ.FT.
BALCONY AREA	10.21 SQ.M.	109.90 SQ.FT.
TOTAL AREA	96.17 SQ.M.	1035.17 SQ.FT.

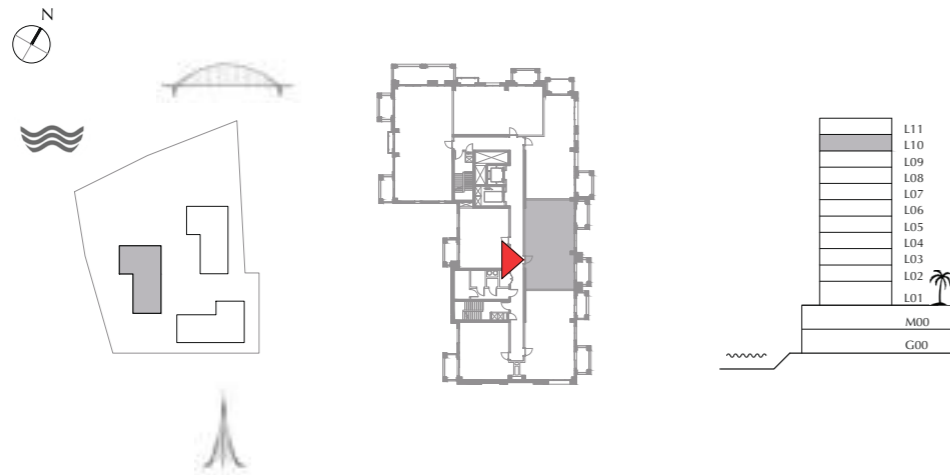

FLOOR PLAN 1. All dimensions are in imperial and metric, and measured from finish to finish excluding construction tolerances. 2. All materials, dimensions, and drawings are approximate only. 3. Information is subject to change without notice, at developer's absolute discretion. 4. Actual area may vary from the stated area. 5. Drawings not to scale. 6. All images used are for illustrative purpose only and do not represent the actual size, features, specifications, fittings, and finishings. 7. The developer reserves the right to make revisions / alterations, at its absolute discretion, without any liability whatsoever.



DUBAI CREEK  
HARBOUR

BREEZE AT  
CREEK BEACH

BUILDING 2

LEVEL 10

UNIT 05

2 BEDROOM

APARTMENT AREA	84.46 SQ.M.	909.12 SQ.FT.
BALCONY AREA	11.6 SQ.M.	124.86 SQ.FT.
TOTAL AREA	96.06 SQ.M.	1033.98 SQ.FT.

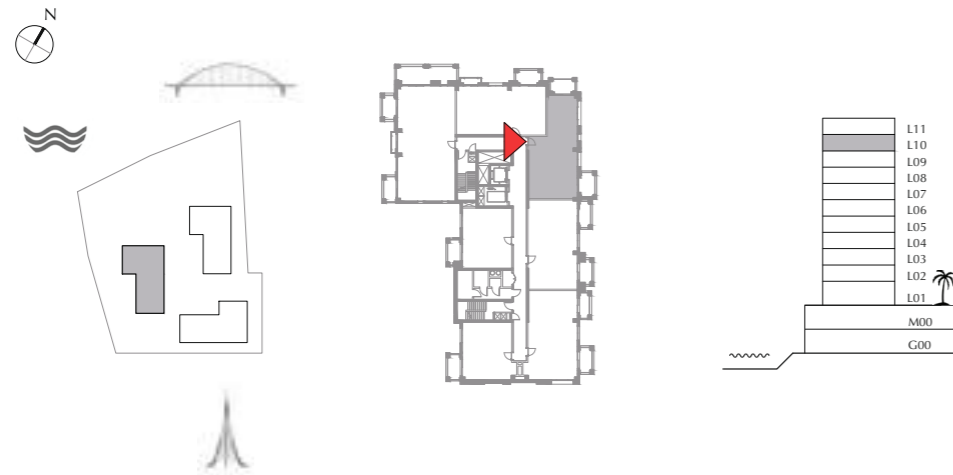

FLOOR PLAN 1. All dimensions are in imperial and metric, and measured from finish to finish excluding construction tolerances. 2. All materials, dimensions, and drawings are approximate only. 3. Information is subject to change without notice, at developer's absolute discretion. 4. Actual area may vary from the stated area. 5. Drawings not to scale. 6. All images used are for illustrative purpose only and do not represent the actual size, features, specifications, fittings, and finishings. 7. The developer reserves the right to make revisions / alterations, at its absolute discretion, without any liability whatsoever.



DUBAI CREEK  
HARBOUR

BREEZE AT  
CREEK BEACH

BUILDING 2

LEVEL 10

UNIT 06

2 BEDROOM

APARTMENT AREA	86.13 SQ.M.	927.10 SQ.FT.
BALCONY AREA	7.87 SQ.M.	84.71 SQ.FT.
TOTAL AREA	94.00 SQ.M.	1011.81 SQ.FT.

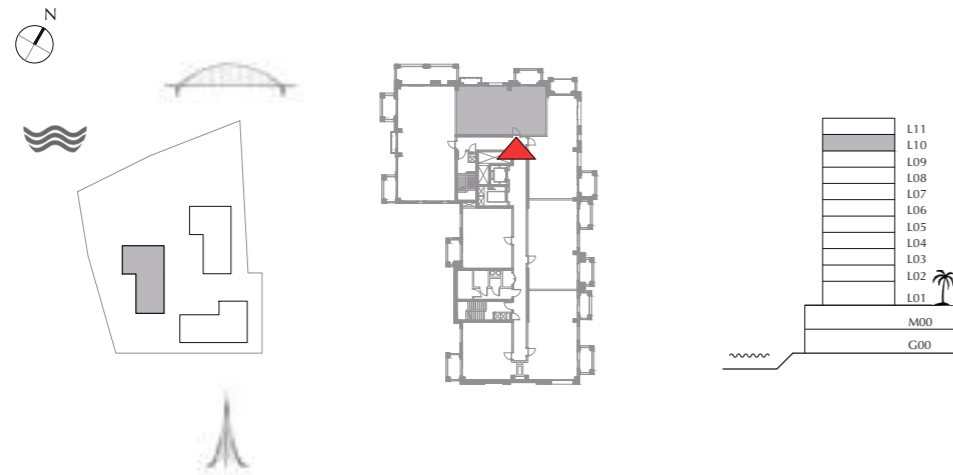

FLOOR PLAN 1. All dimensions are in imperial and metric, and measured from finish to finish excluding construction tolerances. 2. All materials, dimensions, and drawings are approximate only. 3. Information is subject to change without notice, at developer's absolute discretion. 4. Actual area may vary from the stated area. 5. Drawings not to scale. 6. All images used are for illustrative purpose only and do not represent the actual size, features, specifications, fittings, and finishings. 7. The developer reserves the right to make revisions / alterations, at its absolute discretion, without any liability whatsoever.



DUBAI CREEK  
HARBOUR

BREEZE AT  
CREEK BEACH

BUILDING 2

LEVEL 10

UNIT 07

3 BEDROOM

APARTMENT AREA	129.79 SQ.M.	1397.05 SQ.FT.
BALCONY AREA	16.73 SQ.M.	180.08 SQ.FT.
TOTAL AREA	146.52 SQ.M.	1577.13 SQ.FT.

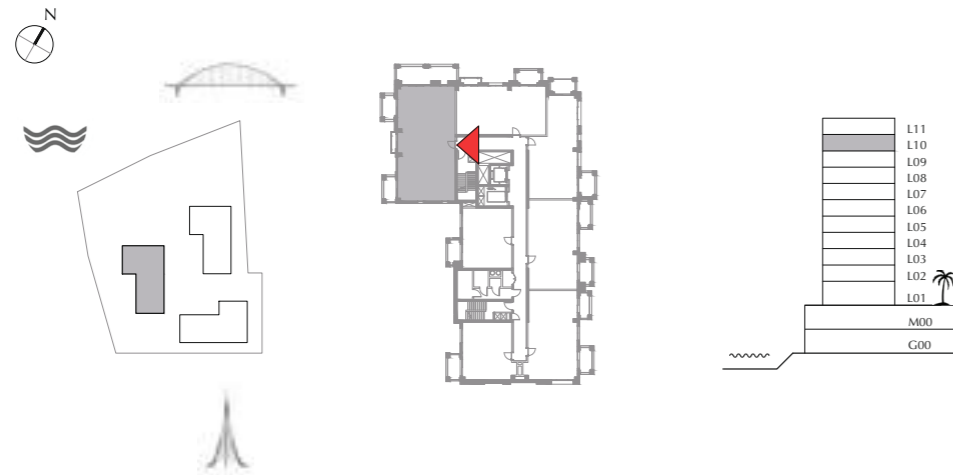

FLOOR PLAN 1. All dimensions are in imperial and metric, and measured from finish to finish excluding construction tolerances. 2.All materials, dimensions, and drawings are approximate only. 3. Information is subject to change without notice, at developer's absolute discretion. 4. Actual area may vary from the stated area. 5. Drawings not to scale. 6. All images used are for illustrative purpose only and do not represent the actual size, features, specifications, fittings, and finishings. 7. The developer reserves the right to make revisions / alterations, at its absolute discretion, without any liability whatsoever.





DUBAI CREEK  
HARBOUR

BREEZE AT  
CREEK BEACH

BUILDING 2

LEVEL 11(PENTHOUSE)

UNIT 1101

3 BEDROOM

APARTMENT AREA	145.26 SQ.M.	1563.57 SQ.FT.
BALCONY AREA	34.03 SQ.M.	366.30 SQ.FT.
TOTAL AREA	179.29 SQ.M.	1929.87 SQ.FT.



FLOOR PLAN 1. All dimensions are in imperial and metric, and measured from finish to finish excluding construction tolerances. 2.All materials, dimensions, and drawings are approximate only. 3. Information is subject to change without notice, at developer's absolute discretion. 4. Actual area may vary from the stated area. 5. Drawings not to scale. 6. All images used are for illustrative purpose only and do not represent the actual size, features, specifications, fittings, and finishings. 7. The developer reserves the right to make revisions / alterations, at its absolute discretion, without any liability whatsoever.



DUBAI CREEK  
HARBOUR

BREEZE AT  
CREEK BEACH

BUILDING 2  
LEVEL 11 (PENTHOUSE)

UNIT 1102

4 BEDROOM

APARTMENT AREA	188.70 SQ.M.	2031.15 SQ.FT.
BALCONY AREA	14.11 SQ.M.	151.88 SQ.FT.
TOTAL AREA	202.81 SQ.M.	2183.03 SQ.FT.

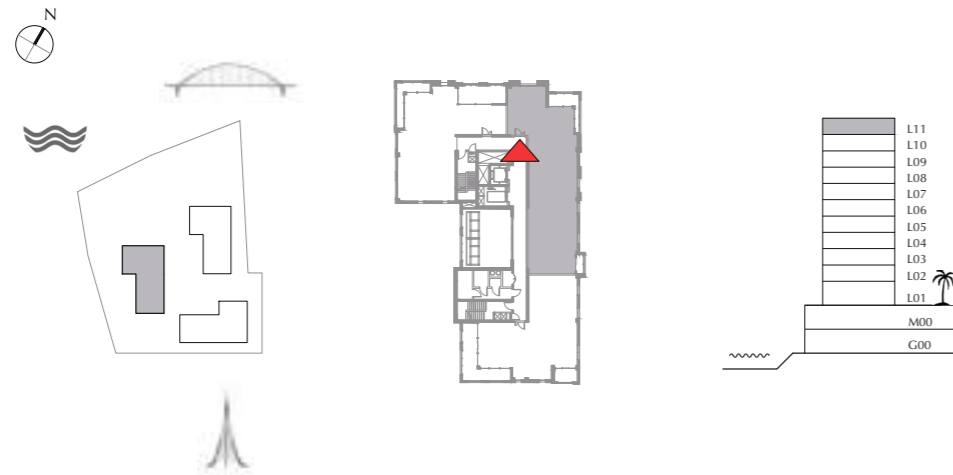

FLOOR PLAN 1. All dimensions are in imperial and metric, and measured from finish to finish excluding construction tolerances. 2. All materials, dimensions, and drawings are approximate only. 3. Information is subject to change without notice, at developer's absolute discretion. 4. Actual area may vary from the stated area. 5. Drawings not to scale. 6. All images used are for illustrative purpose only and do not represent the actual size, features, specifications, fittings, and furnishings. 7. The developer reserves the right to make revisions / alterations, at its absolute discretion, without any liability whatsoever.



DUBAI CREEK  
HARBOUR

BREEZE AT  
CREEK BEACH

BUILDING 2

LEVEL 11 (PENTHOUSE)

UNIT 1103

3 BEDROOM

APARTMENT AREA	153.76 SQ.M.	1655.06 SQ.FT.
BALCONY AREA	30.92 SQ.M.	332.82 SQ.FT.
TOTAL AREA	184.68 SQ.M.	1987.88 SQ.FT.

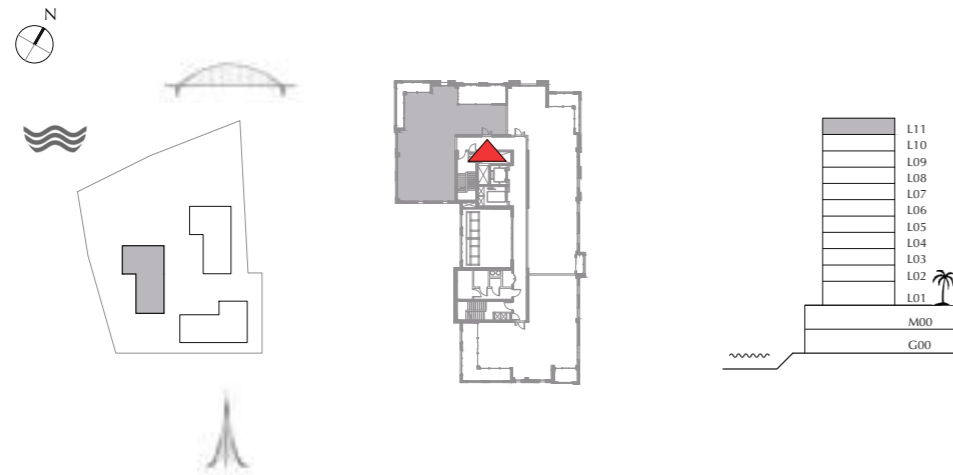

FLOOR PLAN 1. All dimensions are in imperial and metric, and measured from finish to finish excluding construction tolerances. 2. All materials, dimensions, and drawings are approximate only. 3. Information is subject to change without notice, at developer's absolute discretion. 4. Actual area may vary from the stated area. 5. Drawings not to scale. 6. All images used are for illustrative purpose only and do not represent the actual size, features, specifications, fittings, and finishings. 7. The developer reserves the right to make revisions / alterations, at its absolute discretion, without any liability whatsoever.

