



PREMIER ESTATES





11 THE RESIDENCES

33 THE MONOGRAM
COLLECTION

51 THE AUTOGRAPH
COLLECTION

69 THE SIGNATURE
COLLECTION

85 THE DETAILS

89 AN ELEVATED
LIFESTYLE

93 THE DRIVING
FORCE

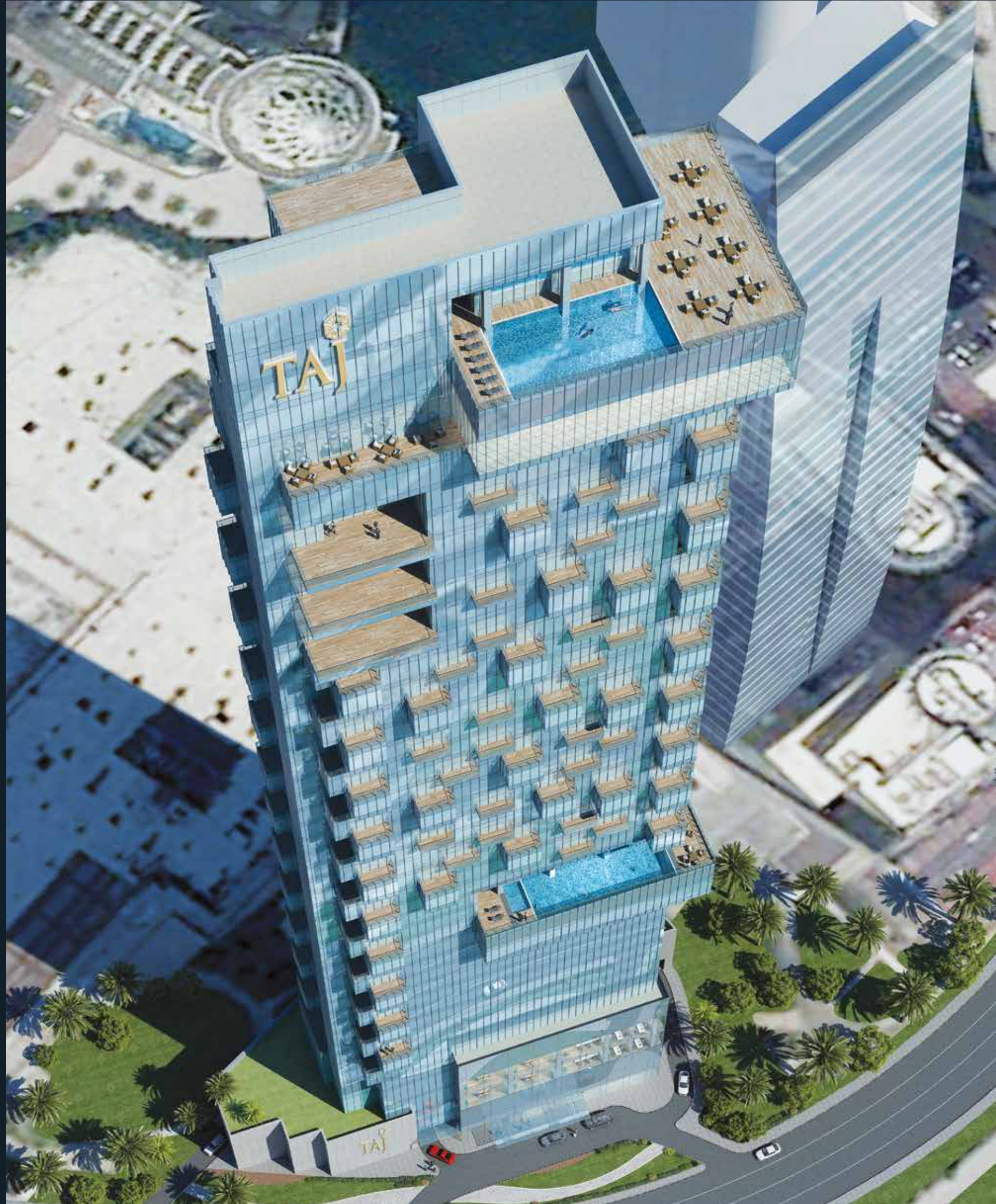

The Residences
JUMEIRAH LAKES TOWERS

Hallmarks of Exclusivity

A home is an expression of an individual's personality. Much like your fingerprint, The Residences at Jumeirah Lakes Towers are unique to you. The architecture and décor reflect your identity, a distinct signature like no one else. Each residence has a remarkably unique design and creates spaces that are as individual as you are.

AN ARCHITECTURAL MARVEL

The Residences at Jumeirah Lakes Towers, enjoying pride of place on the upper floors of the Taj hotel, feature a collection of 77 stylish abodes fittingly named Monogram, Autograph and Signature. A tribute to understated luxury and design that goes beyond convention, this fascinating superstructure features glass pods that extend outward offering a top-to-bottom view of the city.

Each apartment features a panoramic glass pod, sky terrace or balcony designed to amplify the stunning city views.

THE SIGNATURE COLLECTION

6 units in total - floors 37 to 42 which consist of 3 full floors of Penthouses on levels 37, 39 and 41 and one Signature 5 bedroom apartment (facing Sheikh Zayed Road, Dubai Marina and Jumeirah Beach Residences) on floor 38, 40 and 42 each.

THE AUTOGRAPH COLLECTION

21 units in total - of which 18 units are located on level 31 to 36 (each floor has only three units), six floors with 3/4/5 bedroom apartments with an average size 3 bedroom of 280 sqm & average size 4/5 bedrooms of 406.37 sqm. Balance 3 units are located on level 38, 40 & 42 with a 3 bedroom apartment on each floor (facing Emirates Hills & JLT Lake) with an average size of 283.63 sqm.

THE MONOGRAM COLLECTION

53 units in total - floors 20 to 30, 11 floors with 2 & 3 bedroom apartments with an average size of 2 bedrooms of 139.2 sqm & 3 bedrooms of 226 sqm. One floor has 3 units and the remaining ten floors have 5 units.

TAJ

With 100 hotels in 62 locations across India, Taj offers guests the refined luxury of heritage combined with effortlessly efficient service and local expertise to create a moment to remember. In India, Taj hotels are strategically located to offer the Taj experience in business hubs, industrial towns and metropolises, as well as the most remote pilgrimage centres, historic and natural destinations. The group has extended its international presence with 15 hotels in the Maldives, Malaysia, the UK, USA, Bhutan, Sri Lanka, Africa and the Middle East.

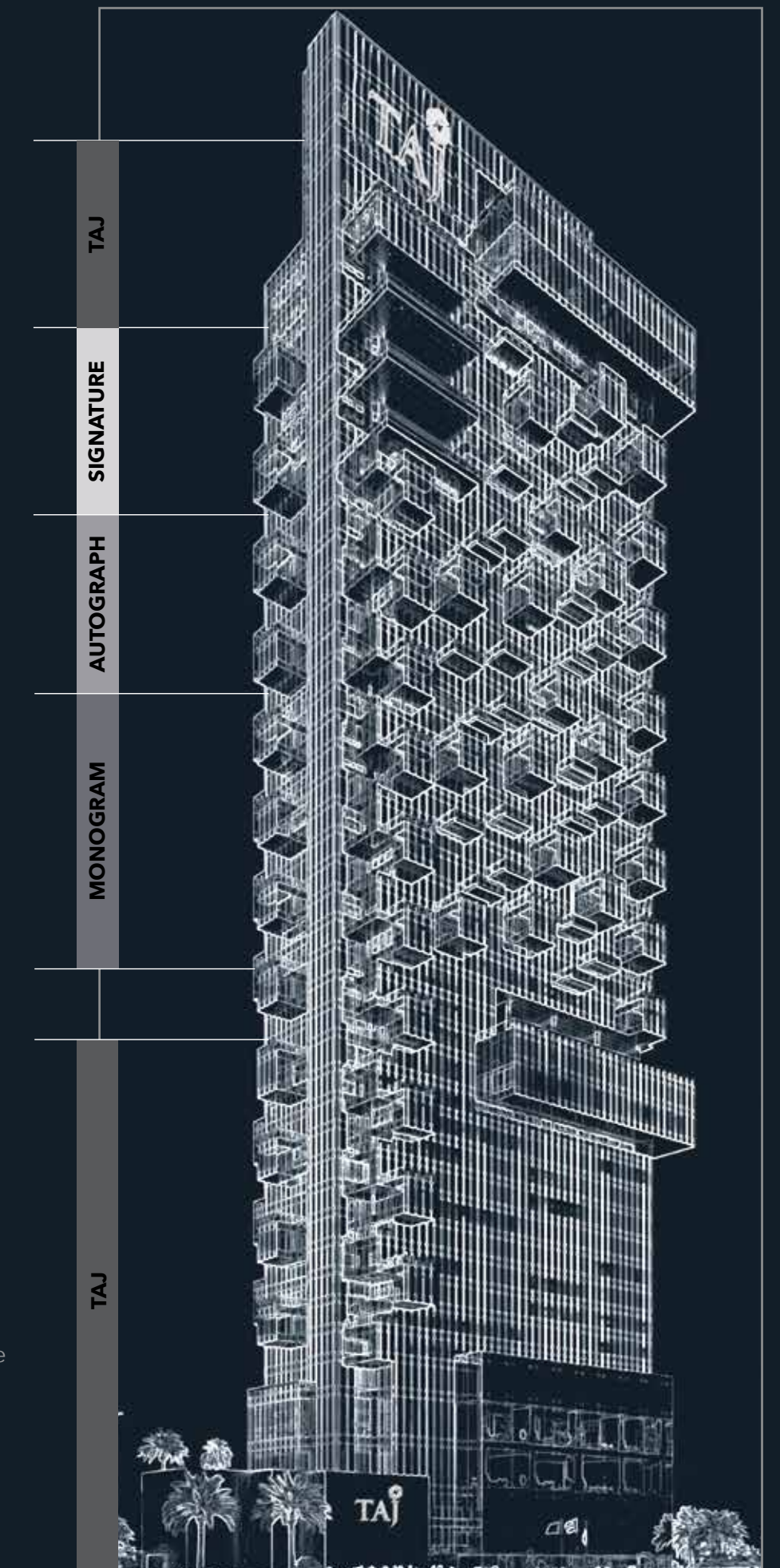

AN ELATED URBAN LIFESTYLE

An urban marvel where nothing fails to impress and the awe-inspiring awaits at every turn, Dubai is the city of the future. Holding its own in this vibrant emirate is the stylish neighbourhood of Jumeirah Lakes Towers, offering residents the best of both worlds - connectivity and serenity.



AN ENVIABLE LOCATION

The welcoming neighbourhood offers connectivity through Sheikh Zayed Road and Sheikh Mohammad bin Zayed Road, proximity to Dubai Marina, Jumeirah Beach Residence, Dubai Media City, Dubai Knowledge Village, Barsha Heights, and a great selection of dining venues. Stunning views of the lake and the remarkable Dubai skyline make Jumeirah Lakes Towers the perfect place to call home.

← MONTGOMERIE GOLF CLUB
EMIRATES HILLS
THE MEADOWS
THE LAKES

THE RESIDENCES

ALMAS TOWER

JLT CLUSTER X

DAMAC
METRO STATION

ADDRESS DUBAI MARINA
& DUBAI MARINA MALL

EMIRATES GOLF CLUB

JUMEIRAH BEACH
RESIDENCES

DUBAI MARINA



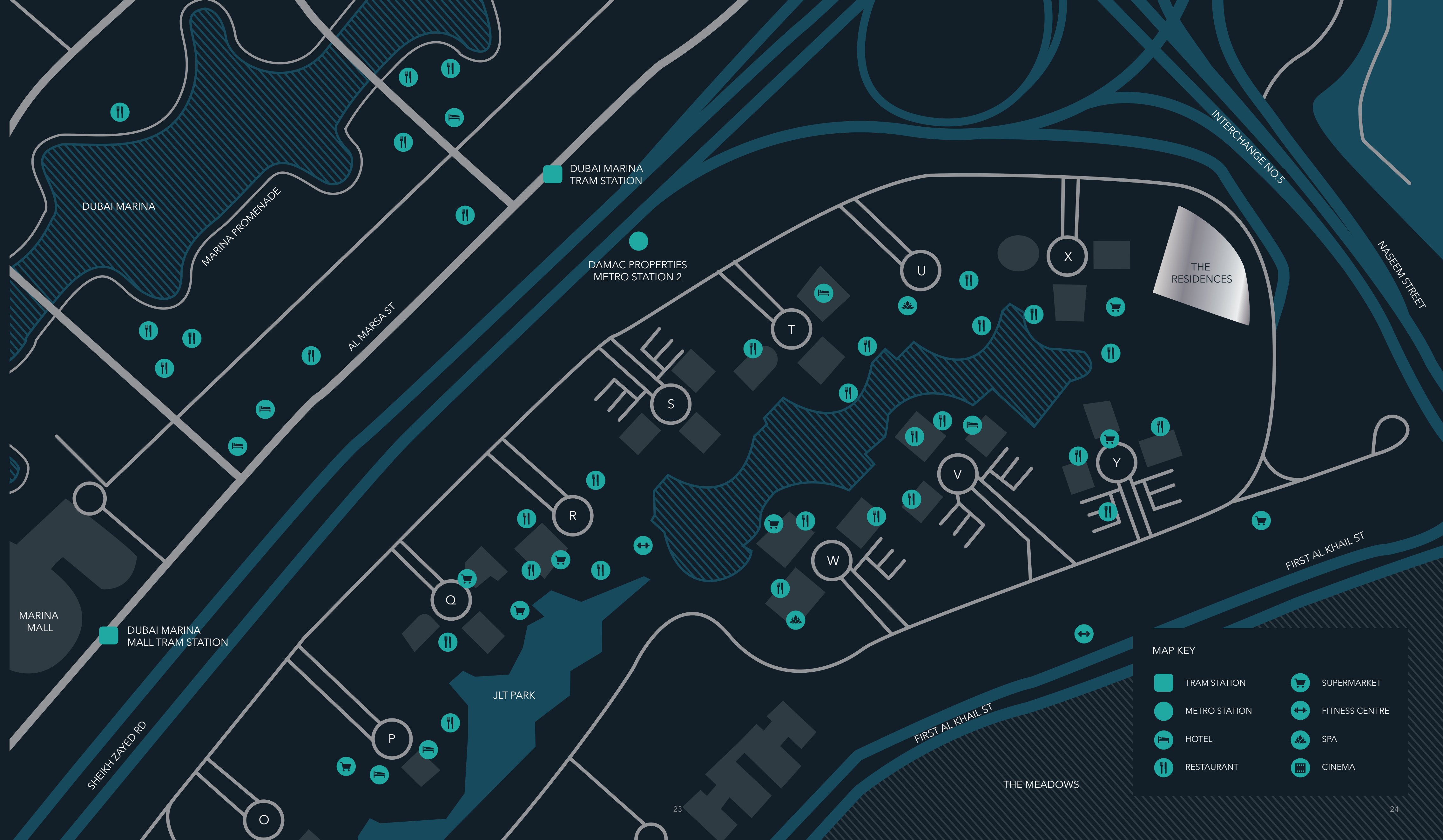

MAP KEY

	TRAM STATION		SUPERMARKET
	METRO STATION		FITNESS CENTRE
	HOTEL		SPA
	RESTAURANT		CINEMA



A SPECTACULAR PANORAMIC VIEW

Fringed by views of the lush Emirates Golf Club, The Montgomerie Dubai Golf Club, the glittering Dubai Marina and the calming waters of the lake, The Residences at Jumeirah Lakes Towers will enjoy a resplendent view in all directions. Large windows, balconies and glass viewing pods maximise each residence's view of the glorious surroundings.

NORTH



Sheikh Zayed Road, Emirates Golf Club, Burj Khalifa

SOUTH



Jumeirah Lakes Towers, the lake at JLT, Abu Dhabi

EAST

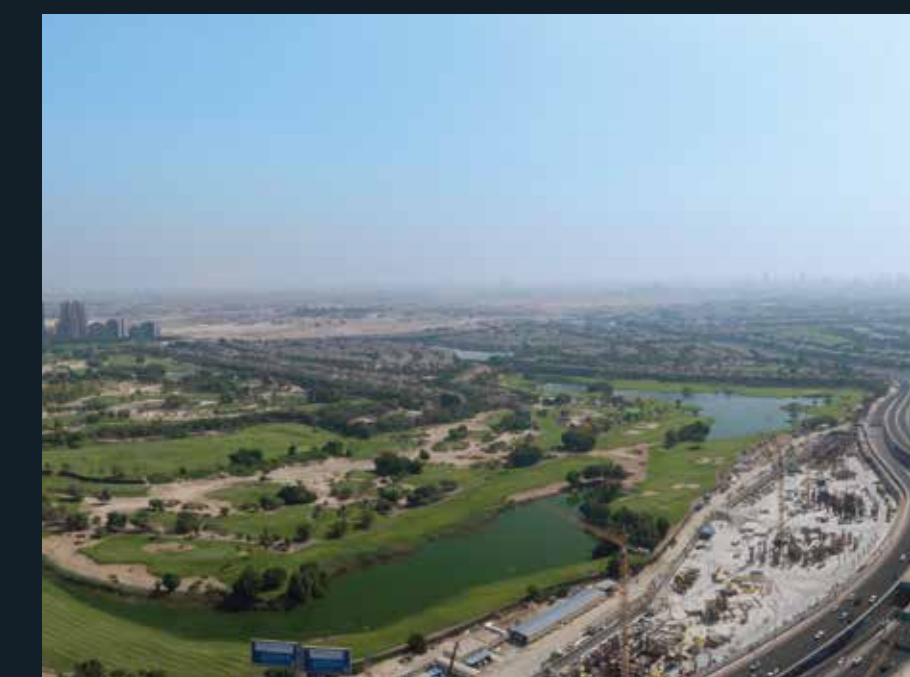

Emirates Hills, The Meadows, Montgomerie Golf Club

WEST



Dubai Marina, Jumeirah Beach Residences

- PARK
- LAKE
- RESTAURANTS
- DUBAI MARINA MALL
- MARINA WALK
- DUBAI MEDIA CITY
- DUBAI INTERNET CITY
- KNOWLEDGE VILLAGE
- AL ZAHRA HOSPITAL
- JUMEIRAH BEACH RESIDENCES
- JBR BEACH
- DUBAI INTERNATIONAL MARINE CLUB
- EMIRATES GOLF CLUB
- MONTGOMERIE GOLF CLUB
- PALM JUMEIRAH
- IBN BATTUTA MALL
- DUBAI SPORTS CITY
- SOUK MADINAT JUMEIRAH
- SAUDI GERMAN HOSPITAL
- MALL OF THE EMIRATES
- SKI DUBAI
- WILD WADI WATERPARK
- ARABIAN RANCHES
- DUBAI OFFSHORE SAILING CLUB
- DUBAI POLO & EQUESTRIAN CLUB
- JEBEL ALI RACE COURSE
- THE DUBAI MALL
- DOWNTOWN DUBAI
- JEBEL ALI SHOOTING CLUB
- MEYDAN RACE COURSE
- DUBAI FESTIVAL CITY
- DUBAI INTERNATIONAL AIRPORT
- DUBAI CREEK GOLF & YACHT CLUB



THE PLEASURES OF LUXURY

Attention to your every need and maintaining your sense of privacy is our highest priority. The Residences at Jumeirah Lakes Towers offer an intuitive valet service, a well-trained on-site maintenance team, a concierge and round-the-clock security. Dedicated underground parking with bays designed to hold large vehicles offers additional convenience.



A SUBLIME ARRIVAL

An aesthetically designed lobby will set the tone for your delightful journey to the spacious residences. Abstract art adorns the walls, adding an interesting artistic flair.

A BENCHMARK FOR INSPIRED LIFESTYLES

Articulate expressions of contemporary design define each of the 53 handsomely-appointed 2 and 3-bedroom Monogram Residences. Located between floors 20 to 30, with 5 apartments per floor, each of these spaces are amongst the largest of their kind in Dubai.

Bathed in abundant natural light and offering expansive terraces, Monogram Residences are uncluttered oases of calm and comfort.



A TRIBUTE TO INNOVATIVE LIVING

Meticulous attention to detail is evident at every space within the Monogram Residence. Ambient lighting, marble floors and avant-garde technology create living spaces that are ideal for entertaining and relaxation.



ELEGANCE IS IN THE DETAILS

Framed by large panoramic floor-to-ceiling windows that open up to views of Jumeirah Lakes Towers, Emirates Hills, Dubai Marina and Downtown Dubai, the living room offers a perfect balance of warmth and tasteful luxury. These residences feature 3 metre clear ceiling heights, three-sided open balconies and terraces, as well as extraordinary glass pods that extend out of the building to offer the exclusivity of a private viewing deck floating above the city.



A COVE OF RELAXATION

Smooth finishes, clean lines and ergonomic interiors define each of the three-bedroom Monogram Residences. The master bedroom spans to 26 sqm and ensuite bedrooms between 18 and 23 sqm each. Remarkably spacious, the bedrooms are equipped with well-appointed bathrooms and flexible storage spaces that make every day extraordinary.



CURATED CULINARY EXPRESSIONS

Incredible Italian designs with European appliances celebrate the various elements of the kitchen and allow easy access to everyday utilities, tucked away neatly in the wood veneer and glass cabinetry. Transparent glass-front shelves and metallic edging on the wood adds a stylish touch. Modern quartz stone adorns the kitchen countertops offering a clean and contemporary look. Ample natural light floods in through large full-length windows which open up to a dramatic view of the city, making it the perfect family kitchen.





A BESPOKE OASIS

Kohler fittings, stunning faucets, remarkable fine-quality marble and a statement bathtub transform the bathroom within the Monogram Residences into a stylish retreat worthy of your time and attention. The abundance of space is enhanced by colossal integrated vanity mirrors that adorn the bathroom and the separate standing shower. A separate closet and indulgent powder room are designed to pamper.

THE DETAILS

Interior Finishes

- Meticulously designed contemporary details
- Plush marble floors
- Expansive floor-to-ceiling windows
- Unique three-sided open balconies and terraces
- Extraordinary glass pods extending out of the building

Kitchens

- Latest integrated gas with oven, refrigerator and dishwasher
- Modern and stylish quartz stone countertops
- Minimalistic wood veneer and glass cabinets

Bathrooms

- Kohler fittings
- Large integrated vanity mirrors
- Elegant marble floors



FLOOR 20

UNITS 1-5 / 2 & 3 BEDROOM



*Example floorplan for illustrative purposes only

A HIDEAWAY DEFINED BY EXCELLENCE

Remarkably expansive and delightfully well-lit, the 3, 4 and 5-bedroom Autograph Residences invite you to create memories that match the charm and exuberance of Dubai.

Extending across floors 31 to 36, with 3 units per floor and 3 units of 3 bedrooms on floors 38, 40 & 42, each of the 21 spectacular residences offer ultimate indulgence, highlighted through patterned marble floors, contemporary details, three-sided open balconies, terraces and extraordinary glass pods which extend out of the building.

THE QUINTESSENCE OF LUXE LIVING

Bathed in muted hues of grey and brown, the living room is a blend of cosmopolitan flair and classic accents. An organic colour palette grounds the space, creating intimate sophistication.





MORE THAN WHAT MEETS THE EYE

Inviting in generous natural light, dramatic landscape windows frame the cityscape, creating a harmonious transition from indoors to outdoors. Every nook of the residences exudes an ambience that beautifully reflects individuality. Spacious living and dining areas create ideal spaces for entertainment.

ELEGANT URBAN ALCOVE

Minimalism is the theme that runs across the bedrooms at the Autograph Residence. Soft ambient light, subtle textures and a sense of calm envelop each of the master bedrooms which are an average size of 26 sqm and ensuite bedrooms with an average size of between 19 and 24 sqm. The spacious rooms can also accommodate workstations and lounge areas, while floor-to-ceiling windows stand as grand gestures in the bedroom.





CHARACTERFUL CULINARY STATIONS

A space filled with a textural blend of classic and contemporary, the kitchen is designed to simplify the everyday. Quality and functionality take precedence, which is highlighted through thoughtfully designed cabinetry and integrated European appliances such as refrigerator, dishwasher and gas with oven. Modern quartz stone countertops allow for an integrated sink in the same material for a seamless look.

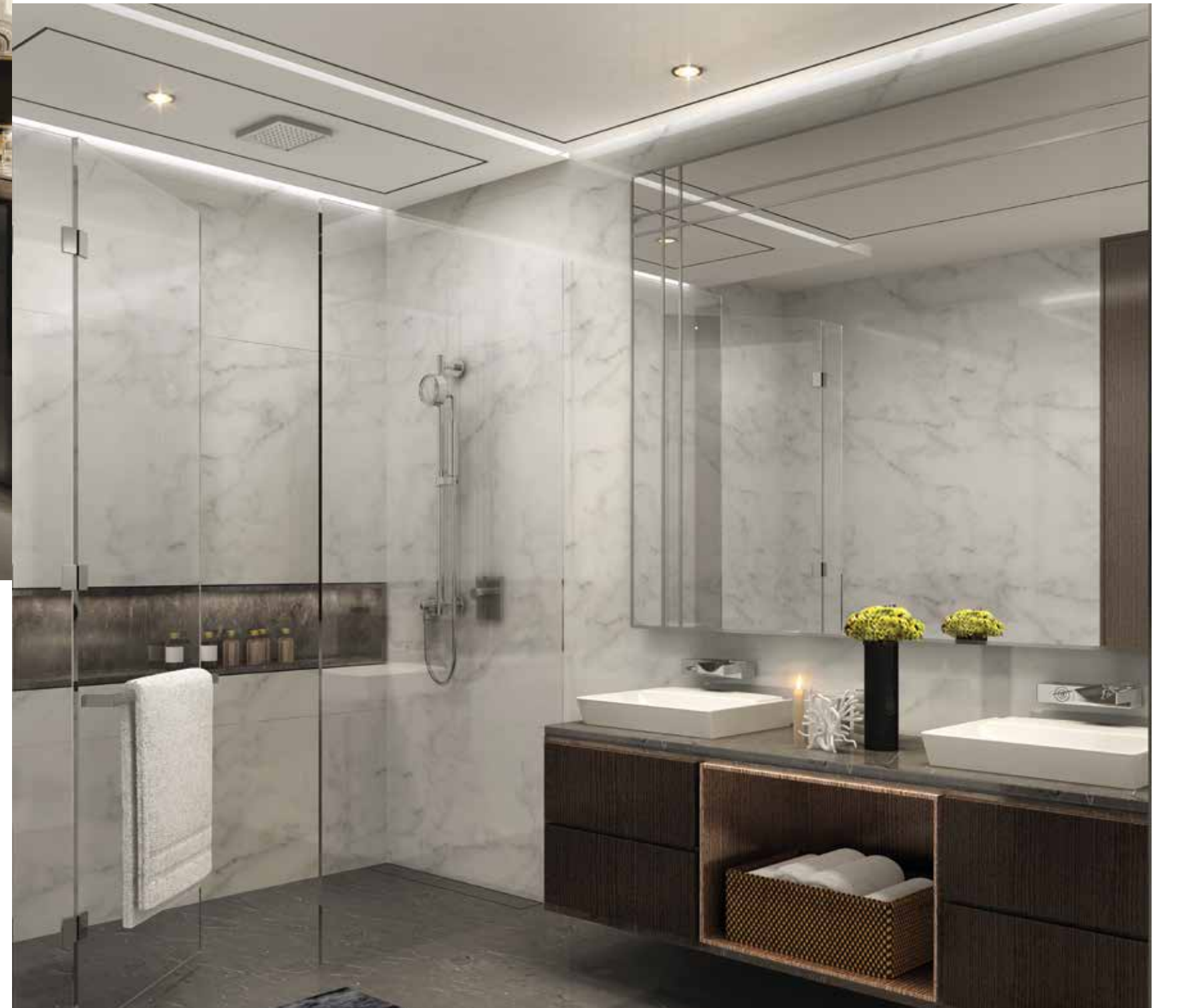

REFRESHING SUITE

Drawing inspiration from nature, the organic design infuses the opulent vanity space with a calming vibe. Smooth lines, fine marble and bespoke details add a touch of elegance, inspiring a feeling of self-indulgence in the midst of a fast-paced lifestyle. Large bathtubs and unique faucets make striking, sculptural installations that add a touch of exclusivity. A standalone powder room and an attached walk-in closet in the master bathroom complete the offering.

THE DETAILS

Interior Finishes

- Elegant contemporary design details
- Luxurious marble floors
- Expansive floor-to-ceiling windows
- Up to 3.4 metre clear ceiling height
- Unique three-sided open balconies and terraces
- Extraordinary glass pods extending out of the building

Kitchens

- Incredible Italian designs with European appliances
- Latest integrated gas with oven, refrigerator and dishwasher
- Modern quartz stone countertops
- Rich wood veneer and glass cabinets

Bathrooms

- Bathtub with an expansive marble deck
- Kohler fittings and designer accessories
- Unique selection of stones and finishes
- Large walk-in showers, with ceiling-mounted rain showers



FLOOR 31

UNITS 1-3 / 3 & 4 BEDROOM



*Example floorplan for illustrative purposes only

THE PINNACLE OF EXCLUSIVITY

Characterised by lifestyles of the urban, well-travelled citizens of today, the Signature Residences are remarkably spacious and offer sweeping views of the lush Emirates Hills neighbourhood and Dubai Marina.

With six expansive apartments having up to 3.6 metres of clear ceiling height, located on floors 37 to 42, these residences offer absolute privacy and the advantage of a breathtaking wraparound view. The bedrooms and family lounge are located in a more private side of the residence, while the large living and dining areas are ideal for entertainment.

A VIVACIOUS ENCLAVE

Enjoying an enviable location on the top floors of the tower, the Signature Residences exude an air of relaxed classiness. Clean-lined and inviting with a dash of glamour and comfort, the living room is ideal for relaxation and entertaining. Ceiling-high windows reveal awe-inspiring views of the city and create an undeniable sense of space.



A TRANQUIL HAVEN

Charming patterns bedeck the monochromatic palette in the bedrooms creating balance. Soft hues enhance the spaciousness and allow light to reflect within, evoking a sense of warmth and cheerful energy. The abundance of space allows for versatile, cosy sectional nooks in the master bedrooms such as a walk-in closet, intimate seating and a workstation.

THE SOUL OF THE HOME

This multi-functional space is designed to evolve the kitchen into the hub of your home and a treasured alcove that can be enjoyed by the whole family. Punctuated by beautiful counters that are not only functional but welcoming, the culinary nexus of the residences creates warmth and vibrancy. Bold metallic finishes sparkle against muted tones and nature-inspired textures. Avant-garde appliances by leading brands complete the offering.



A RELAXING HIDEAWAY

Intelligently designed, these vanity zones transform everyday rituals into fascinating sensorial experiences. Earthy tones set the mood for relaxation while integrated furniture pieces bring form and function to these stylish bathrooms. Attention to ergonomics as well as balance between beauty and efficiency elevate comfort and transform these bathing rooms into tranquil retreats. A separate powder room adds to the indulgence.



THE DETAILS

Interior Finishes

- Contemporary-themed interiors
- Richly detailed fittings
- Patterned marble floors
- Floor-to-ceiling windows
- Up to 3.6 metre clear ceiling height
- Three-sided open balconies and terraces
- Walk-in closets in two master bedrooms with wooden flooring
- Extraordinary glass pods extending out of the building

Kitchens

- Incredible Italian designs with European appliances
- Latest integrated gas with oven, refrigerator and dishwasher
- Separate washer and dryer
- Modern quartz stone countertops
- Free-standing kitchen island with feature lighting and display

Bathrooms

- Kohler fittings and designer accessories
- Nature-inspired rain showers
- Unique selection of marble for floors and walls
- Illuminated mirrors
- Separate powder room



FLOOR 39

UNITS 1-2 / 3 BEDROOM



*Example floorplan for illustrative purposes only

85

THE DETAILS



Lifestyle Facilities

- Exquisitely designed temperature-controlled swimming pool
- Fitness centre with steam room
- Yoga room
- Meditation room
- Two treatment rooms
- Large multi-purpose room for any kind of event
- Chic common space interiors
- Valet parking
- Round-the-clock maintenance crew

Electrical Fittings

- Concealed lighting in residences
- Concealed LED lighting fixtures throughout the building
- Ample telephone and data points connecting to principal reception rooms
- Home Automation System
- Central air-conditioning with temperature control panels in all areas

Security

- 24-hour reception and security services
- Access-controlled gated entrance
- Domestic sprinkler systems, fire alarms and smoke detectors
- 24-hour CCTV surveillance

Public Spaces

- Elevators with Destination Controlled System (DCS) for individual residences
- Bespoke floor designs in all corridors and public foyers
- Comfortable waiting areas for guests

The Residences

- Towering floor-to-ceiling windows
- Access to large terrace with glass barriers
- Combination of marble and wood finishes

Parking

- CCTV surveillance across all podiums
- Restricted access to parking bays





THE PATH TO RELAX AND ENERGISE

The need to unwind is imperative in today's fast-paced world. Encouraging the quality of life, residents will enjoy premium on-site recreational facilities including a fitness centre complete with sauna and steam room, a yoga room and two rooms for private massages and treatments. The multi-purpose room is ideal for intimate gatherings and celebrations. Evoking a sense of calm, the azure rooftop pool and bordering pool deck looks out at the picturesque skyline of this famed city of superlatives.



PREMIER ESTATES

Premier Estates, P03 Building 2, Bay Square, Business Bay, Dubai - UAE, ORN : 11814
Phone: +971 4 425 2780 Fax: +971 4 425 2601 Email: info@dubaipremierestates.com
www.dubaipremierestates.com





