



**Residence 2001**  
**MONOGRAM**

Floor 20

- 3 Bedrooms
- 3 Baths
- 1 Powder Room
- 1 Family Lounge



SALEABLE AREA	SQFT	SQM
Suite Area	2841.35	263.97
Balconies/Terraces Area	187.83	17.45
Total Area	3029.18	281.42

- DISCLAIMER:**
1. Proposed changes shall be implemented in compliance with the relevant authority requirements.
  2. All materials, dimensions and drawings are approximate. Information subject to change without notice.
  3. The Developer reserves the right to make revisions to the floor plans, finishes & amenities mentioned above.

*The Residences*  
JUMEIRAH LAKES TOWERS

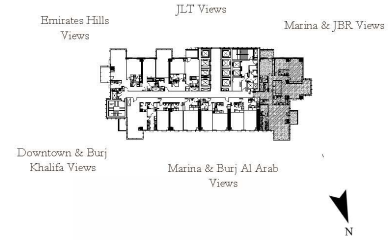

**Residence 2002**  
**MONOGRAM**

*The Residences*  
 JUMEIRAH LAKES TOWERS

Floor 20

- 3 Bedrooms
- 3 Baths
- 1 Powder Room



SALEABLE AREA	SQFT	SQM
Suite/Total Area	1749.03	162.49

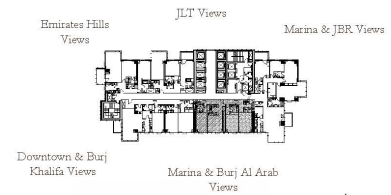

- DISCLAIMER:**
1. Proposed changes shall be implemented in compliance with the relevant authority requirements.
  2. All materials, dimensions and drawings are approximate. Information subject to change without notice.
  3. The Developer reserves the right to make revisions to the floor plans, finishes & amenities mentioned above.

**Residence 2003**  
MONOGRAM

*The Residences*  
JUMEIRAH LAKES TOWERS

Floor 20

3 Bedrooms  
3 Baths  
1 Powder Room



SALEABLE AREA	SQFT	SQM
Suite/Total Area	2345.46	217.9

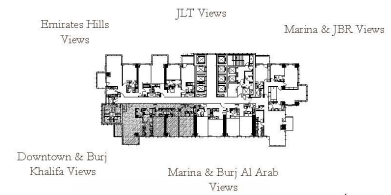

**DISCLAIMER:**

1. Proposed changes shall be implemented in compliance with the relevant authority requirements.
2. All materials, dimensions and drawings are approximate. Information subject to change without notice.
3. The Developer reserves the right to make revisions to the floor plans, finishes & amenities mentioned above.



**Residence 2004**  
**MONOGRAM**

*The Residences*  
JUMEIRAH LAKES TOWERS

Floor 20

- 2 Bedrooms
- 2 Baths
- 1 Powder Room



SALEABLE AREA	SQFT	SQM
Suite Area	1515.13	140.76
Balconies/Terraces Area	121.52	11.29
Total Area	1636.65	152.05

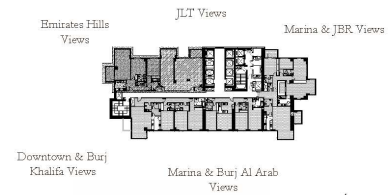

**DISCLAIMER:**

1. Proposed changes shall be implemented in compliance with the relevant authority requirements.
2. All materials, dimensions and drawings are approximate. Information subject to change without notice.
3. The Developer reserves the right to make revisions to the floor plans, finishes & amenities mentioned above.

**Residence 2005**  
**MONOGRAM**

*The Residences*  
JUMEIRAH LAKES TOWERS

Floor 20

- 2 Bedrooms
- 2 Baths
- 1 Powder Room



SALEABLE AREA	SQFT	SQM
Suite Area	1419.44	131.87
Balconies/Terraces Area	88.48	8.22
Total Area	1507.92	140.09

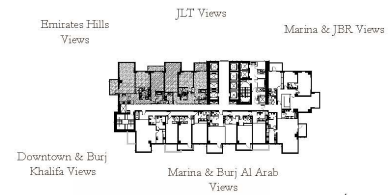

**DISCLAIMER:**

1. Proposed changes shall be implemented in compliance with the relevant authority requirements.
2. All materials, dimensions and drawings are approximate. Information subject to change without notice.
3. The Developer reserves the right to make revisions to the floor plans, finishes & amenities mentioned above.

**Residence 2101**  
**MONOGRAM**

Floor 21

- 3 Bedrooms
- 3 Baths
- 1 Powder Room
- 1 Family Lounge



*The Residences*  
JUMEIRAH LAKES TOWERS

SALEABLE AREA	SQFT	SQM
Suite Area	2588.18	240.45
Balconies/Terraces Area	321.3	29.85
Total Area	2909.48	270.30

**DISCLAIMER:**

1. Proposed changes shall be implemented in compliance with the relevant authority requirements.
2. All materials, dimensions and drawings are approximate. Information subject to change without notice.
3. The Developer reserves the right to make revisions to the floor plans, finishes & amenities mentioned above.

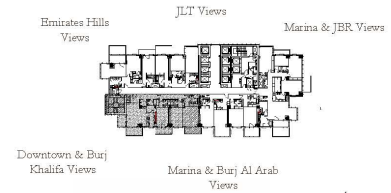

0 1.0 2.0 3.0 4.0m

**Residence 2102**  
MONOGRAM

*The Residences*  
JUMEIRAH LAKES TOWERS

Floor 21

- 3 Bedrooms
- 3 Baths
- 1 Powder Room

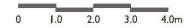

SALEABLE AREA	SQFT	SQM
Suite Area	1759.68	163.48
Balconies/Terraces Area	92.46	8.59
Total Area	1852.14	172.07

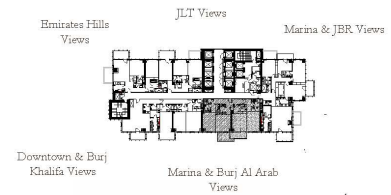

**DISCLAIMER:**

1. Proposed changes shall be implemented in compliance with the relevant authority requirements.
2. All materials, dimensions and drawings are approximate. Information subject to change without notice.
3. The Developer reserves the right to make revisions to the floor plans, finishes & amenities mentioned above.

**Residence 2103**  
MONOGRAM

*The Residences*  
JUMEIRAH LAKES TOWERS

Floor 21

- 3 Bedrooms
- 3 Baths
- 1 Powder Room



SALEABLE AREA	SQFT	SQM
Suite Area	2438.46	226.54
Balconies/Terraces Area	111.08	10.32
Total Area	2549.54	236.86

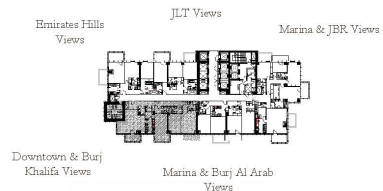

- DISCLAIMER:**
1. Proposed changes shall be implemented in compliance with the relevant authority requirements.
  2. All materials, dimensions and drawings are approximate. Information subject to change without notice.
  3. The Developer reserves the right to make revisions to the floor plans, finishes & amenities mentioned above.

**Residence 2104**  
**MONOGRAM**

*The Residences*  
JUMEIRAH LAKES TOWERS

Floor 21

- 2 Bedrooms
- 2 Baths
- 1 Powder Room



SALEABLE AREA	SQFT	SQM
Suite Area	1373.58	127.61
Balconies/Terraces Area	127.98	11.89
Total Area	1501.56	139.50

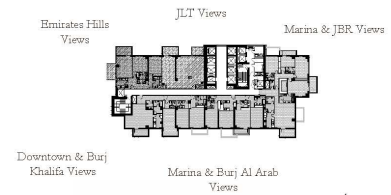

**DISCLAIMER:**

1. Proposed changes shall be implemented in compliance with the relevant authority requirements.
2. All materials, dimensions and drawings are approximate. Information subject to change without notice.
3. The Developer reserves the right to make revisions to the floor plans, finishes & amenities mentioned above.

**Residence 2105**  
**MONOGRAM**

*The Residences*  
 JUMEIRAH LAKES TOWERS

Floor 21

- 2 Bedrooms
- 2 Baths
- 1 Powder Room



SALEABLE AREA	SQFT	SQM
Suite Area	1279.94	118.91
Balconies/Terraces Area	126.05	11.71
Total Area	1405.99	130.62

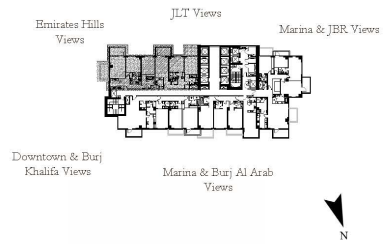

**DISCLAIMER:**

1. Proposed changes shall be implemented in compliance with the relevant authority requirements.
2. All materials, dimensions and drawings are approximate. Information subject to change without notice.
3. The Developer reserves the right to make revisions to the floor plans, finishes & amenities mentioned above.



**Residence 2201**  
**MONOGRAM**

Floor 22

- 3 Bedrooms
- 3 Baths
- 1 Powder Room
- 1 Family Lounge

SALEABLE AREA	SQFT	SQM
Suite Area	2710.89	251.85
Balconies/Terraces Area	97.41	9.05
Total Area	2808.30	260.90

- DISCLAIMER:**
1. Proposed changes shall be implemented in compliance with the relevant authority requirements.
  2. All materials, dimensions and drawings are approximate. Information subject to change without notice.
  3. The Developer reserves the right to make revisions to the floor plans, finishes & amenities mentioned above.

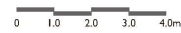
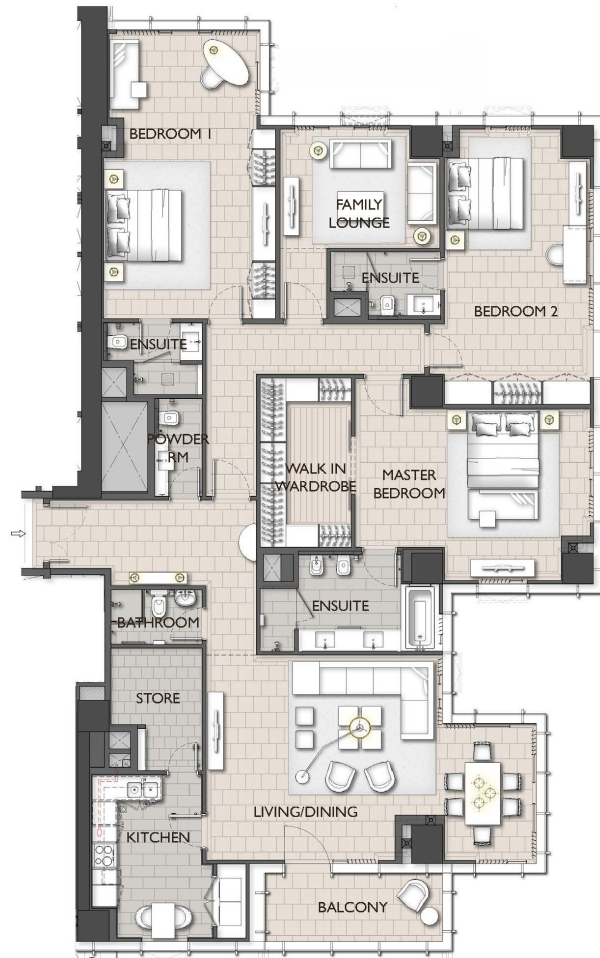

*The Residences*  
JUMEIRAH LAKES TOWERS

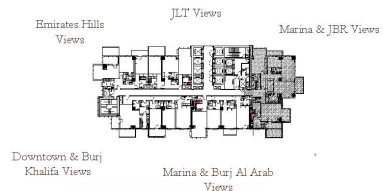

**Residence 2202**  
**MONOGRAM**

*The Residences*  
JUMEIRAH LAKES TOWERS

Floor 22

- 3 Bedrooms
- 3 Baths
- 1 Powder Room

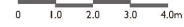

SALEABLE AREA	SQFT	SQM
Suite Area	1896.92	176.23
Balconies/Terraces Area	92.46	8.59
Total Area	1989.38	184.82

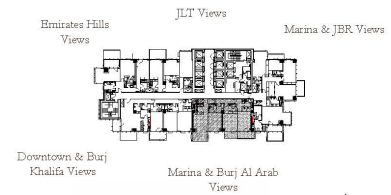

**DISCLAIMER:**

1. Proposed changes shall be implemented in compliance with the relevant authority requirements.
2. All materials, dimensions and drawings are approximate. Information subject to change without notice.
3. The Developer reserves the right to make revisions to the floor plans, finishes & amenities mentioned above.

**Residence 2203**  
**MONOGRAM**

*The Residences*  
JUMEIRAH LAKES TOWERS

Floor 22

- 3 Bedrooms
- 3 Baths
- 1 Powder Room



SALEABLE AREA	SQFT	SQM
Suite Area	2208.43	205.17
Balconies/Terraces Area	199.46	18.53
Total Area	2407.89	223.7

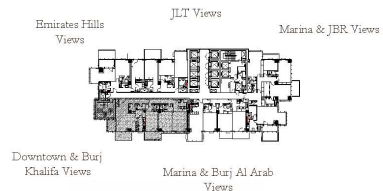

- DISCLAIMER:**
1. Proposed changes shall be implemented in compliance with the relevant authority requirements.
  2. All materials, dimensions and drawings are approximate. Information subject to change without notice.
  3. The Developer reserves the right to make revisions to the floor plans, finishes & amenities mentioned above.

**Residence 2204**  
**MONOGRAM**

*The Residences*  
JUMEIRAH LAKES TOWERS

Floor 22

- 2 Bedrooms
- 2 Baths
- 1 Powder Room

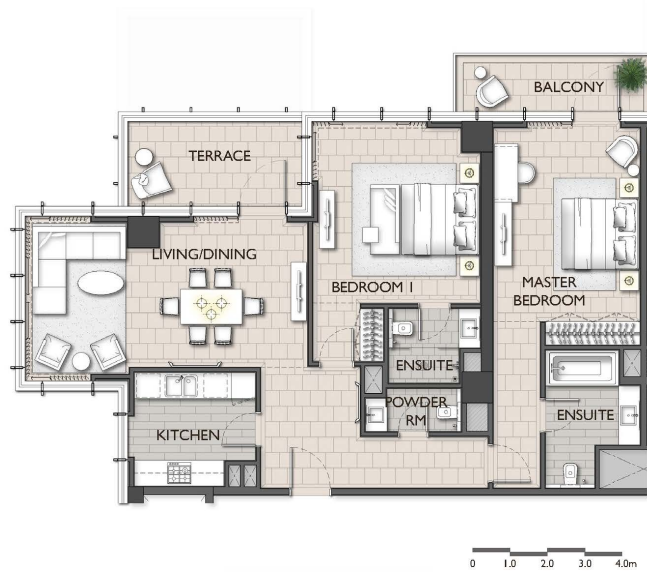

SALEABLE AREA	SQFT	SQM
Suite Area	1377.13	127.94
Balconies/Terraces Area	197.63	18.36
Total Area	146.30	1574.76

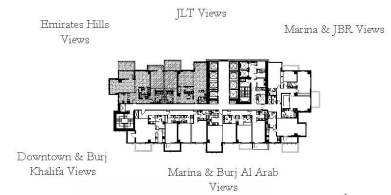

**DISCLAIMER:**

1. Proposed changes shall be implemented in compliance with the relevant authority requirements.
2. All materials, dimensions and drawings are approximate. Information subject to change without notice.
3. The Developer reserves the right to make revisions to the floor plans, finishes & amenities mentioned above.

**Residence 2205**  
**MONOGRAM**

*The Residences*  
 JUMEIRAH LAKES TOWERS

Floor 22

- 2 Bedrooms
- 2 Baths
- 1 Powder Room



SALEABLE AREA	SQFT	SQM
Total Suite Area	1393.50	129.46

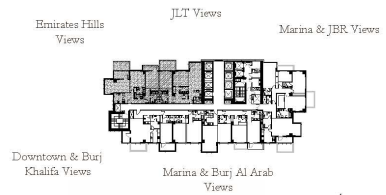

- DISCLAIMER:**
1. Proposed changes shall be implemented in compliance with the relevant authority requirements.
  2. All materials, dimensions and drawings are approximate. Information subject to change without notice.
  3. The Developer reserves the right to make revisions to the floor plans, finishes & amenities mentioned above.

# Residence 2301 MONOGRAM

Floor 23

- 4 Bedrooms
- 4 Baths
- 1 Powder Room
- 1 Family Lounge



*The Residences*  
JUMEIRAH LAKES TOWERS

SALEABLE AREA	SQFT	SQM
Suite Area	2848.99	264.68
Balconies/Terraces Area	190.84	17.73
Total Area	3039.83	282.41

**DISCLAIMER:**

1. Proposed changes shall be implemented in compliance with the relevant authority requirements.
2. All materials, dimensions and drawings are approximate. Information subject to change without notice.
3. The Developer reserves the right to make revisions to the floor plans, finishes & amenities mentioned above.

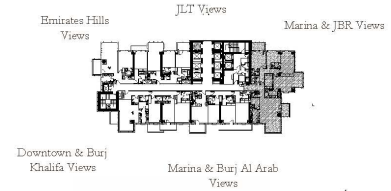

**Residence 2302**  
**MONOGRAM**

*The Residences*  
 JUMEIRAH LAKES TOWERS

Floor 23

- 3 Bedrooms
- 3 Baths
- 1 Powder Room



SALEABLE AREA	SQFT	SQM
Suite Area	1767.33	164.19
Balconies/Terraces Area	218.51	20.30
Total Area	1985.84	184.49

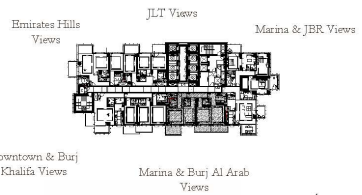

- DISCLAIMER:**
1. Proposed changes shall be implemented in compliance with the relevant authority requirements.
  2. All materials, dimensions and drawings are approximate. Information subject to change without notice.
  3. The Developer reserves the right to make revisions to the floor plans, finishes & amenities mentioned above.



**Residence 2303**  
MONOGRAM

*The Residences*  
JUMEIRAH LAKES TOWERS

Floor 23

- 3 Bedrooms
- 3 Baths
- 1 Powder Room

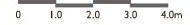

SALEABLE AREA	SQFT	SQM
Suite Area	2332.22	216.67
Balconies/Terraces Area	92.46	8.59
Total Area	2424.68	225.26

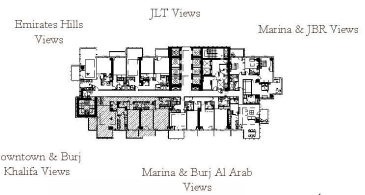

**DISCLAIMER:**

1. Proposed changes shall be implemented in compliance with the relevant authority requirements.
2. All materials, dimensions and drawings are approximate. Information subject to change without notice.
3. The Developer reserves the right to make revisions to the floor plans, finishes & amenities mentioned above.

**Residence 2304**  
**MONOGRAM**

*The Residences*  
 JUMEIRAH LAKES TOWERS

Floor 23

- 2 Bedrooms
- 2 Baths
- 1 Powder Room



SALEABLE AREA	SQFT	SQM
Suite Area	1515.13	140.76
Balconies/Terraces Area	120.99	11.24
Total Area	1636.12	152.00

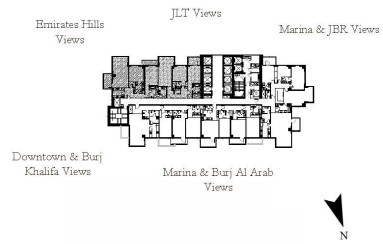

- DISCLAIMER:**
1. Proposed changes shall be implemented in compliance with the relevant authority requirements.
  2. All materials, dimensions and drawings are approximate. Information subject to change without notice.
  3. The Developer reserves the right to make revisions to the floor plans, finishes & amenities mentioned above.

**Residence 2305**  
**MONOGRAM**

*The Residences*  
JUMEIRAH LAKES TOWERS

Floor 23

- 2 Bedrooms
- 2 Baths
- 1 Powder Room



SALEABLE AREA	SQFT	SQM
Suite Area	1419.54	131.88
Balconies/Terraces Area	88.48	8.22
Total Area	1508.02	140.10

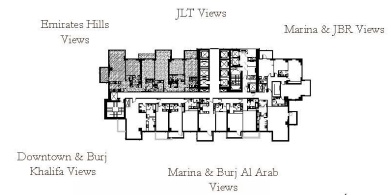

**DISCLAIMER:**

1. Proposed changes shall be implemented in compliance with the relevant authority requirements.
2. All materials, dimensions and drawings are approximate. Information subject to change without notice.
3. The Developer reserves the right to make revisions to the floor plans, finishes & amenities mentioned above.

# Residence 2401 MONOGRAM

Floor 24

- 3 Bedrooms
- 3 Baths
- 1 Powder Room
- 1 Family Lounge



*The Residences*  
JUMEIRAH LAKES TOWERS

SALEABLE AREA	SQFT	SQM
Suite Area	2620.15	243.42
Balconies/Terraces Area	321.30	29.85
Total Area	2941.45	273.27

**DISCLAIMER:**

1. Proposed changes shall be implemented in compliance with the relevant authority requirements.
2. All materials, dimensions and drawings are approximate. Information subject to change without notice.
3. The Developer reserves the right to make revisions to the floor plans, finishes & amenities mentioned above.

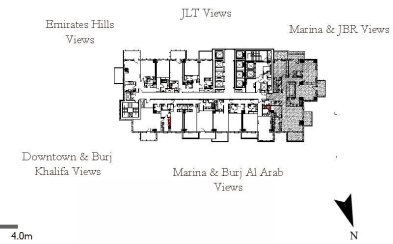

**Residence 2402**  
**MONOGRAM**

*The Residences*  
JUMEIRAH LAKES TOWERS

Floor 24

- 3 Bedrooms
- 3 Baths
- 1 Powder Room



SALEABLE AREA	SQFT	SQM
Total Suite Area	1863.13	173.09

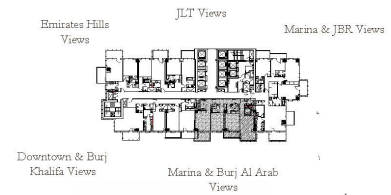

**DISCLAIMER:**

1. Proposed changes shall be implemented in compliance with the relevant authority requirements.
2. All materials, dimensions and drawings are approximate. Information subject to change without notice.
3. The Developer reserves the right to make revisions to the floor plans, finishes & amenities mentioned above.

**Residence 2403**  
MONOGRAM

*The Residences*  
JUMEIRAH LAKES TOWERS

Floor 24

- 3 Bedrooms
- 3 Baths
- 1 Powder Room



SALEABLE AREA	SQFT	SQM
Suite Area	2314.56	215.03
Balconies/Terraces Area	203.55	18.91
Total Area	2518.11	233.94

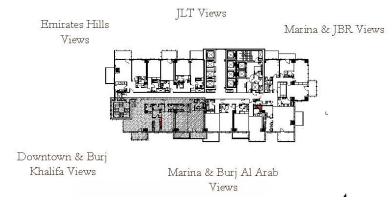

**DISCLAIMER:**

1. Proposed changes shall be implemented in compliance with the relevant authority requirements.
2. All materials, dimensions and drawings are approximate. Information subject to change without notice.
3. The Developer reserves the right to make revisions to the floor plans, finishes & amenities mentioned above.

**Residence 2404**  
**MONOGRAM**

*The Residences*  
 JUMEIRAH LAKES TOWERS

Floor 24

- 2 Bedrooms
- 2 Baths
- 1 Powder Room



SALEABLE AREA	SQFT	SQM
Suite Area	1373.58	127.61
Balconies/Terraces Area	127.98	11.89
Total Area	1501.56	139.50

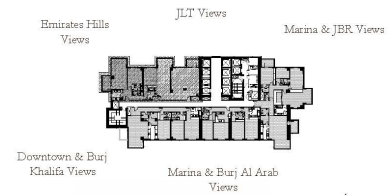

- DISCLAIMER:**
1. Proposed changes shall be implemented in compliance with the relevant authority requirements.
  2. All materials, dimensions and drawings are approximate. Information subject to change without notice.
  3. The Developer reserves the right to make revisions to the floor plans, finishes & amenities mentioned above.



**Residence 2405**  
**MONOGRAM**

*The Residences*  
JUMEIRAH LAKES TOWERS

Floor 24

- 2 Bedrooms
- 2 Baths
- 1 Powder Room



SALEABLE AREA	SQFT	SQM
Suite Area	1279.94	118.91
Balconies/Terraces Area	126.05	11.71
Total Area	1405.99	130.62

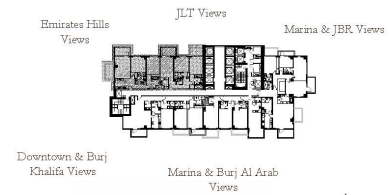

- DISCLAIMER:**
1. Proposed changes shall be implemented in compliance with the relevant authority requirements.
  2. All materials, dimensions and drawings are approximate. Information subject to change without notice.
  3. The Developer reserves the right to make revisions to the floor plans, finishes & amenities mentioned above.

**Residence 2501**  
**MONOGRAM**

Floor 25

- 3 Bedrooms
- 3 Baths
- 1 Powder Room
- 1 Family Lounge



SALEABLE AREA	SQFT	SQM
Suite Area	2700.88	250.92
Balconies/Terraces Area	97.31	9.04
Total Area	2798.19	259.96

**DISCLAIMER:**

1. Proposed changes shall be implemented in compliance with the relevant authority requirements.
2. All materials, dimensions and drawings are approximate. Information subject to change without notice.
3. The Developer reserves the right to make revisions to the floor plans, finishes & amenities mentioned above.

*The Residences*  
JUMEIRAH LAKES TOWERS

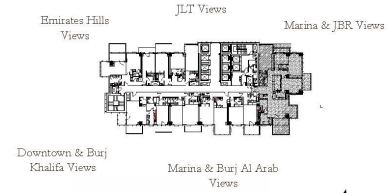

**Residence 2502**  
**MONOGRAM**

*The Residences*  
JUMEIRAH LAKES TOWERS

Floor 25

- 3 Bedrooms
- 3 Baths
- 1 Powder Room

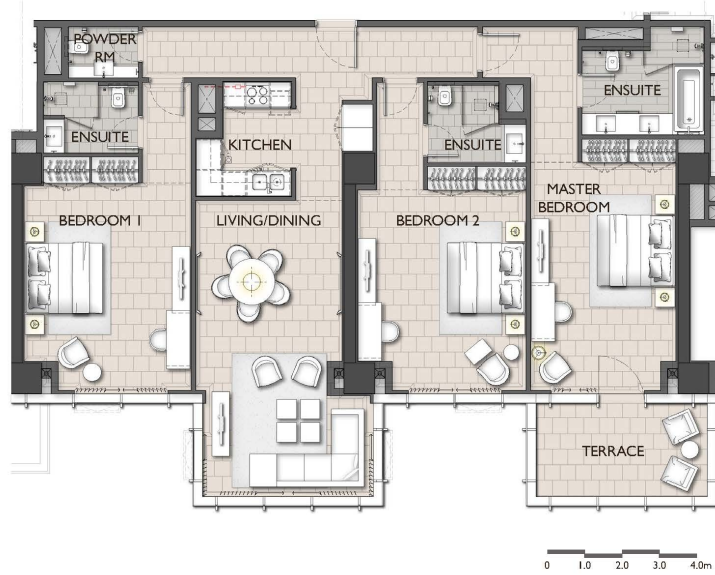

SALEABLE AREA	SQFT	SQM
Suite Area	1908.12	177.27
Balconies/Terraces Area	126.05	11.71
Total Area	2034.17	188.98

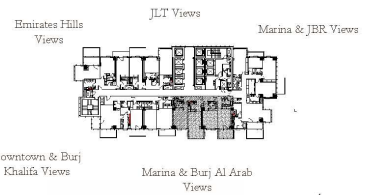

**DISCLAIMER:**

1. Proposed changes shall be implemented in compliance with the relevant authority requirements.
2. All materials, dimensions and drawings are approximate. Information subject to change without notice.
3. The Developer reserves the right to make revisions to the floor plans, finishes & amenities mentioned above.

**Residence 2503**  
MONOGRAM

*The Residences*  
JUMEIRAH LAKES TOWERS

Floor 25

- 3 Bedrooms
- 3 Baths
- 1 Powder Room



SALEABLE AREA	SQFT	SQM
Suite Area	2207.25	205.06
Balconies/Terraces Area	180.94	16.81
Total Area	2388.19	221.87

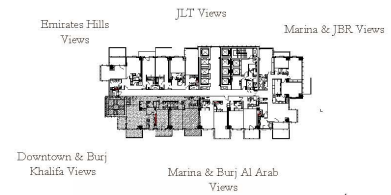

**DISCLAIMER:**

1. Proposed changes shall be implemented in compliance with the relevant authority requirements.
2. All materials, dimensions and drawings are approximate. Information subject to change without notice.
3. The Developer reserves the right to make revisions to the floor plans, finishes & amenities mentioned above.

# Residence 2504 MONOGRAM

Floor 25

- 2 Bedrooms
- 2 Baths
- 1 Powder Room

The Residences  
JUMEIRAH LAKES TOWERS



SALEABLE AREA	SQFT	SQM
Suite Area	1377.78	128.00
Balconies/Terraces Area	197.63	18.36
Total Area	1575.41	146.36

**DISCLAIMER:**

1. Proposed changes shall be implemented in compliance with the relevant authority requirements.
2. All materials, dimensions and drawings are approximate. Information subject to change without notice.
3. The Developer reserves the right to make revisions to the floor plans, finishes & amenities mentioned above.

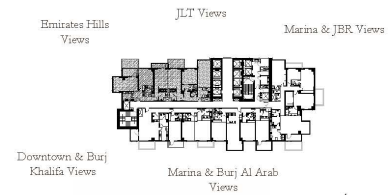

**Residence 2505**  
**MONOGRAM**

*The Residences*  
JUMEIRAH LAKES TOWERS

Floor 25

- 2 Bedrooms
- 2 Baths
- 1 Powder Room



SALEABLE AREA	SQFT	SQM
Total Suite Area	1392.63	129.38

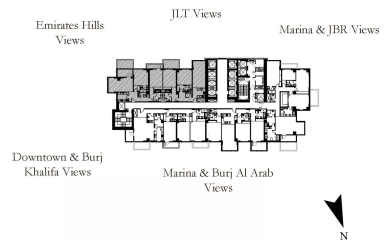

- DISCLAIMER:
- Proposed changes shall be implemented in compliance with the relevant authority requirements.
  - All materials, dimensions and drawings are approximate. Information subject to change without notice.
  - The Developer reserves the right to make revisions to the floor plans, finishes & amenities mentioned above.

# Residence 2601 MONOGRAM

Floor 26

- 3 Bedrooms
- 3 Baths
- 1 Powder Room
- 1 Family Lounge

SALEABLE AREA	SQFT	SQM
Suite Area	2858.46	265.56
Balconies/Terraces Area	190.84	17.73
Total Area	3049.30	283.29

- DISCLAIMER:**
1. Proposed changes shall be implemented in compliance with the relevant authority requirements.
  2. All materials, dimensions and drawings are approximate. Information subject to change without notice.
  3. The Developer reserves the right to make revisions to the floor plans, finishes & amenities mentioned above.

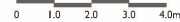
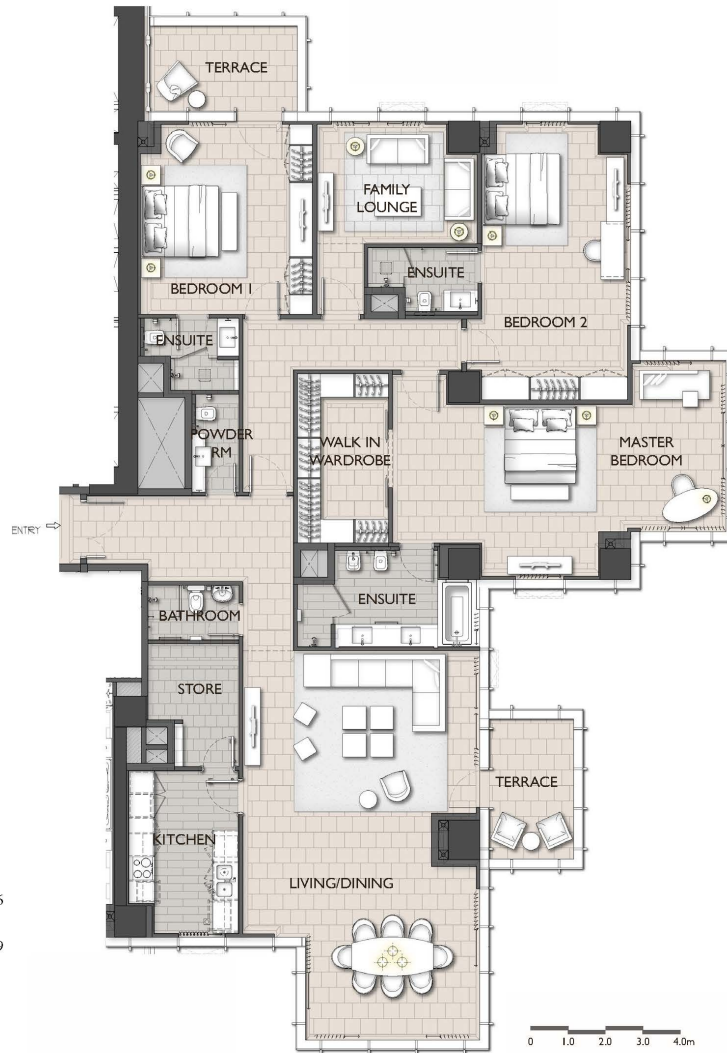

*The Residences*  
JUMEIRAH LAKES TOWERS

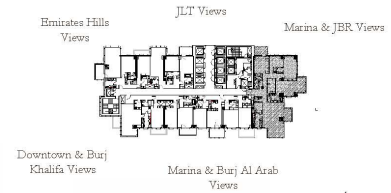



**Residence 2602**  
**MONOGRAM**

*The Residences*  
JUMEIRAH LAKES TOWERS

Floor 26

3 Bedrooms  
3 Baths  
1 Powder Room



SALEABLE AREA	SQFT	SQM
Suite Area	1756.89	163.22
Balconies/Terraces Area	126.05	11.71
Total Area	1882.94	174.93

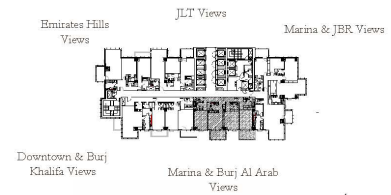

**DISCLAIMER:**

1. Proposed changes shall be implemented in compliance with the relevant authority requirements.
2. All materials, dimensions and drawings are approximate. Information subject to change without notice.
3. The Developer reserves the right to make revisions to the floor plans, finishes & amenities mentioned above.

**Residence 2603**  
MONOGRAM

*The Residences*  
JUMEIRAH LAKES TOWERS

Floor 26

- 3 Bedrooms
- 3 Baths
- 1 Powder Room



SALEABLE AREA	SQFT	SQM
Suite Area	2330.17	216.48
Balconies/Terraces Area	92.46	8.59
Total Area	2422.63	225.07

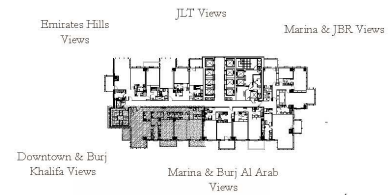

**DISCLAIMER:**

1. Proposed changes shall be implemented in compliance with the relevant authority requirements.
2. All materials, dimensions and drawings are approximate. Information subject to change without notice.
3. The Developer reserves the right to make revisions to the floor plans, finishes & amenities mentioned above.

# Residence 2604 MONOGRAM

The Residences  
JUMEIRAH LAKES TOWERS

## Floor 26

- 2 Bedrooms
- 2 Baths
- 1 Powder Room



SALEABLE AREA	SQFT	SQM
Suite Area	1514.59	140.71
Balconies/Terraces Area	120.99	11.24
Total Area	1635.58	151.95

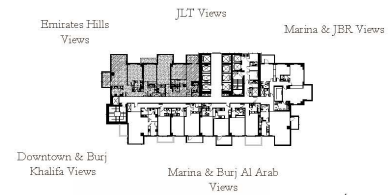

**DISCLAIMER:**

1. Proposed changes shall be implemented in compliance with the relevant authority requirements.
2. All materials, dimensions and drawings are approximate. Information subject to change without notice.
3. The Developer reserves the right to make revisions to the floor plans, finishes & amenities mentioned above.

**Residence 2605**  
**MONOGRAM**

*The Residences*  
 JUMEIRAH LAKES TOWERS

Floor 26

- 2 Bedrooms
- 2 Baths
- 1 Powder Room



SALEABLE AREA	SQFT	SQM
Suite Area	1419.11	131.84
Balconies/Terraces Area	88.48	8.22
Total Area	1507.59	140.06

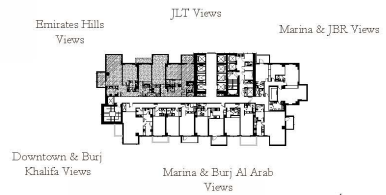

**DISCLAIMER:**

1. Proposed changes shall be implemented in compliance with the relevant authority requirements.
2. All materials, dimensions and drawings are approximate. Information subject to change without notice.
3. The Developer reserves the right to make revisions to the floor plans, finishes & amenities mentioned above.

**Residence 2701**  
**MONOGRAM**

Floor 27

- 3 Bedrooms
- 3 Baths
- 1 Powder Room
- 1 Family Lounge

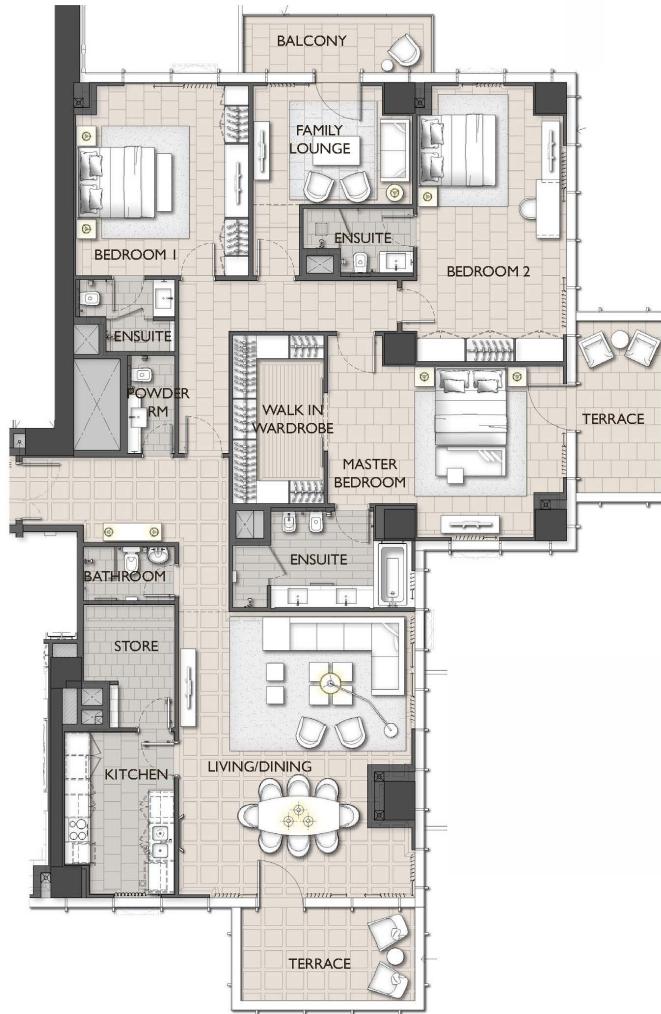

SALEABLE AREA	SQFT	SQM
Suite Area	2589.26	240.55
Balconies/Terraces Area	321.30	29.85
Total Area	2910.56	270.40

**DISCLAIMER:**

1. Proposed changes shall be implemented in compliance with the relevant authority requirements.
2. All materials, dimensions and drawings are approximate. Information subject to change without notice.
3. The Developer reserves the right to make revisions to the floor plans, finishes & amenities mentioned above.

*The Residences*  
JUMEIRAH LAKES TOWERS

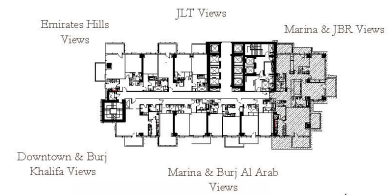
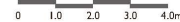

**Residence 2702**  
**MONOGRAM**

*The Residences*  
JUMEIRAH LAKES TOWERS

Floor 27

- 3 Bedrooms
- 3 Baths
- 1 Powder Room



SALEABLE AREA	SQFT	SQM
Suite Area	1756.24	163.16
Balconies/Terraces Area	92.46	8.59
Total Area	1848.70	171.75

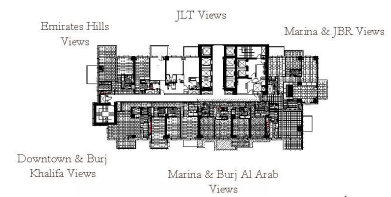

- DISCLAIMER:**
1. Proposed changes shall be implemented in compliance with the relevant authority requirements.
  2. All materials, dimensions and drawings are approximate. Information subject to change without notice.
  3. The Developer reserves the right to make revisions to the floor plans, finishes & amenities mentioned above.

**Residence 2703**  
**MONOGRAM**

*The Residences*  
 JUMEIRAH LAKES TOWERS

Floor 27

- 3 Bedrooms
- 3 Baths
- 1 Powder Room

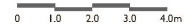
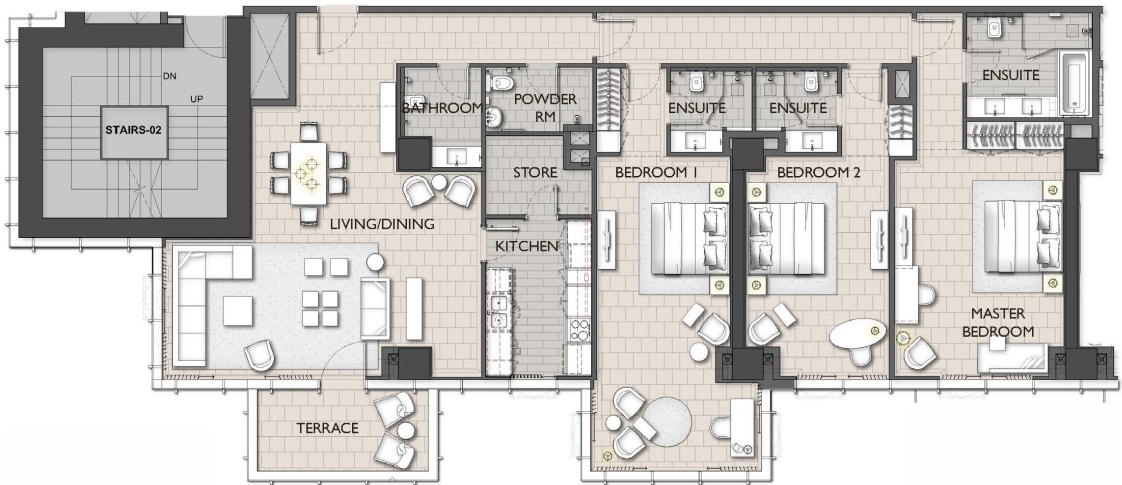

SALEABLE AREA	SQFT	SQM
Suite Area	2438.35	226.53
Balconies/Terraces Area	111.08	10.32
Total Area	2549.43	236.85

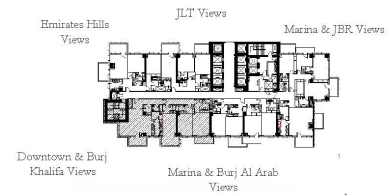

- DISCLAIMER:**
1. Proposed changes shall be implemented in compliance with the relevant authority requirements.
  2. All materials, dimensions and drawings are approximate. Information subject to change without notice.
  3. The Developer reserves the right to make revisions to the floor plans, finishes & amenities mentioned above.

**Residence 2704**  
**MONOGRAM**

*The Residences*  
JUMEIRAH LAKES TOWERS

Floor 27

- 2 Bedrooms
- 2 Baths
- 1 Powder Room



SALEABLE AREA	SQFT	SQM
Suite Area	1373.58	127.61
Balconies/Terraces Area	127.98	11.89
Total Area	1501.56	139.50

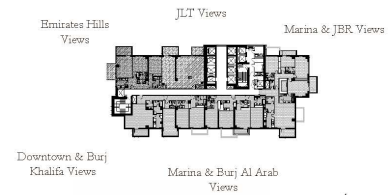

**DISCLAIMER:**

1. Proposed changes shall be implemented in compliance with the relevant authority requirements.
2. All materials, dimensions and drawings are approximate. Information subject to change without notice.
3. The Developer reserves the right to make revisions to the floor plans, finishes & amenities mentioned above.



**Residence 2705**  
**MONOGRAM**

*The Residences*  
JUMEIRAH LAKES TOWERS

Floor 27

- 2 Bedrooms
- 2 Baths
- 1 Powder Room



SALEABLE AREA	SQFT	SQM
Suite Area	1280.04	118.92
Balconies/Terraces Area	126.05	11.71
Total Area	1406.09	130.63

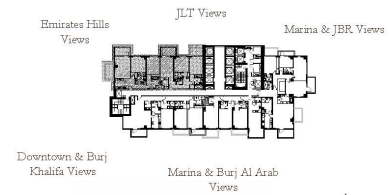

- DISCLAIMER:**
1. Proposed changes shall be implemented in compliance with the relevant authority requirements.
  2. All materials, dimensions and drawings are approximate. Information subject to change without notice.
  3. The Developer reserves the right to make revisions to the floor plans, finishes & amenities mentioned above.

# Residence 2801 MONOGRAM

Floor 28

- 3 Bedrooms
- 3 Baths
- 1 Powder Room
- 1 Family Lounge

SALEABLE AREA	SQFT	SQM
Suite Area	2710.89	251.85
Balconies/Terraces Area	97.41	9.05
Total Area	2808.30	260.90

- DISCLAIMER:**
1. Proposed changes shall be implemented in compliance with the relevant authority requirements.
  2. All materials, dimensions and drawings are approximate. Information subject to change without notice.
  3. The Developer reserves the right to make revisions to the floor plans, finishes & amenities mentioned above.

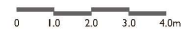
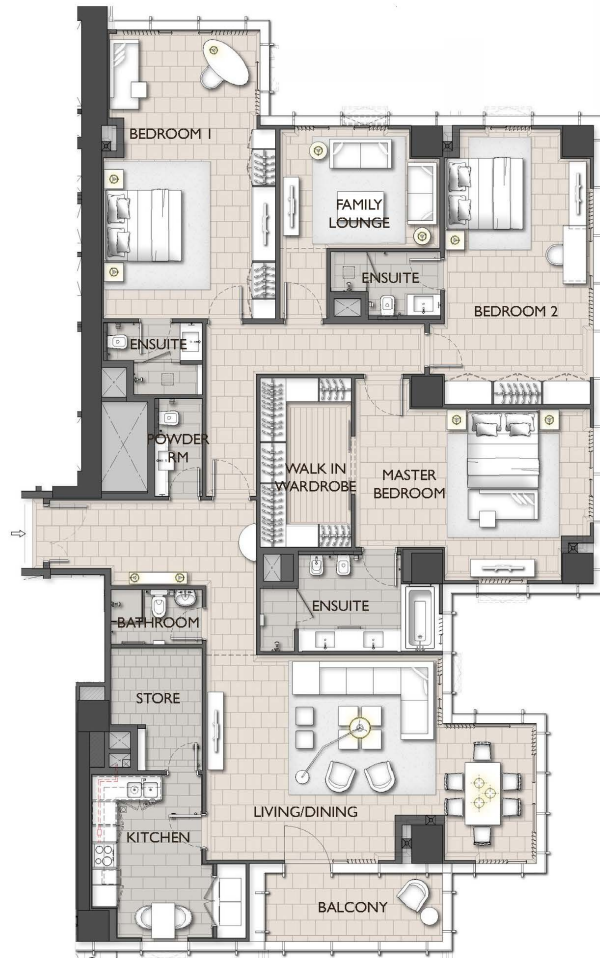

*The Residences*  
JUMEIRAH LAKES TOWERS

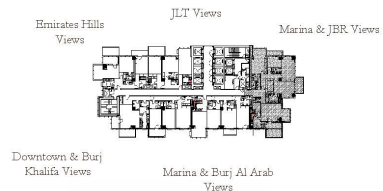

**Residence 2802**  
**MONOGRAM**

*The Residences*  
JUMEIRAH LAKES TOWERS

Floor 28

- 3 Bedrooms
- 3 Baths
- 1 Powder Room



SALEABLE AREA	SQFT	SQM
Suite Area	1896.92	176.23
Balconies/Terraces Area	92.46	8.59
Total Area	1989.38	184.82

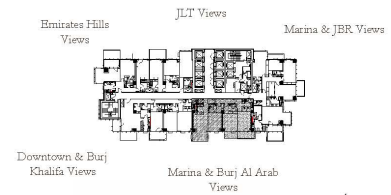

**DISCLAIMER:**

1. Proposed changes shall be implemented in compliance with the relevant authority requirements.
2. All materials, dimensions and drawings are approximate. Information subject to change without notice.
3. The Developer reserves the right to make revisions to the floor plans, finishes & amenities mentioned above.

**Residence 2803**  
**MONOGRAM**

*The Residences*  
 JUMEIRAH LAKES TOWERS

Floor 28

- 3 Bedrooms
- 3 Baths
- 1 Powder Room



SALEABLE AREA	SQFT	SQM
Suite Area	2208.43	205.17
Balconies/Terraces Area	199.46	18.53
Total Area	2407.89	223.7

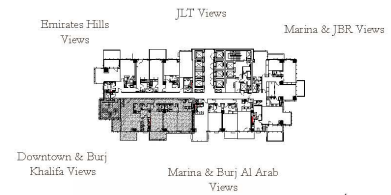

**DISCLAIMER:**

1. Proposed changes shall be implemented in compliance with the relevant authority requirements.
2. All materials, dimensions and drawings are approximate. Information subject to change without notice.
3. The Developer reserves the right to make revisions to the floor plans, finishes & amenities mentioned above.

**Residence 2804**  
**MONOGRAM**

*The Residences*  
JUMEIRAH LAKES TOWERS

Floor 28

- 2 Bedrooms
- 2 Baths
- 1 Powder Room



SALEABLE AREA	SQFT	SQM
Suite Area	1377.13	127.94
Balconies/Terraces Area	197.63	18.36
Total Area	146.30	1574.76

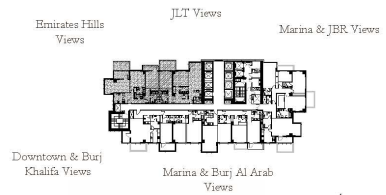

**DISCLAIMER:**

1. Proposed changes shall be implemented in compliance with the relevant authority requirements.
2. All materials, dimensions and drawings are approximate. Information subject to change without notice.
3. The Developer reserves the right to make revisions to the floor plans, finishes & amenities mentioned above.

**Residence 2805**  
**MONOGRAM**

Floor 28

- 2 Bedrooms
- 2 Baths
- 1 Powder Room

*The Residences*  
 JUMEIRAH LAKES TOWERS



SALEABLE AREA	SQFT	SQM
Total Suite Area	1393.50	129.46

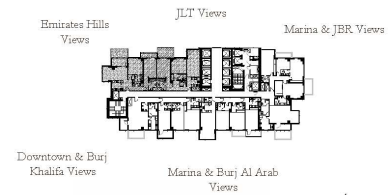

- DISCLAIMER:**
1. Proposed changes shall be implemented in compliance with the relevant authority requirements.
  2. All materials, dimensions and drawings are approximate. Information subject to change without notice.
  3. The Developer reserves the right to make revisions to the floor plans, finishes & amenities mentioned above.

**Residence 2901**  
**MONOGRAM**

Floor 29

- 4 Bedrooms
- 4 Baths
- 1 Powder Room
- 1 Family Lounge



*The Residences*  
JUMEIRAH LAKES TOWERS

SALEABLE AREA	SQFT	SQM
Suite Area	2858.36	265.55
Balconies/Terraces Area	190.84	17.73
Total Area	3049.20	283.28

**DISCLAIMER:**

1. Proposed changes shall be implemented in compliance with the relevant authority requirements.
2. All materials, dimensions and drawings are approximate. Information subject to change without notice.
3. The Developer reserves the right to make revisions to the floor plans, finishes & amenities mentioned above.

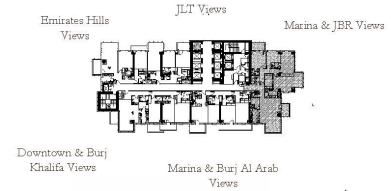
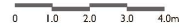

**Residence 2902**  
**MONOGRAM**

*The Residences*  
JUMEIRAH LAKES TOWERS

Floor 2

- 3 Bedrooms
- 3 Baths
- 1 Powder Room



SALEABLE AREA	SQFT	SQM
Suite Area	1757.96	163.32
Balconies/Terraces Area	218.51	20.30
Total Area	1976.47	183.62

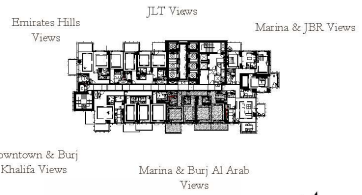

- DISCLAIMER:**
1. Proposed changes shall be implemented in compliance with the relevant authority requirements.
  2. All materials, dimensions and drawings are approximate. Information subject to change without notice.
  3. The Developer reserves the right to make revisions to the floor plans, finishes & amenities mentioned above.



**Residence 2903**  
**MONOGRAM**

*The Residences*  
 JUMEIRAH LAKES TOWERS

Floor 29

- 3 Bedrooms
- 3 Baths
- 1 Powder Room

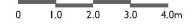

SALEABLE AREA	SQFT	SQM
Suite Area	2332.43	216.69
Balconies/Terraces Area	92.46	8.59
Total Area	2424.89	225.28

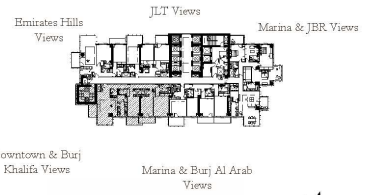

- DISCLAIMER:**
1. Proposed changes shall be implemented in compliance with the relevant authority requirements.
  2. All materials, dimensions and drawings are approximate. Information subject to change without notice.
  3. The Developer reserves the right to make revisions to the floor plans, finishes & amenities mentioned above.

# Residence 3001 MONOGRAM

Floor 30

- 3 Bedrooms
- 3 Baths
- 1 Powder Room
- 1 Family Lounge



*The Residences*  
JUMEIRAH LAKES TOWERS

SALEABLE AREA	SQFT	SQM
Suite Area	2620.15	243.42
Balconies/Terraces Area	321.30	29.85
Total Area	2941.45	273.27

**DISCLAIMER:**

1. Proposed changes shall be implemented in compliance with the relevant authority requirements.
2. All materials, dimensions and drawings are approximate. Information subject to change without notice.
3. The Developer reserves the right to make revisions to the floor plans, finishes & amenities mentioned above.

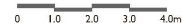
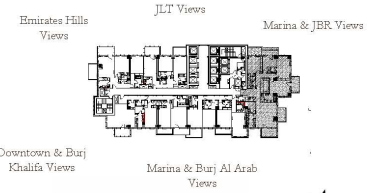

**Residence 3002**  
**MONOGRAM**

*The Residences*  
 JUMEIRAH LAKES TOWERS

Floor 30

- 3 Bedrooms
- 3 Baths
- 1 Powder Room



SALEABLE AREA	SQFT	SQM
Total Suite Area	1863.13	173.09

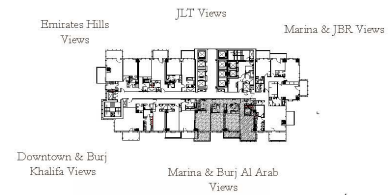

- DISCLAIMER:**
1. Proposed changes shall be implemented in compliance with the relevant authority requirements.
  2. All materials, dimensions and drawings are approximate. Information subject to change without notice.
  3. The Developer reserves the right to make revisions to the floor plans, finishes & amenities mentioned above.

**Residence 3003**  
**MONOGRAM**

*The Residences*  
JUMEIRAH LAKES TOWERS

Floor 30

- 3 Bedrooms
- 3 Baths
- 1 Powder Room



SALEABLE AREA	SQFT	SQM
Suite Area	2314.56	215.03
Balconies/Terraces Area	203.55	18.91
Total Area	2518.11	233.94

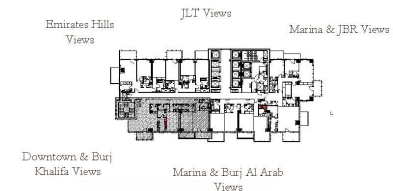

- DISCLAIMER:**
1. Proposed changes shall be implemented in compliance with the relevant authority requirements.
  2. All materials, dimensions and drawings are approximate. Information subject to change without notice.
  3. The Developer reserves the right to make revisions to the floor plans, finishes & amenities mentioned above.

# Residence 3004 MONOGRAM

The Residences  
JUMEIRAH LAKES TOWERS

Floor 30

- 2 Bedrooms
- 2 Baths
- 1 Powder Room



SALEABLE AREA	SQFT	SQM
Suite Area	1373.58	127.61
Balconies/Terraces Area	127.98	11.89
Total Area	1501.56	139.50

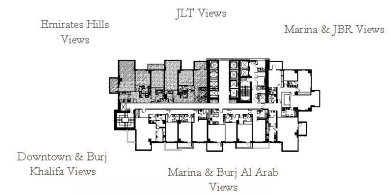

- DISCLAIMER:**
1. Proposed changes shall be implemented in compliance with the relevant authority requirements.
  2. All materials, dimensions and drawings are approximate. Information subject to change without notice.
  3. The Developer reserves the right to make revisions to the floor plans, finishes & amenities mentioned above.

**Residence 3005**  
**MONOGRAM**

*The Residences*  
 JUMEIRAH LAKES TOWERS

Floor 30

- 2 Bedrooms
- 2 Baths
- 1 Powder Room



SALEABLE AREA	SQFT	SQM
Suite Area	1279.94	118.91
Balconies/Terraces Area	126.05	11.71
Total Area	1405.99	130.62

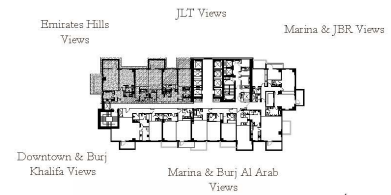

- DISCLAIMER:**
1. Proposed changes shall be implemented in compliance with the relevant authority requirements.
  2. All materials, dimensions and drawings are approximate. Information subject to change without notice.
  3. The Developer reserves the right to make revisions to the floor plans, finishes & amenities mentioned above.





**Residence 3101**  
**AUTOGRAPH**

Floor 31

- 4 Bedrooms
- 4 Baths
- 1 Powder Room
- 1 Family Lounge

SALEABLE AREA	SQFT	SQM
Suite Area	4188.88	389.16
Balconies/Terraces Area	223.35	20.75
Total Area	4412.23	409.91

*The Residences*  
JUMEIRAH LAKES TOWERS

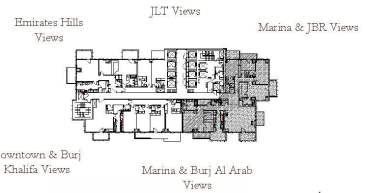

**DISCLAIMER:**

1. Proposed changes shall be implemented in compliance with the relevant authority requirements.
2. All materials, dimensions and drawings are approximate. Information subject to change without notice.
3. The Developer reserves the right to make revisions to the floor plans, finishes & amenities mentioned above.

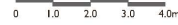



**Residence 3102**  
**AUTOGRAPH**

*The Residences*  
 JUMEIRAH LAKES TOWERS

Floor 31

- 3 Bedrooms
- 3 Baths
- 1 Powder Room
- 1 Family Lounge



SALEABLE AREA	SQFT	SQM
Suite Area	2672.68	248.30
Balconies/Terraces Area	180.94	16.81
Total Area	2853.62	265.11

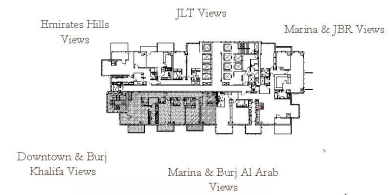

**DISCLAIMER:**

1. Proposed changes shall be implemented in compliance with the relevant authority requirements.
2. All materials, dimensions and drawings are approximate. Information subject to change without notice.
3. The Developer reserves the right to make revisions to the floor plans, finishes & amenities mentioned above.

**Residence 3103**  
**AUTOGRAPH**

*The Residences*  
 JUMEIRAH LAKES TOWERS

Floor 31

- 3 Bedrooms
- 3 Baths
- 1 Powder Room
- 1 Family Lounge

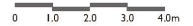

SALEABLE AREA	SQFT	SQM
Suite Area	2817.02	261.71
Balconies/Terraces Area	197.63	18.36
Total Area	3014.65	280.07

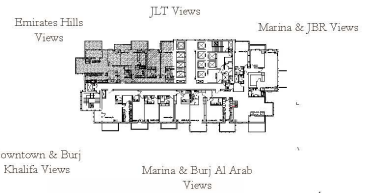

**DISCLAIMER:**

1. Proposed changes shall be implemented in compliance with the relevant authority requirements.
2. All materials, dimensions and drawings are approximate. Information subject to change without notice.
3. The Developer reserves the right to make revisions to the floor plans, finishes & amenities mentioned above.

**Residence 3201**  
**AUTOGRAPH**

*The Residences*  
JUMEIRAH LAKES TOWERS

Floor 32

- 5 Bedrooms
- 5 Baths
- 1 Powder Room
- 1 Family Lounge

SALEABLE AREA	SQFT	SQM
Suite Area	4201.26	390.31
Balconies/Terraces Area	316.89	29.44
Total Area	4518.15	419.75

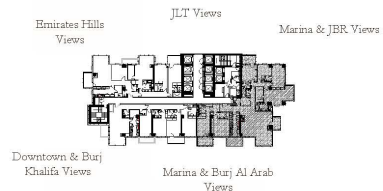

- DISCLAIMER:**
1. Proposed changes shall be implemented in compliance with the relevant authority requirements.
  2. All materials, dimensions and drawings are approximate. Information subject to change without notice.
  3. The Developer reserves the right to make revisions to the floor plans, finishes & amenities mentioned above.

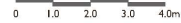

**Residence 3202**  
**AUTOGRAPH**

*The Residences*  
 JUMEIRAH LAKES TOWERS

Floor 32

- 3 Bedrooms
- 3 Baths
- 1 Powder Room
- 1 Family Lounge



SALEABLE AREA	SQFT	SQM
Suite Area	2794.10	259.58
Balconies/Terraces Area	92.46	8.59
Total Area	2886.56	268.17

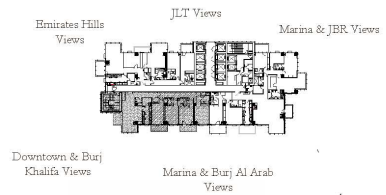

**DISCLAIMER:**

1. Proposed changes shall be implemented in compliance with the relevant authority requirements.
2. All materials, dimensions and drawings are approximate. Information subject to change without notice.
3. The Developer reserves the right to make revisions to the floor plans, finishes & amenities mentioned above.

**Residence 3203**  
**AUTOGRAPH**

*The Residences*  
 JUMEIRAH LAKES TOWERS

Floor 32

- 3 Bedrooms
- 3 Baths
- 1 Powder Room
- 1 Family Lounge

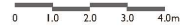

SALEABLE AREA	SQFT	SQM
Suite Area	2980.96	276.94
Balconies/Terraces Area	209.47	19.46
Total Area	3190.43	296.40

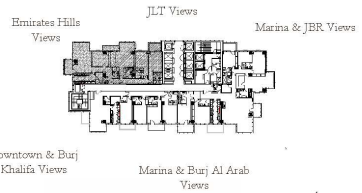

- DISCLAIMER:**
1. Proposed changes shall be implemented in compliance with the relevant authority requirements.
  2. All materials, dimensions and drawings are approximate. Information subject to change without notice.
  3. The Developer reserves the right to make revisions to the floor plans, finishes & amenities mentioned above.



**Residence 3301**  
**AUTOGRAPH**

*The Residences*  
JUMEIRAH LAKES TOWERS

Floor 33

- 4 Bedrooms
- 4 Baths
- 1 Powder Room
- 1 Family Lounge

SALEABLE AREA	SQFT	SQM
Suite Area	3928.40	364.96
Balconies/Terraces Area	413.76	38.44
Total Area	4342.16	403.40

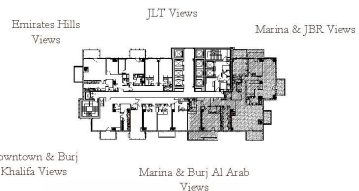

- DISCLAIMER:**
1. Proposed changes shall be implemented in compliance with the relevant authority requirements.
  2. All materials, dimensions and drawings are approximate. Information subject to change without notice.
  3. The Developer reserves the right to make revisions to the floor plans, finishes & amenities mentioned above.



**Residence 3302**  
**AUTOGRAPH**

*The Residences*  
 JUMEIRAH LAKES TOWERS

Floor 33

- 3 Bedrooms
- 3 Baths
- 1 Powder Room
- 1 Family Lounge



SALEABLE AREA	SQFT	SQM
Suite Area	2904.53	269.84
Balconies/Terraces Area	111.08	10.32
Total Area	3015.61	280.16

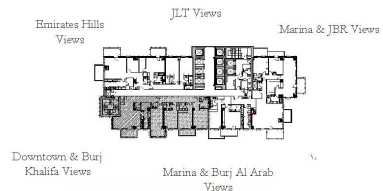

**DISCLAIMER:**

1. Proposed changes shall be implemented in compliance with the relevant authority requirements.
2. All materials, dimensions and drawings are approximate. Information subject to change without notice.
3. The Developer reserves the right to make revisions to the floor plans, finishes & amenities mentioned above.



**Residence 3303**  
**AUTOGRAPH**

*The Residences*  
 JUMEIRAH LAKES TOWERS

Floor 33

- 3 Bedrooms
- 3 Baths
- 1 Powder Room
- 1 Family Lounge

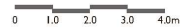

SALEABLE AREA	SQFT	SQM
Suite Area	2699.91	250.83
Balconies/Terraces Area	254.03	23.60
Total Area	2953.94	274.43

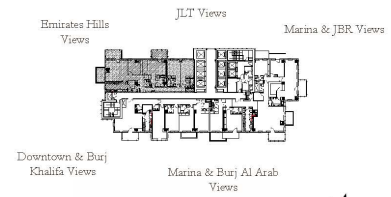

- DISCLAIMER:**
1. Proposed changes shall be implemented in compliance with the relevant authority requirements.
  2. All materials, dimensions and drawings are approximate. Information subject to change without notice.
  3. The Developer reserves the right to make revisions to the floor plans, finishes & amenities mentioned above.



**Residence 3401**  
**AUTOGRAPH**

*The Residences*  
JUMEIRAH LAKES TOWERS

Floor 34

- 4 Bedrooms
- 4 Baths
- 1 Powder Room
- 1 Family Lounge

SALEABLE AREA	SQFT	SQM
Suite Area	4038.40	375.18
Balconies/Terraces Area	189.77	17.63
Total Area	4228.17	392.81

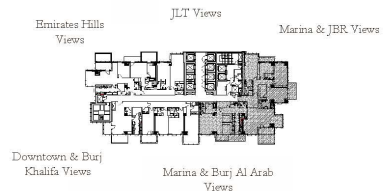
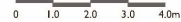
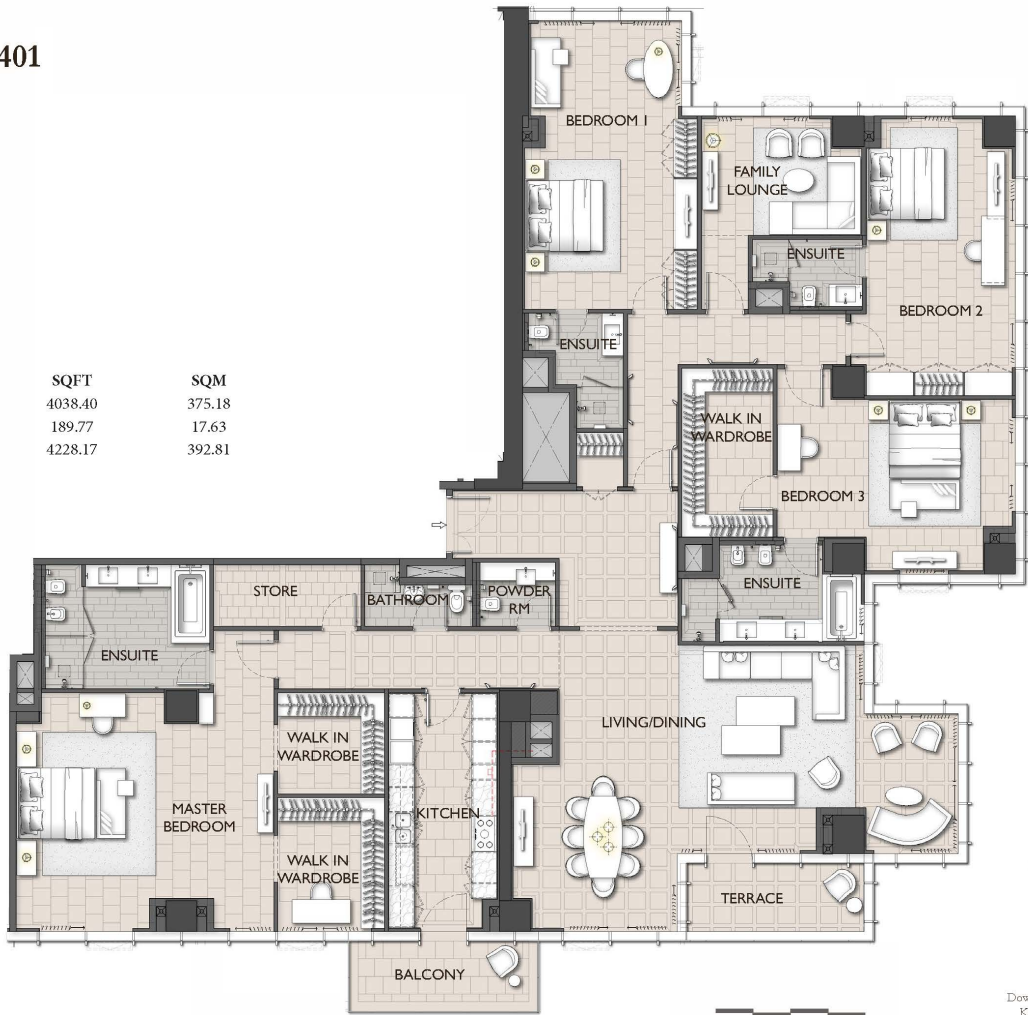

- DISCLAIMER:**
1. Proposed changes shall be implemented in compliance with the relevant authority requirements.
  2. All materials, dimensions and drawings are approximate. Information subject to change without notice.
  3. The Developer reserves the right to make revisions to the floor plans, finishes & amenities mentioned above.

**Residence 3402**  
**AUTOGRAPH**

*The Residences*  
 JUMEIRAH LAKES TOWERS

Floor 34

- 3 Bedrooms
- 3 Baths
- 1 Powder Room
- 1 Family Lounge



SALEABLE AREA	SQFT	SQM
Suite Area	2812.07	261.25
Balconies/Terraces Area	199.56	18.54
Total Area	3011.63	279.79

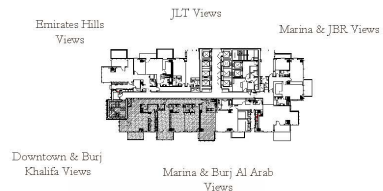

- DISCLAIMER:**
1. Proposed changes shall be implemented in compliance with the relevant authority requirements.
  2. All materials, dimensions and drawings are approximate. Information subject to change without notice.
  3. The Developer reserves the right to make revisions to the floor plans, finishes & amenities mentioned above.



**Residence 3403**  
**AUTOGRAPH**

*The Residences*  
 JUMEIRAH LAKES TOWERS

Floor 34

- 3 Bedrooms
- 3 Baths
- 1 Powder Room
- 1 Family Lounge

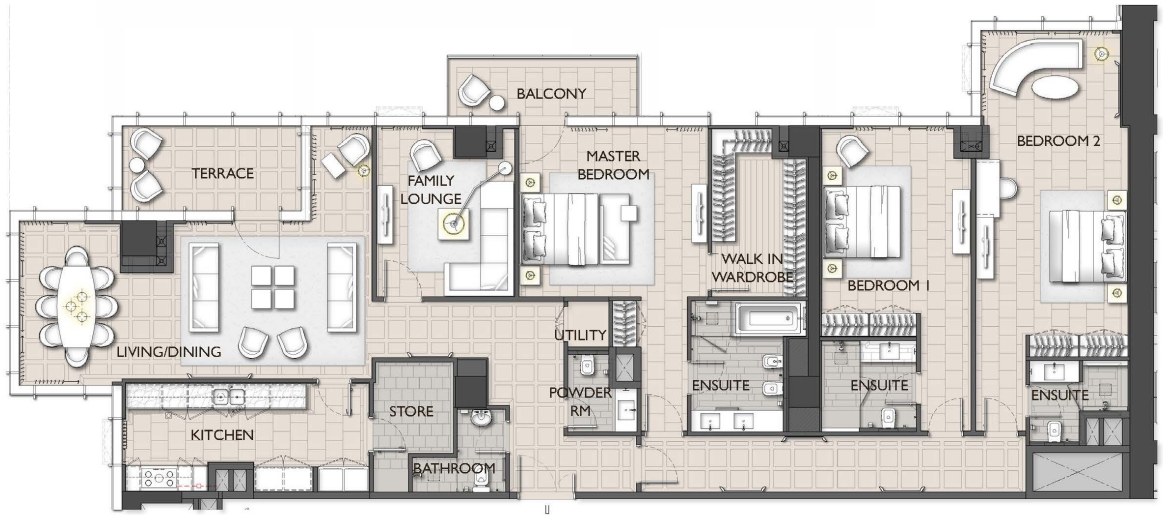

SALEABLE AREA	SQFT	SQM
Suite Area	2817.02	261.71
Balconies/Terraces Area	197.63	18.36
Total Area	3014.65	280.07

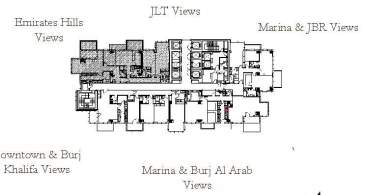

- DISCLAIMER:**
1. Proposed changes shall be implemented in compliance with the relevant authority requirements.
  2. All materials, dimensions and drawings are approximate. Information subject to change without notice.
  3. The Developer reserves the right to make revisions to the floor plans, finishes & amenities mentioned above.

**Residence 3501**  
**AUTOGRAPH**

*The Residences*  
JUMEIRAH LAKES TOWERS

Floor 35

- 5 Bedrooms
- 5 Baths
- 1 Powder Room
- 1 Family Lounge

SALEABLE AREA	SQFT	SQM
Suite Area	4145.07	385.09
Balconies/Terraces Area	283.31	26.32
Total Area	4428.38	411.41

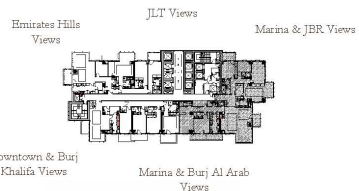

- DISCLAIMER:**
1. Proposed changes shall be implemented in compliance with the relevant authority requirements.
  2. All materials, dimensions and drawings are approximate. Information subject to change without notice.
  3. The Developer reserves the right to make revisions to the floor plans, finishes & amenities mentioned above.

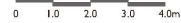

**Residence 3502**  
**AUTOGRAPH**

*The Residences*  
 JUMEIRAH LAKES TOWERS

Floor 35

- 3 Bedrooms
- 3 Baths
- 1 Powder Room
- 1 Family Lounge



SALEABLE AREA	SQFT	SQM
Suite Area	2837.90	263.65
Balconies/Terraces Area	218.51	20.30
Total Area	3056.41	283.95

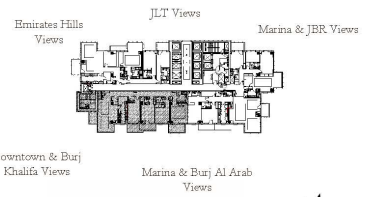

- DISCLAIMER:**
1. Proposed changes shall be implemented in compliance with the relevant authority requirements.
  2. All materials, dimensions and drawings are approximate. Information subject to change without notice.
  3. The Developer reserves the right to make revisions to the floor plans, finishes & amenities mentioned above.



**Residence 3503**  
**AUTOGRAPH**

*The Residences*  
 JUMEIRAH LAKES TOWERS

Floor 35

- 3 Bedrooms
- 3 Baths
- 1 Powder Room
- 1 Family Lounge

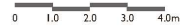

SALEABLE AREA	SQFT	SQM
Suite Area	2980.96	276.64
Balconies/Terraces Area	209.47	19.46
Total Area	3190.43	296.40

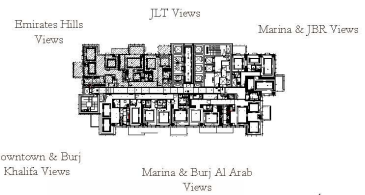

**DISCLAIMER:**

1. Proposed changes shall be implemented in compliance with the relevant authority requirements.
2. All materials, dimensions and drawings are approximate. Information subject to change without notice.
3. The Developer reserves the right to make revisions to the floor plans, finishes & amenities mentioned above.

# Residence 3601 AUTOGRAPH

The Residences  
JUMEIRAH LAKES TOWERS

## Floor 36

- 4 Bedrooms
- 4 Baths
- 1 Powder Room
- 1 Family Lounge

SALEABLE AREA	SQFT	SQM
Suite Area	3994.16	371.07
Balconies/Terraces Area	321.30	29.85
Total Area	4315.46	400.92

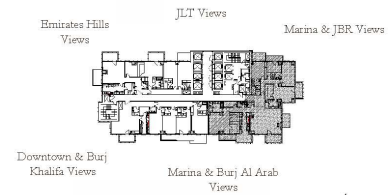

**DISCLAIMER:**

- Proposed changes shall be implemented in compliance with the relevant authority requirements.
- All materials, dimensions and drawings are approximate. Information subject to change without notice.
- The Developer reserves the right to make revisions to the floor plans, finishes & amenities mentioned above.

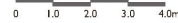

**Residence 3602**  
**AUTOGRAPH**

*The Residences*  
 JUMEIRAH LAKES TOWERS

**Floor 36**

- 3 Bedrooms
- 3 Baths
- 1 Powder Room
- 1 Family Lounge



SALEABLE AREA	SQFT	SQM
Suite Area	2822.40	262.21
Balconies/Terraces Area	203.55	18.91
Total Area	3025.95	281.12

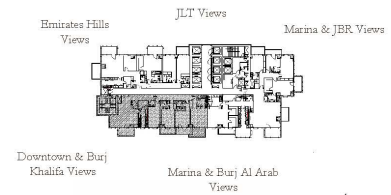

**DISCLAIMER:**

1. Proposed changes shall be implemented in compliance with the relevant authority requirements.
2. All materials, dimensions and drawings are approximate. Information subject to change without notice.
3. The Developer reserves the right to make revisions to the floor plans, finishes & amenities mentioned above.



**Residence 3603**  
**AUTOGRAPH**

*The Residences*  
 JUMEIRAH LAKES TOWERS

Floor 36

- 3 Bedrooms
- 3 Baths
- 1 Powder Room
- 1 Family Lounge

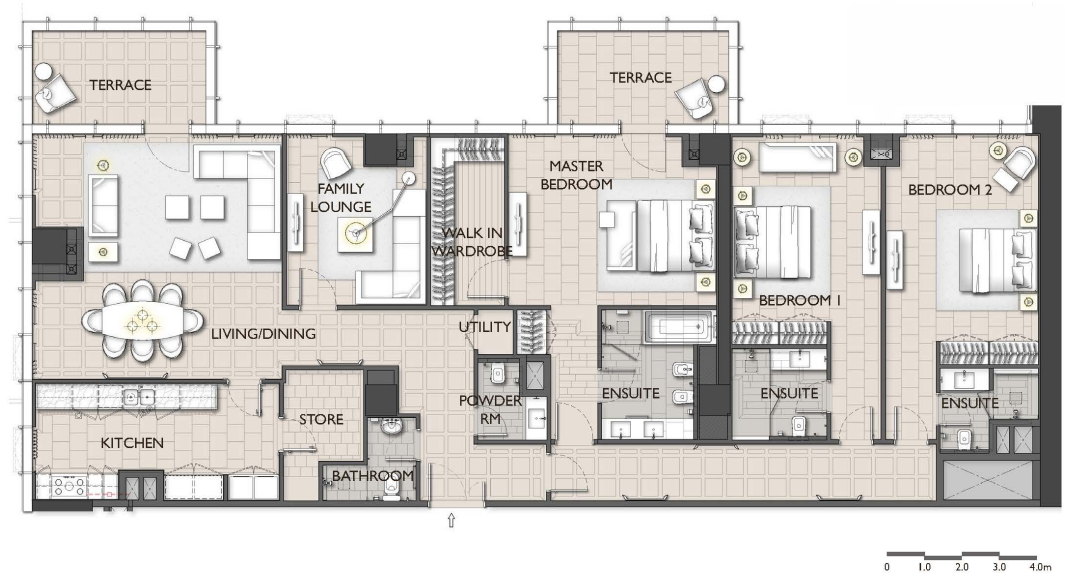

SALEABLE AREA	SQFT	SQM
Suite Area	2699.91	250.83
Balconies/Terraces Area	254.03	23.60
Total Area	2953.94	274.43

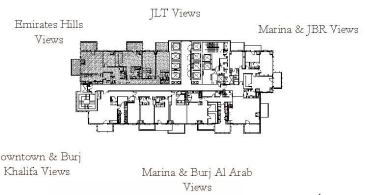

- DISCLAIMER:**
1. Proposed changes shall be implemented in compliance with the relevant authority requirements.
  2. All materials, dimensions and drawings are approximate. Information subject to change without notice.
  3. The Developer reserves the right to make revisions to the floor plans, finishes & amenities mentioned above.

**Residence 3802**  
**AUTOGRAPH**

*The Residences*  
 JUMEIRAH LAKES TOWERS

**Floor 38**

- 3 Bedrooms
- 3 Baths
- 1 Powder Room
- 1 Family Lounge

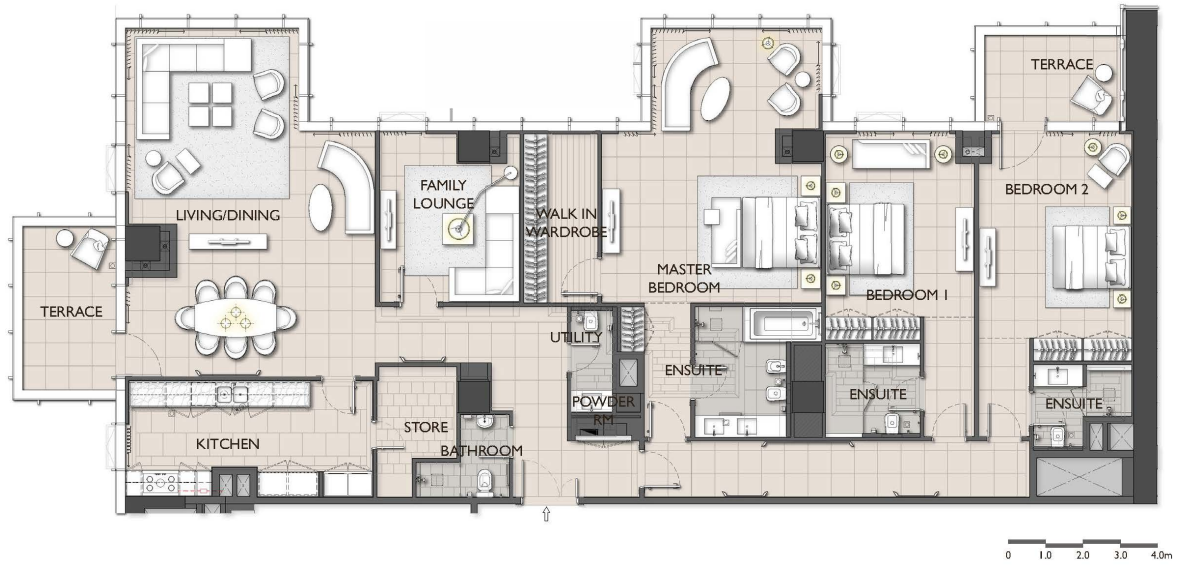

SALEABLE AREA	SQFT	SQM
Suite Area	2980.85	276.93
Balconies/Terraces Area	209.47	19.46
Total Area	3190.32	296.39

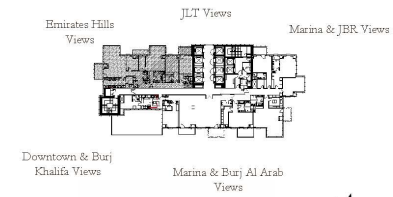

- DISCLAIMER:**
1. Proposed changes shall be implemented in compliance with the relevant authority requirements.
  2. All materials, dimensions and drawings are approximate. Information subject to change without notice.
  3. The Developer reserves the right to make revisions to the floor plans, finishes & amenities mentioned above.



**Residence 4002**  
**AUTOGRAPH**

*The Residences*  
 JUMEIRAH LAKES TOWERS

Floor 40

- 3 Bedrooms
- 3 Baths
- 1 Powder Room
- 1 Family Lounge



SALEABLE AREA	SQFT	SQM
Suite Area	2817.13	261.72
Balconies/Terraces Area	197.52	18.35
Total Area	3014.65	280.07

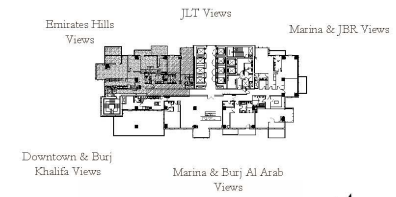

- DISCLAIMER:**
1. Proposed changes shall be implemented in compliance with the relevant authority requirements.
  2. All materials, dimensions and drawings are approximate. Information subject to change without notice.
  3. The Developer reserves the right to make revisions to the floor plans, finishes & amenities mentioned above.

**Residence 4202**  
**AUTOGRAPH**

*The Residences*  
 JUMEIRAH LAKES TOWERS

Floor 42

- 3 Bedrooms
- 3 Baths
- 1 Powder Room
- 1 Family Lounge



SALEABLE AREA	SQFT	SQM
Suite Area	2699.91	250.83
Balconies/Terraces Area	254.03	23.60
Total Area	2953.94	274.43

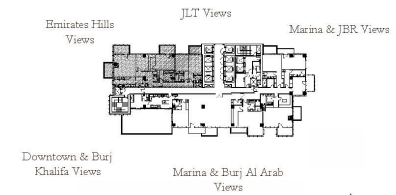

**DISCLAIMER:**

1. Proposed changes shall be implemented in compliance with the relevant authority requirements.
2. All materials, dimensions and drawings are approximate. Information subject to change without notice.
3. The Developer reserves the right to make revisions to the floor plans, finishes & amenities mentioned above.



**Residence 3801**  
SIGNATURE

*The Residences*  
JUMEIRAH LAKES TOWERS

Floor 38

- 5 Bedrooms
- 35 Baths
- 1 Powder Room
- 1 Family Lounge
- 1 Maid's room



SALEABLE AREA	SQFT	SQM
Suite Area	6192.59	575.31
Balconies/Terraces Area	409.35	38.03
Total Area	6601.94	613.34

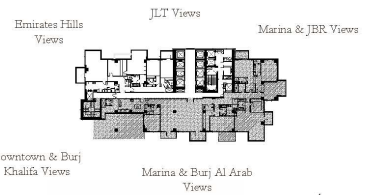

**DISCLAIMER:**

1. Proposed changes shall be implemented in compliance with the relevant authority requirements.
2. All materials, dimensions and drawings are approximate. Information subject to change without notice.
3. The Developer reserves the right to make revisions to the floor plans, finishes & amenities mentioned above.



**Residence 4001**  
SIGNATURE

*The Residences*  
JUMEIRAH LAKES TOWERS

Floor 40

- 5 Bedrooms
- 35 Baths
- 1 Powder Room
- 1 Family Lounge
- 1 Maid's room

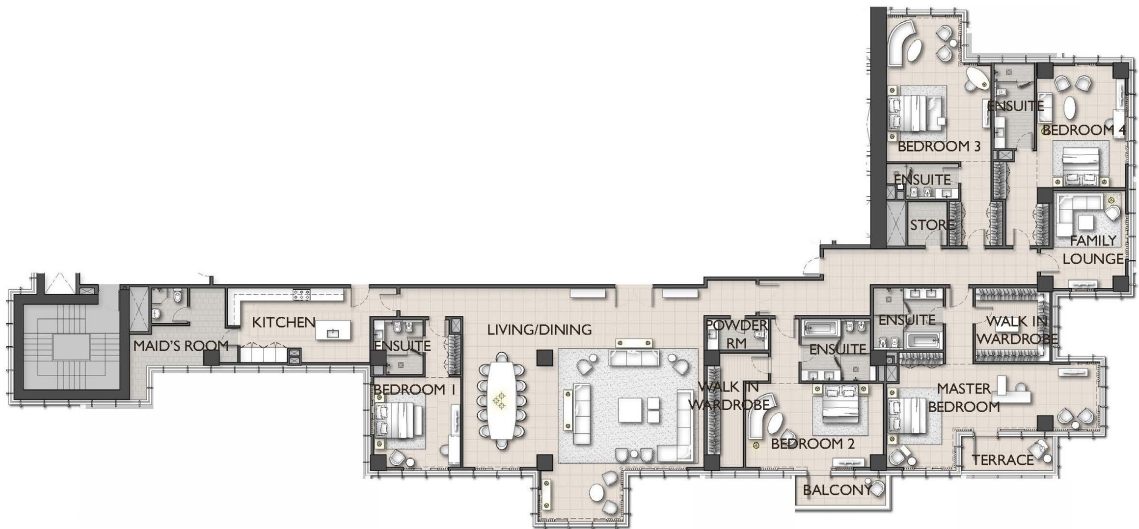

0 1 2 3 4m

SALEABLE AREA	SQFT	SQM
Suite Area	6184.62	574.57
Balconies/Terraces Area	189.88	17.64
Total Area	6374.50	592.21

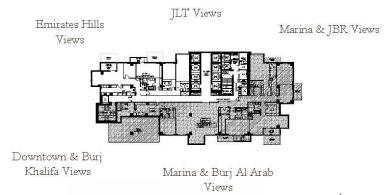

**DISCLAIMER:**

1. Proposed changes shall be implemented in compliance with the relevant authority requirements.
2. All materials, dimensions and drawings are approximate. Information subject to change without notice.
3. The Developer reserves the right to make revisions to the floor plans, finishes & amenities mentioned above.



**Residence 4201**  
SIGNATURE

*The Residences*  
JUMEIRAH LAKES TOWERS

Floor 42

- 5 Bedrooms
- 35 Baths
- 1 Powder Room
- 1 Family Lounge
- 1 Maid's room



SALEABLE AREA	SQFT	SQM
Suite Area	6063.85	563.35
Balconies/Terraces Area	412.58	38.33
Total Area	6476.43	601.68

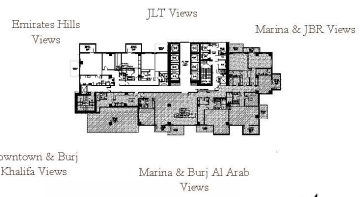

- DISCLAIMER:**
1. Proposed changes shall be implemented in compliance with the relevant authority requirements.
  2. All materials, dimensions and drawings are approximate. Information subject to change without notice.
  3. The Developer reserves the right to make revisions to the floor plans, finishes & amenities mentioned above.